

SECTION 4 ELECTRICAL SYSTEM

Group 1 Component Location	4-1
Group 2 Electrical Circuit	4-3
Group 3 Electrical Component Specification	4-38
Group 4 Connectors	4-46

SECTION 4 ELECTRICAL SYSTEM

GROUP 1 COMPONENT LOCATION

1. LOCATION 1

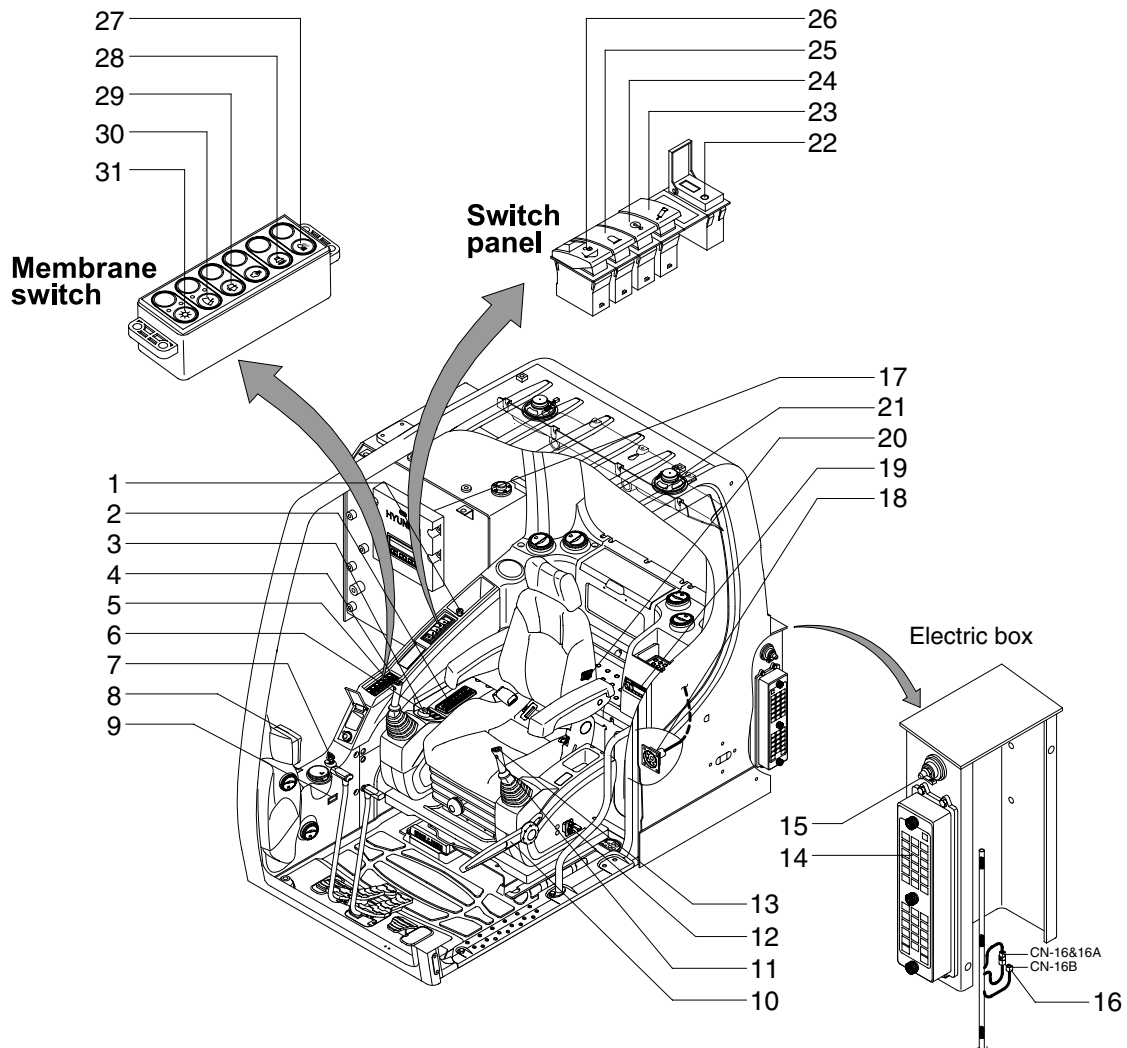

4809S4EL01

- | | | |
|--------------------------------|---------------------------------|------------------------|
| 1 Cigar light | 12 Emergency engine stop switch | 22 USB socket |
| 2 Aircon & heater switch panel | 13 One touch decel switch | 23 Breake switch |
| 3 Accel dial switch | 14 Fuse box | 24 Overload switch |
| 4 Horn switch | 15 Master switch | 25 Beacon switch |
| 5 Breaker operation switch | 16 Emergency engine connector | 26 Quick clamp switch |
| 6 Air compressor switch | 17 MCU | 27 Cab light switch |
| 7 Starting switch | 18 RS232 service socket | 28 Travel alarm switch |
| 8 Cluster | 19 Radio & USB player | 29 Washer switch |
| 9 Service meter | 20 Heated seat switch | 30 Wiper switch |
| 10 Safety lever | 21 Speaker | 31 Main light switch |
| 11 Power max switch | | |

2. LOCATION 2

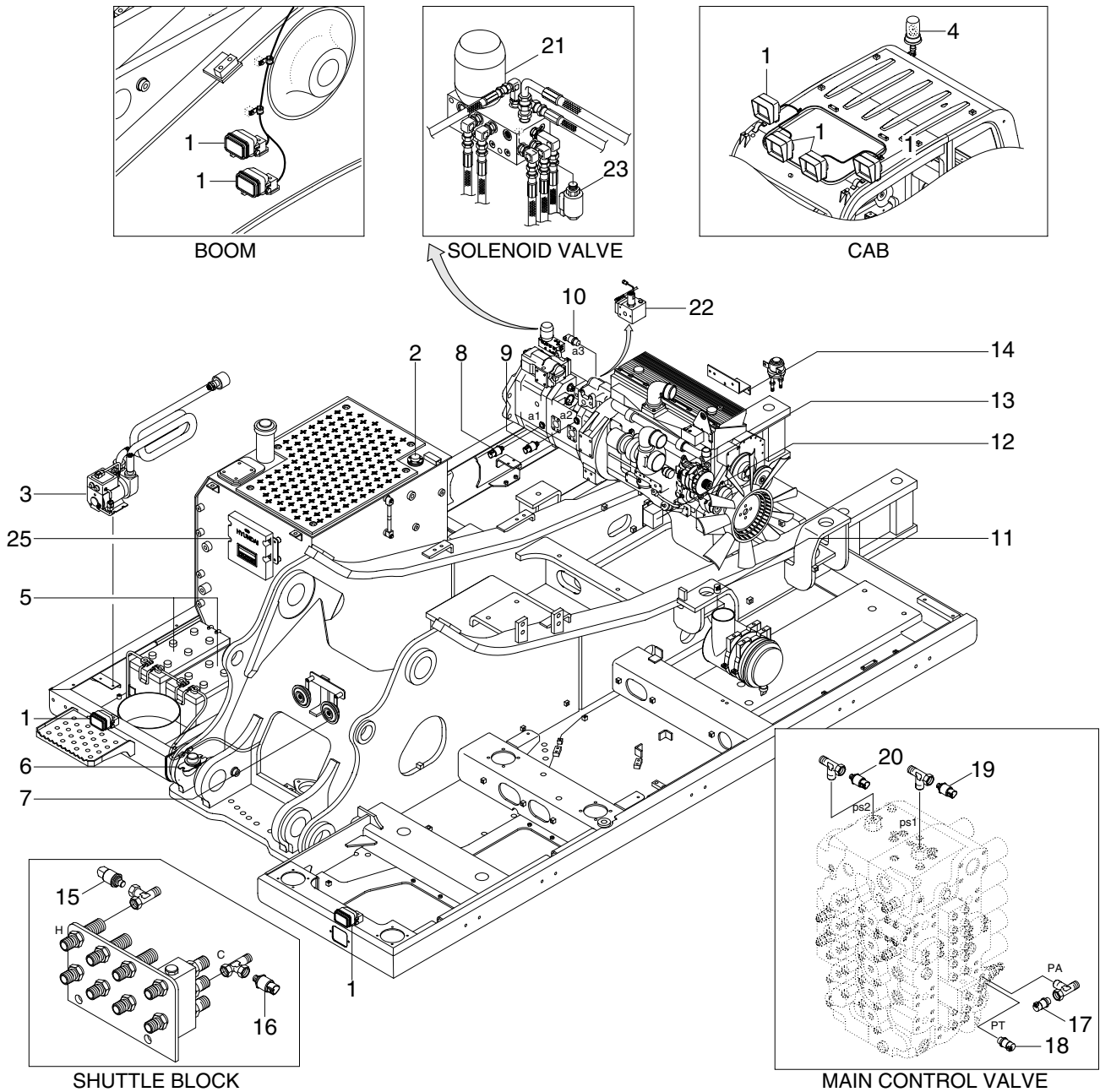

4809S4EL02

- | | | |
|----------------------|----------------------------|-----------------------------|
| 1 Lamp | 9 P2 pressure sensor | 17 Attach pressure sensor |
| 2 Fuel sender | 10 EPPR pressure sensor | 18 Travel pressure sensor |
| 3 Fuel filler pump | 11 Air cleaner switch | 19 P1 nega pressure sensor |
| 4 Beacon lamp | 12 Travel alarm buzzer | 20 P2 nega pressure sensor |
| 5 Battery | 13 Alternator | 21 Solenoid valve |
| 6 Battery relay | 14 Heater relay | 22 Pump EPPR valve |
| 7 Horn | 15 Boom up pressure sensor | 23 Boom priority EPPR valve |
| 8 P1 pressure sensor | 16 Swing pressure sensor | |

※ Cluster type 1 only : 10, 15, 16, 19, 20