

## SECTION 4 ELECTRICAL SYSTEM

Group 1 Component Location .....	4-1
Group 2 Electrical Circuit .....	4-3
Group 3 Electrical Component Specification .....	4-38
Group 4 Connectors .....	4-46

# SECTION 4 ELECTRICAL SYSTEM

## GROUP 1 COMPONENT LOCATION

### 1. LOCATION 1

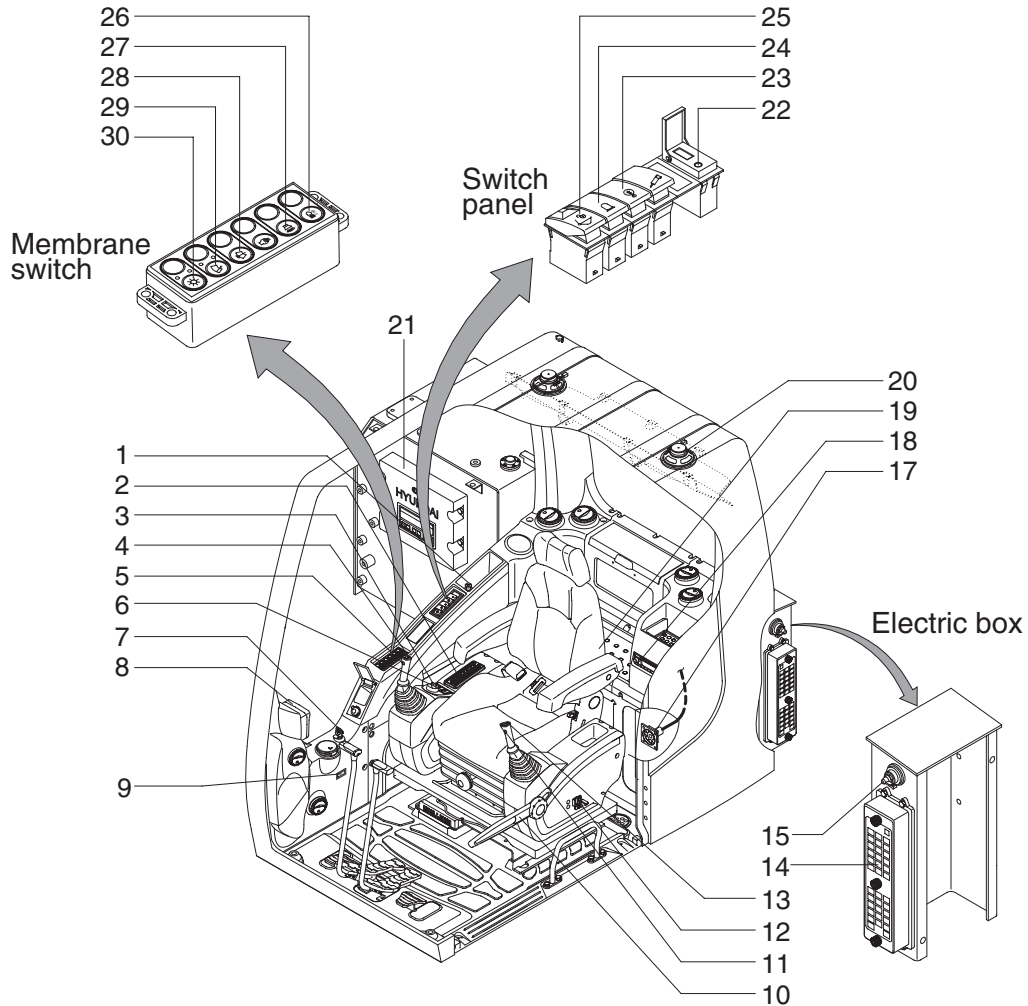

3009SH4EL01

- |                                |                                 |                        |
|--------------------------------|---------------------------------|------------------------|
| 1 Cigar light                  | 11 Power max switch             | 22 USB socket          |
| 2 Aircon & heater switch panel | 12 Emergency engine stop switch | 23 Overload switch     |
| 3 Accel dial switch            | 13 One touch decel switch       | 24 Beacon switch       |
| 4 Horn switch                  | 14 Fuse box                     | 25 Quick clamp switch  |
| 5 Breaker operation switch     | 15 Master switch                | 26 Cab light switch    |
| 6 Air compressor switch        | 17 RS232 service socket         | 27 Travel alarm switch |
| 7 Starting switch              | 18 Radio & USB player           | 28 Washer switch       |
| 8 Cluster                      | 19 Heated seat switch           | 29 Wiper switch        |
| 9 Service meter                | 20 Speaker                      | 30 Main light switch   |
| 10 Safety lever                | 21 MCU                          |                        |

## 2. LOCATION 2

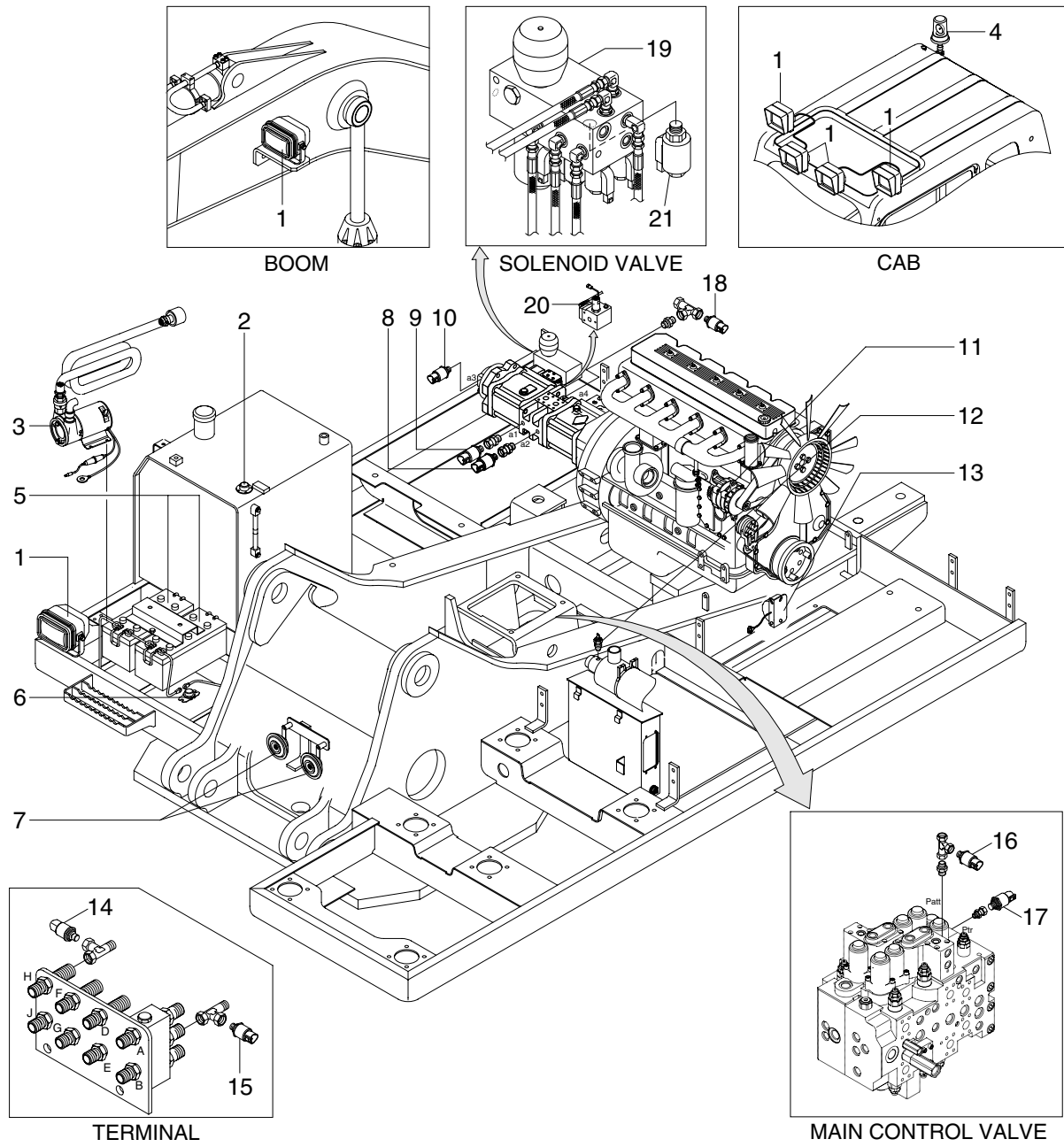

3009S4EL02

- |   |                  |    |                         |    |                          |
|---|------------------|----|-------------------------|----|--------------------------|
| 1 | Lamp             | 8  | P1 pressure sensor      | 15 | Swing pressure sensor    |
| 2 | Fuel sender      | 9  | P2 pressure sensor      | 16 | Attach pressure sensor   |
| 3 | Fuel filler pump | 10 | P3 pressure sensor      | 17 | Travel pressure sensor   |
| 4 | Beacon lamp      | 11 | Alternator              | 18 | EPPR Pressure sensor     |
| 5 | Battery          | 12 | Air cleaner switch      | 19 | Solenoid valve           |
| 6 | Battery relay    | 13 | Travel alarm buzzer     | 20 | Pump EPPR valve          |
| 7 | Horn             | 14 | Boom up pressure sensor | 21 | Boom priority EPPR valve |

※ Cluster type 1 only : 10, 14, 15, 18