

## SECTION 4 ELECTRICAL SYSTEM

Group 1 Component Location .....	4-1
Group 2 Electrical Circuit .....	4-3
Group 3 Electrical Component Specification .....	4-21
Group 4 Connectors .....	4-29

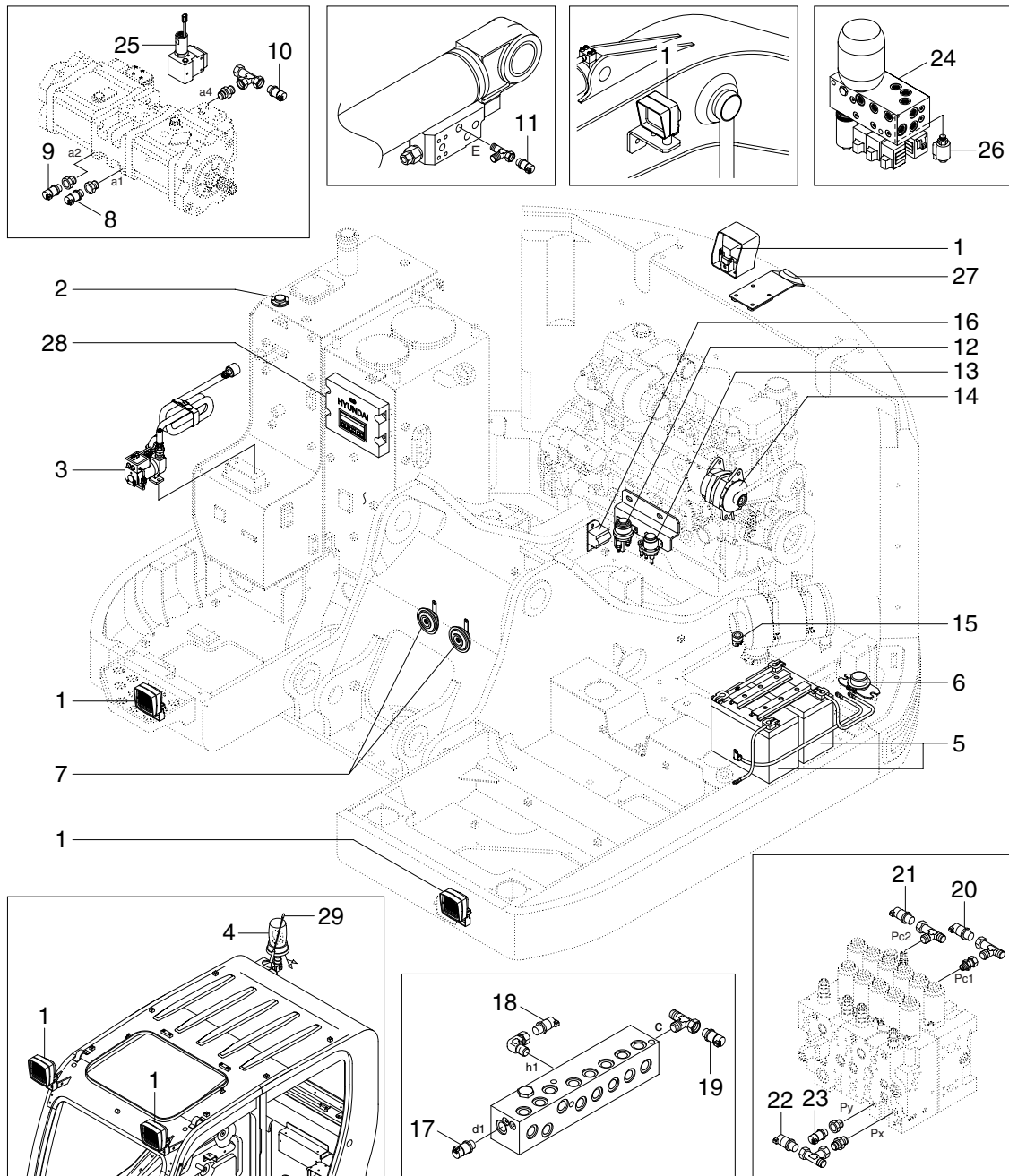

## 2. LOCATION 2



2359A4EL02

- |    |                      |    |                               |    |                             |
|----|----------------------|----|-------------------------------|----|-----------------------------|
| 1  | Lamp                 | 11 | Overload pressure sensor      | 21 | Posi-nega 2 pressure sensor |
| 2  | Fuel sender          | 12 | Start relay                   | 22 | Attach pressure sensor      |
| 3  | Fuel filler pump     | 13 | Heater relay                  | 23 | Travel pressure sensor      |
| 4  | Beacon lamp          | 14 | Alternator                    | 24 | Solenoid valve              |
| 5  | Battery              | 15 | Air cleaner switch            | 25 | Pump EPPR valve             |
| 6  | Battery relay        | 16 | Travel alarm buzzer           | 26 | Boom priority EPPR valve    |
| 7  | Horn                 | 17 | Arm/Bucket in pressure sensor | 27 | Rear camera                 |
| 8  | P1 pressure sensor   | 18 | Boom up pressure sensor       | 28 | Machine control unit        |
| 9  | P2 pressure sensor   | 19 | Swing pressure sensor         | 29 | Satellite antenna           |
| 10 | EPPR pressure sensor | 20 | Posi-nega 1 pressure sensor   |    |                             |