

GROUP 8 TURNING JOINT

1. REMOVAL AND INSTALL

1) REMOVAL

- (1) Lower the work equipment to the ground and stop the engine.
- (2) Operate the control levers and pedals several times to release the remaining pressure in the hydraulic piping.
- (3) Loosen the breather slowly to release the pressure inside the hydraulic tank.
- ▲ Escaping fluid under pressure can penetrate the skin causing serious injury.
- * When pipes and hoses are disconnected, the oil inside the piping will flow out, so catch it in oil pan.
- (4) Disconnect all hoses .
- (5) Sling the turning joint assembly (1) and remove the mounting bolt(2).
 - Weight : 50kg(110lb)
 - Tightening torque : $29.6 \pm 3.2 \text{ kgf} \cdot \text{m}$
($214.1 \pm 23.1 \text{ lbf} \cdot \text{ft}$)
- (6) Remove the turning joint assembly.
- * When removing the turning joint, check that all the hoses have been disconnected.

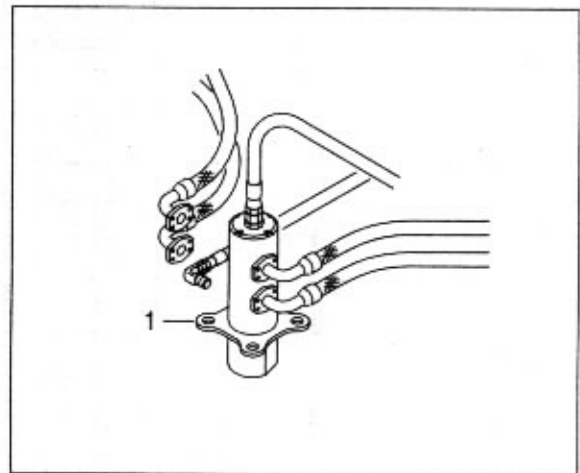

2) INSTALL

- (1) Carry out installation in the reverse order to removal.
- * Take care of turning joint direction.
- * Assemble hoses to their original positions.
- * Confirm the hydraulic oil level and check the hydraulic oil leak or not.

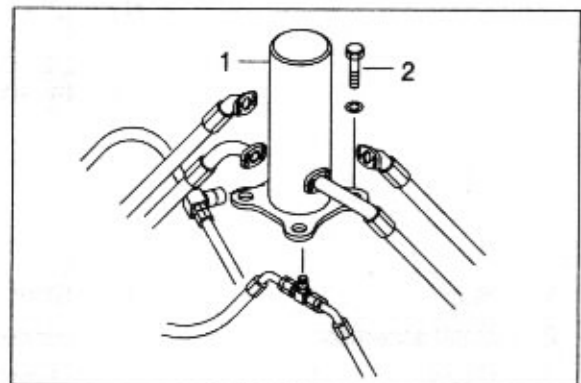

2. DISASSEMBLY AND ASSEMBLY

1) STRUCTURE

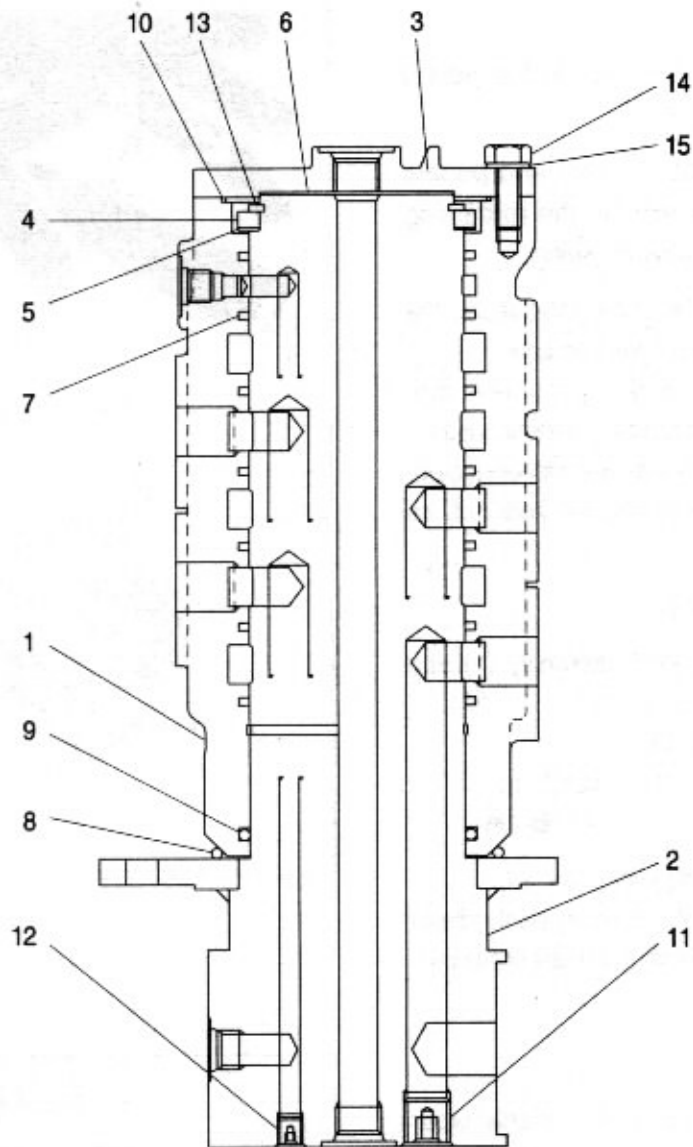

- 1 Hub
- 2 Shaft assembly
- 3 Cover
- 4 Spacer
- 5 Shim

- 6 Shim
- 7 Slipper seal
- 8 O-ring
- 9 O-ring
- 10 O-ring

- 11 PT Plug
- 12 PT Plug
- 13 Plug
- 14 Retainer ring
- 15 Spring washer

2) DISASSEMBLY

※ Before the disassembly, clean the turning joint.

(1) Remove bolts(14), washer(15) and cover(3).

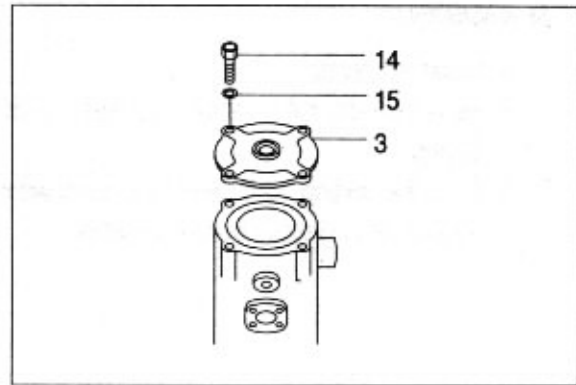

(2) Remove shim(6) and O-ring(10).

(3) Remove retainer ring(13), spacer(4) and shim(5).

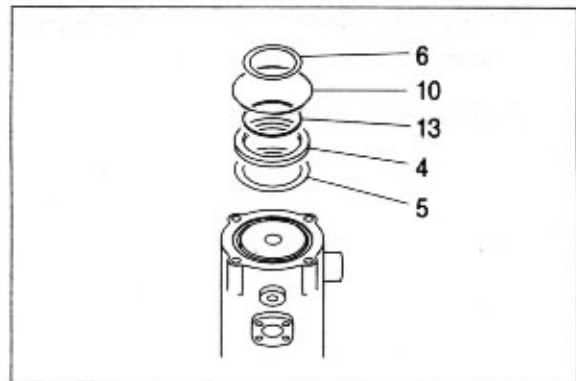

(4) Place body(1) on a V-block and by using a wood buffer at the shaft end, hit out shaft(2) to about 1/2 from the body with a hammer.

※ Take care not to damage the shaft(2) when remove body(1) or rest it sideways.

※ Put a fitting mark on body(1) and shaft(2).

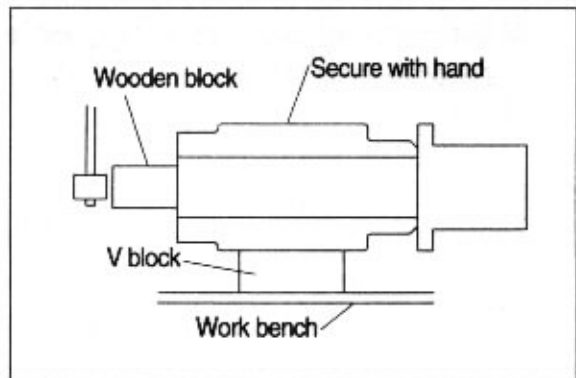

(5) Remove six slipper seals(7) and O-ring(9) from body(1).

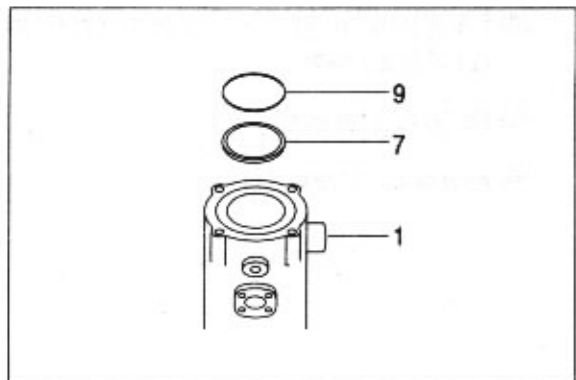

3) ASSEMBLY

- * Clean all parts.
- * As a general rule, replace oil seals and O-ring.
- * Coat the sliding surfaces of all parts with engine oil or grease before installing.

- (1) Fix seven slipper seal(7) and O-ring(9) to body(1).
- (2) Fit O-ring(8) to shaft(2).

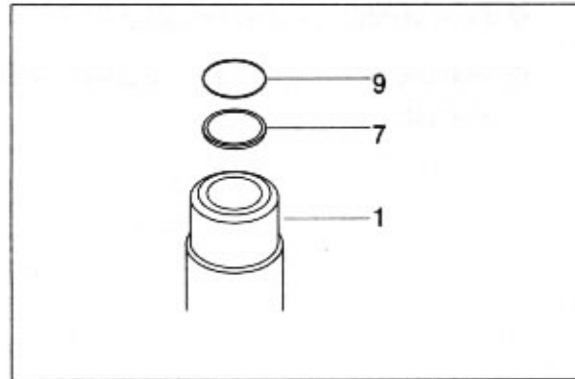

- (3) Set shaft(2) on block, tap body(1) with a plastic hammer to install.

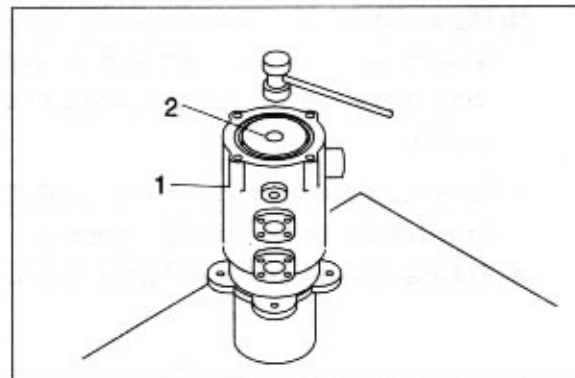

- (4) Fit shim(5), spacer(4) and retainer ring(13) to shaft(2).
- (5) Fit O-ring(10) to body(1).
- (6) Fit shim(6) to shaft(2).

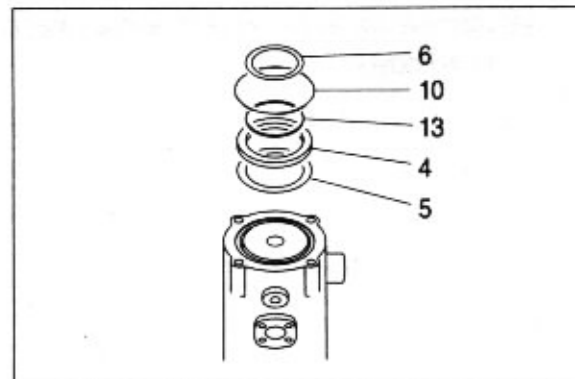

(7) Install cover(3) to body(1) and tighten bolts(14).

• Torque : 10 ~ 12.5 kgf · m

