

GROUP 4 DISASSEMBLY AND ASSEMBLY

1. MAIN PUMP (STEERING PUMP, LOADER PUMP)

1) STRUCTURE

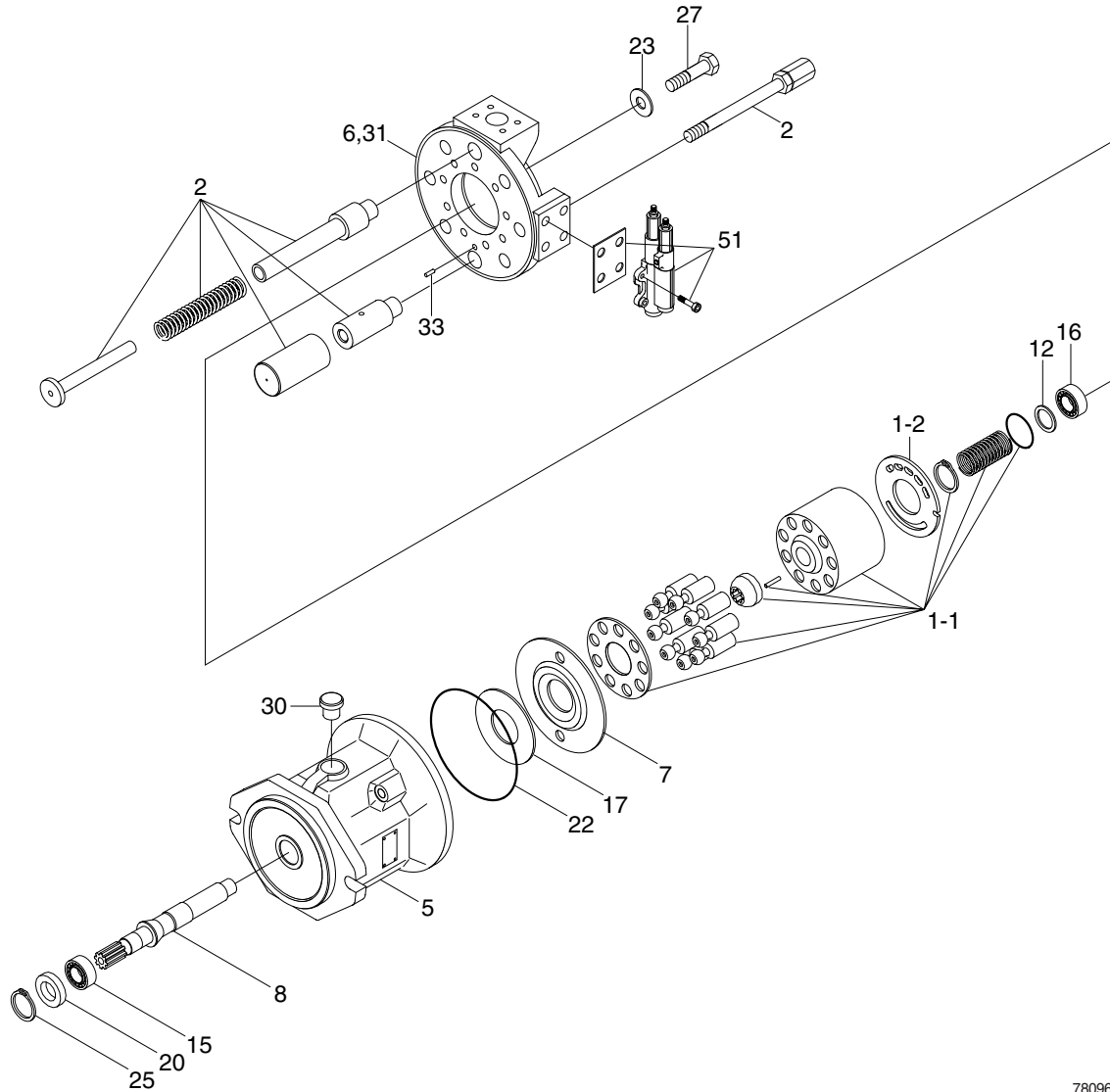

78096WE11

- | | | | | | |
|-----|-------------------------|----|----------------------|----|----------------------|
| 1 | Rotary group | 8 | Drive shaft | 23 | O-ring |
| 1-1 | High speed rotary group | 12 | Adjustment shim | 25 | V-ring |
| 1-2 | Control plate | 15 | Taper roller bearing | 27 | Socket screw |
| 2 | Adjusting piece | 16 | Taper roller bearing | 30 | Locking screw |
| 5 | Pump housing | 17 | Bearing liner | 31 | Double break-off pin |
| 6 | Port plate | 20 | Shaft seal ring | 33 | Cylinder pin |
| 7 | Swash plate | 22 | O-ring | 51 | Control valve |

2) GENERAL REPAIR GUIDELINES

- ※ Observe the following guidelines when carrying out repairs on hydraulic pumps.
- (1) Close off all openings of the hydraulic unit.
- (2) Replace all of the seals.
Use only original spare parts.
- (3) Check all sealing and sliding surfaces for wear.
- ※ Re-work of the sliding surfaces by using, for example abrasive paper, can damage the surface.
- (4) Fill the hydraulic pump with hydraulic oil before commissioning.

3) SEALING THE DRIVE SHAFT

- (1) Protect the drive shaft.
Remove the circlip.
Remove the shaft seal.

1 Circlip 2 Shaft seal

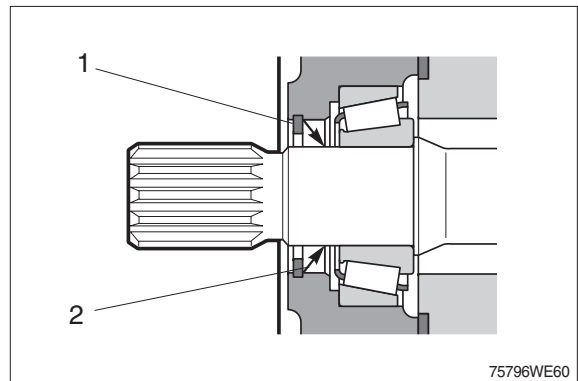

- (2) Change the shaft seal and check its sliding surface (drive shaft) and housing, grease the sealing ring.

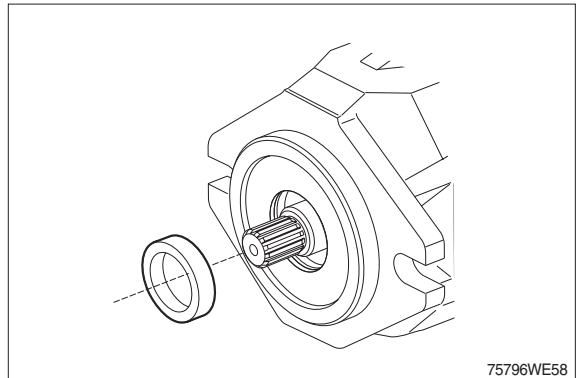

- (3) Assemble the sealing ring, fitting tool holds the correct position of the sealing ring in the pump housing.
Assemble the circlip in the correct position.

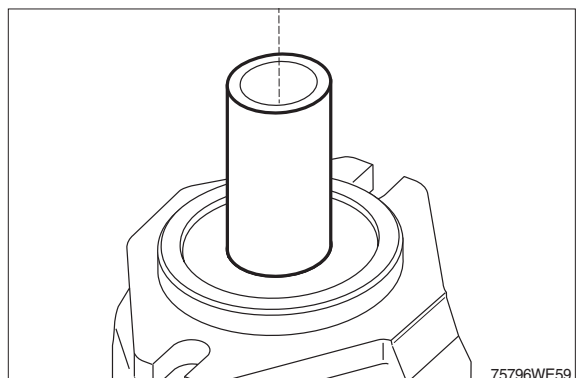

4) SEALING / CLEANING THE CONTROL VALVE

- (1) Disassemble the control valve.
- ※ Measure dimension A and note down.
- Check sealing surface (1).

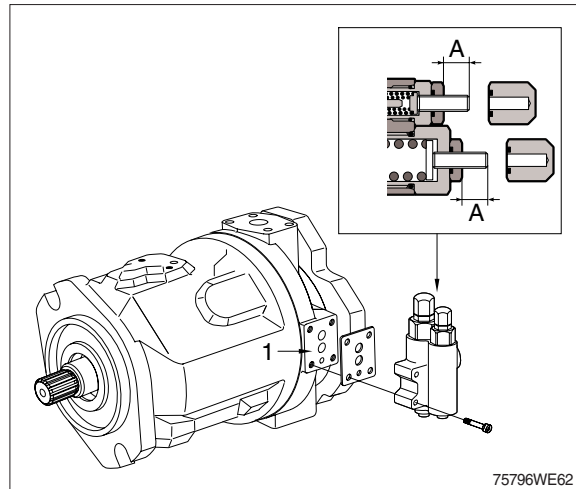

5) DISASSEMBLE THE PUMP

- (1) Remove the control valve.

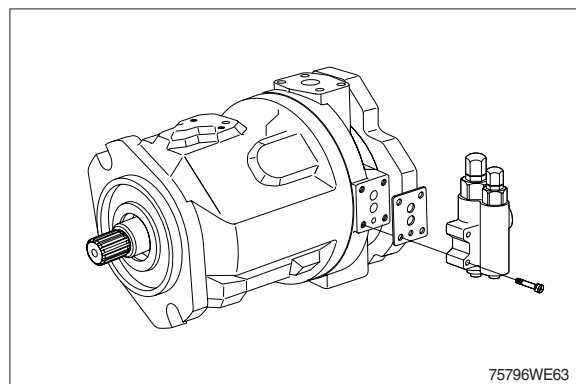

- (2) Mark the location of the connection plate on the housing.

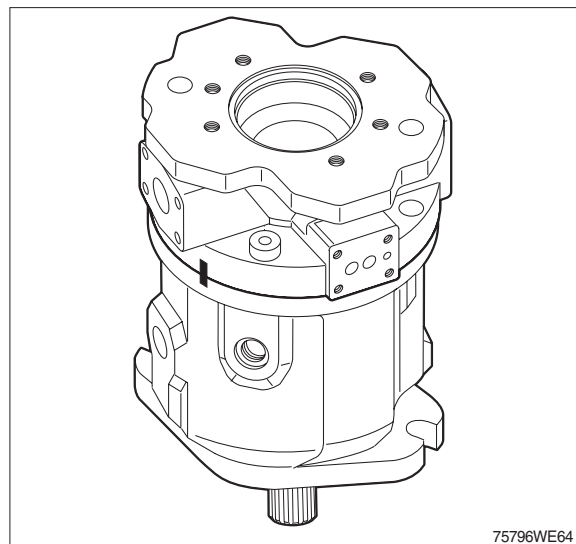

- (3) Remove the connection plate fixing bolts and the connection plate.
※ Distributor plate and adjustment piston can drop down.

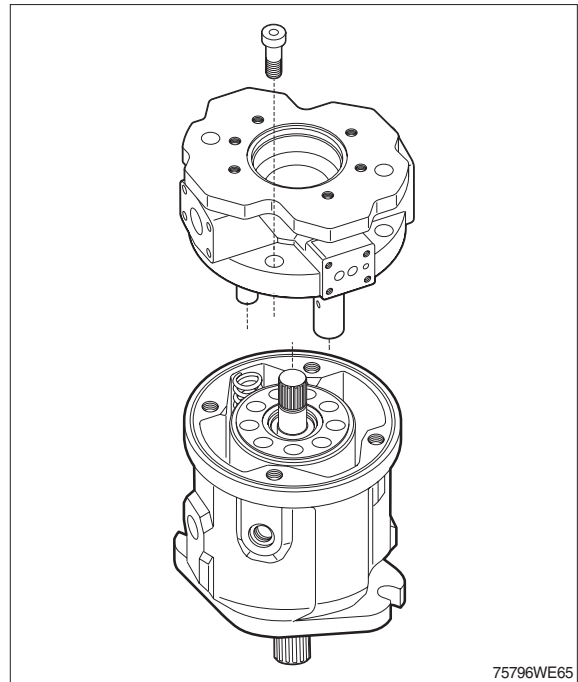

- (4) Remove distributor plate.
Take note of the orientation.
※ Remove bearing with withdrawal tool.
Do not damage the sealing surface.

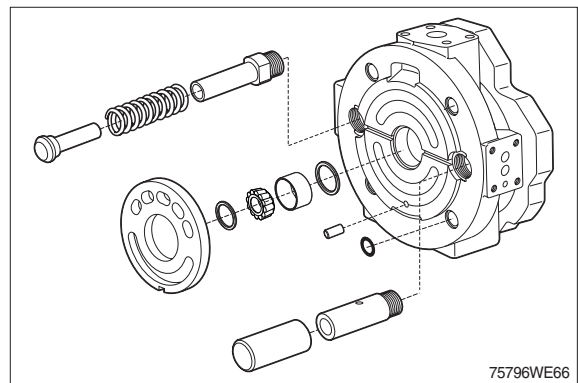

- (5) Remove the rotary group in a horizontal position.

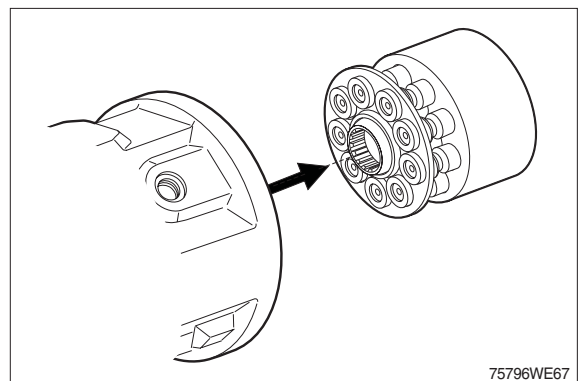

(6) Remove swash plate and bearing shells.

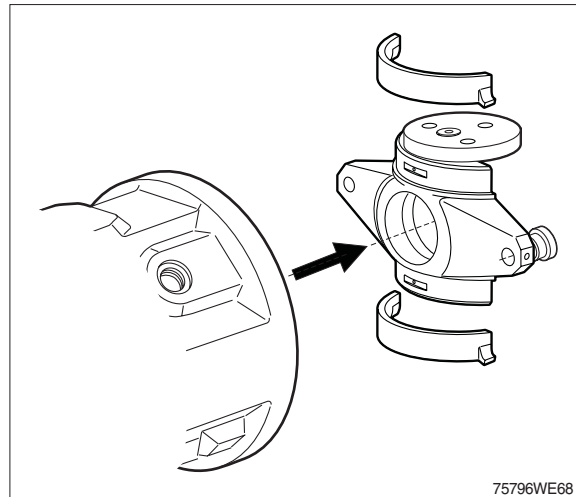

(7) Remove the circlip and the shaft seal.

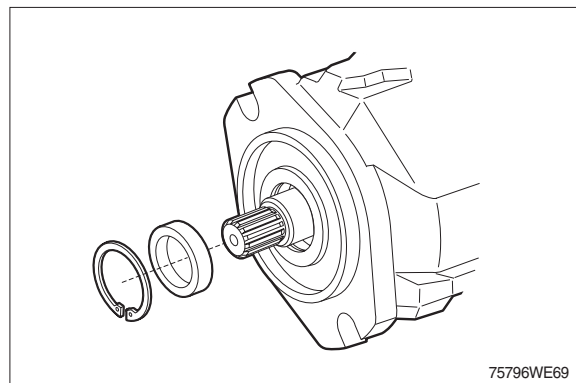

(8) Remove the drive shaft through rear side.

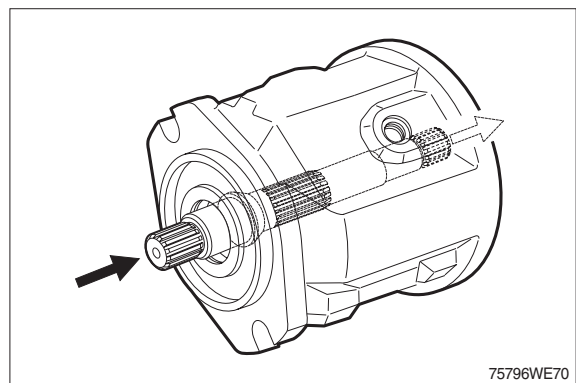

(9) Pre-tension the spring (1) using a suitable device.
Remove circlip (2).
Remove spring (1) and pressure pins (3).

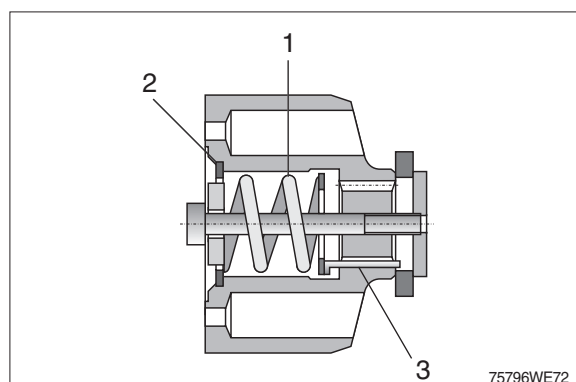

(10) Use bearing puller to remove outer bearing race of front bearing out of housing press seat.

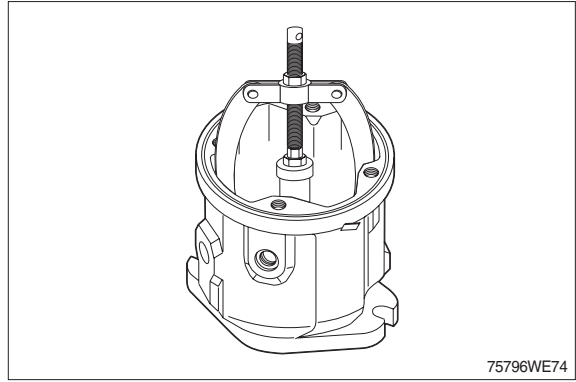

(11) Remove the control plate.

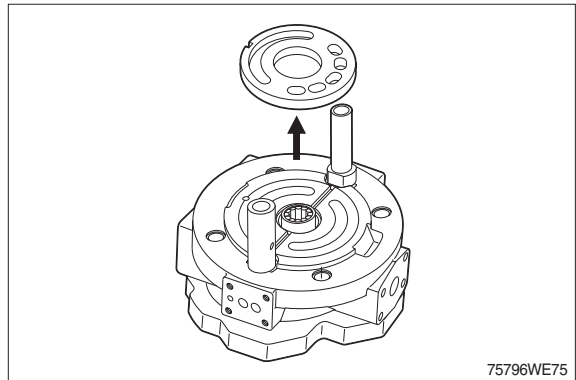

(12) Use bearing puller to remove outer bearing race of rear bearing - press seat.

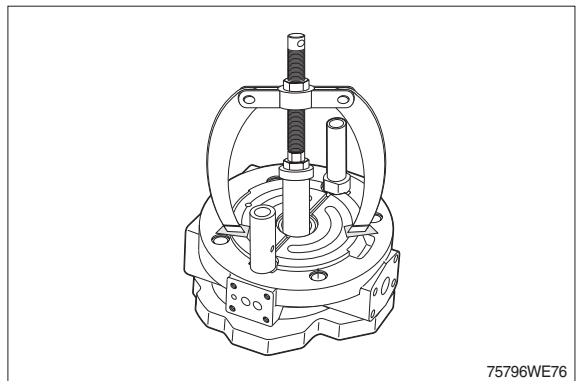

(13) Disassemble the guide of control piston (Mounting position: pilot valve side).

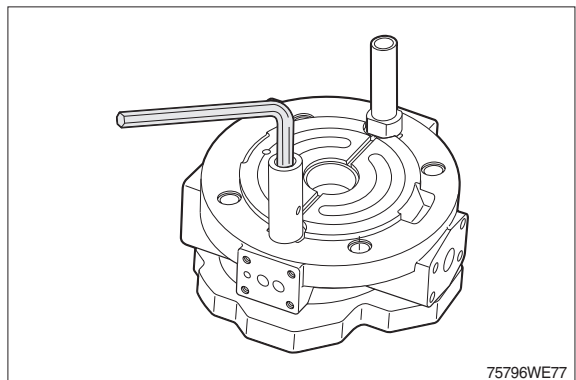

(14) Disassemble the guide of the opposite piston.

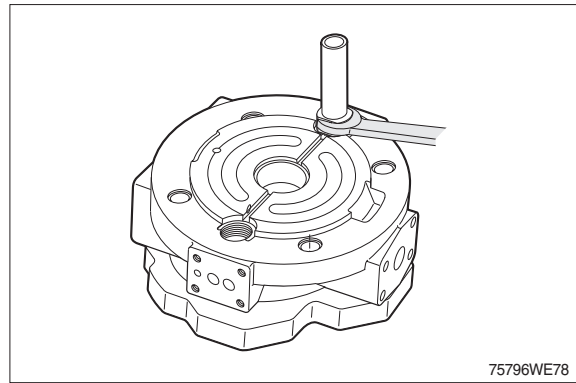

6) INSPECT HINTS

(1) Renew all bearings.

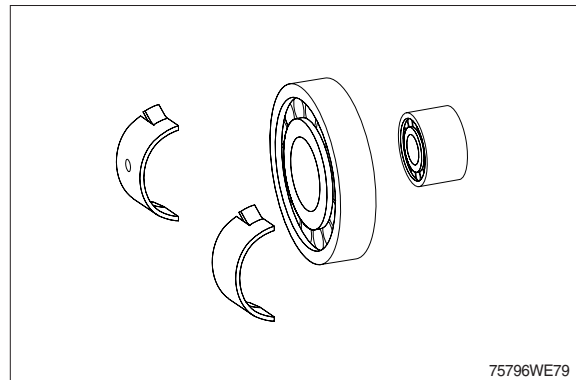

(2) Check :

- 1 Wear on splines, rust
- 2 Drive shaft seal wear grooves
- 3 Bearing seat
- 4 Splines for cylinder drive
- 5 Bearing seat

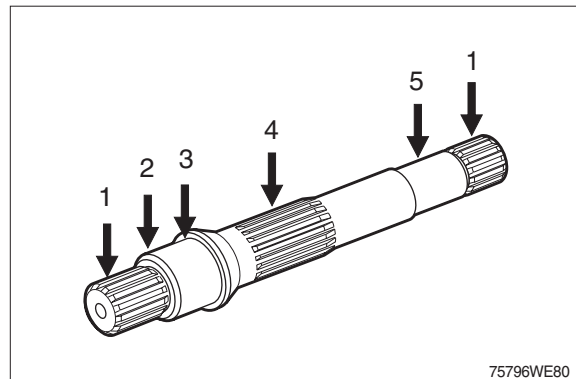

(3) Check :

Sliding surface free of grooves.

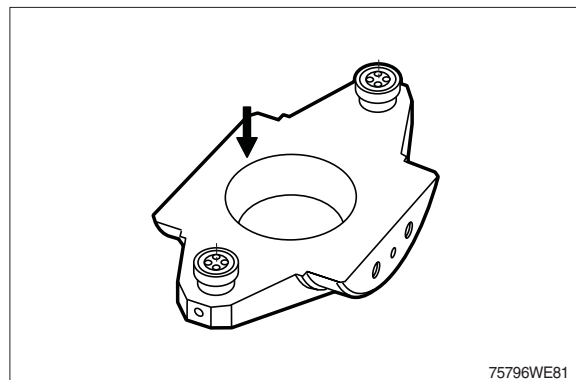

- (4) Check :
Bearing surfaces.

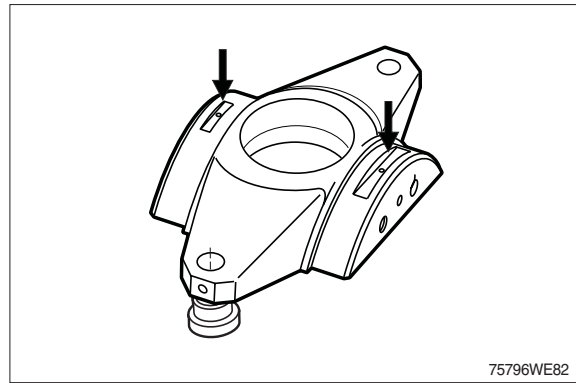

- (5) Check :
That the retaining plate is free of grooves
and that there is no wear in the slipper
pad area.

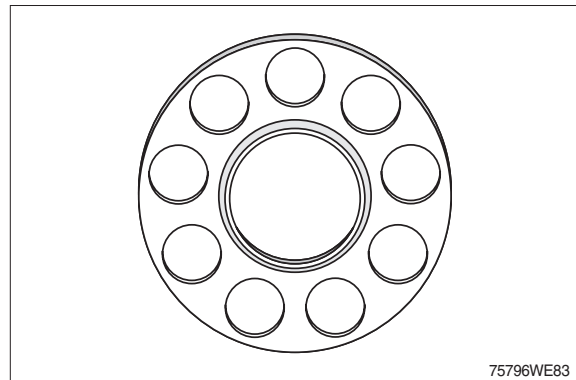

- (6) Check :
Check to see that there are no scratches
or metal deposits on the sliding surface
(1) and that there is no axial play (2)
(Pistons must only be replaced as a set).

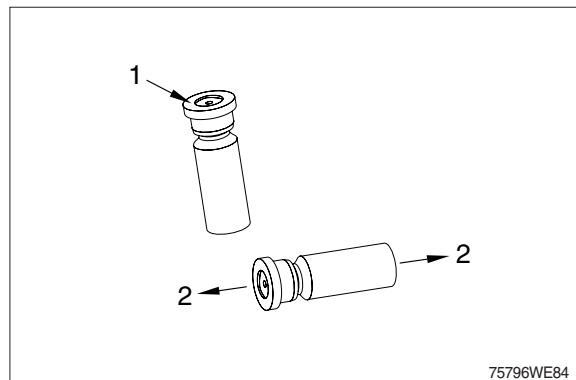

- (7) Check :
1 Cylinder bores
2 Splines

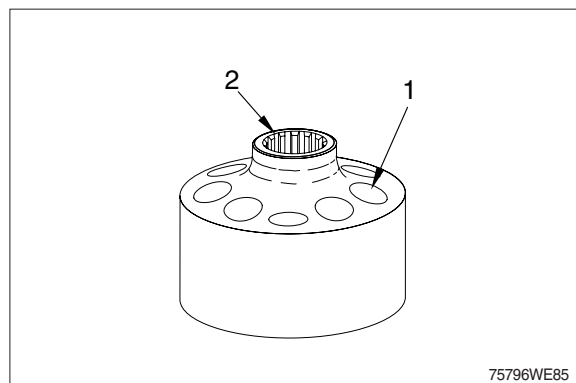

(8) Free of grooves, no signs of wear.

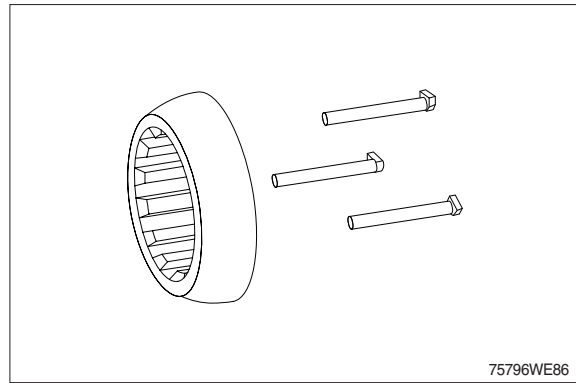

(9) Check :
Cylinder sliding surface free of grooves,
no wear, no embedded foreign particles.
That there are no scratches on the control
plate. (Only replace them as a set).

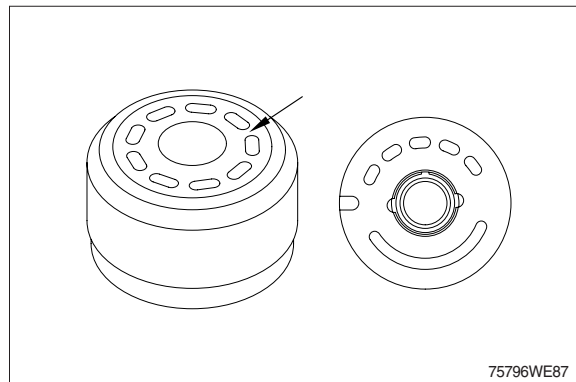

(10) Check :
Mounting surface - control plate
undamaged.

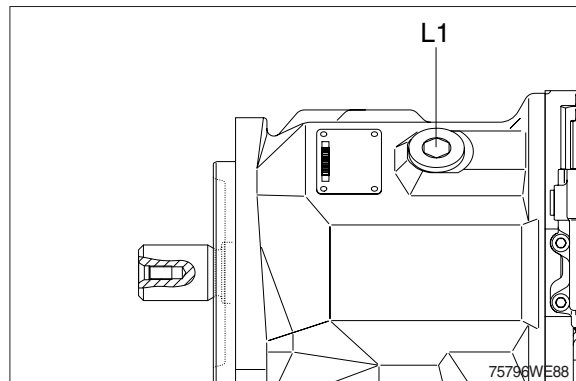

(11) Check :
Check running conditions of the control
piston.

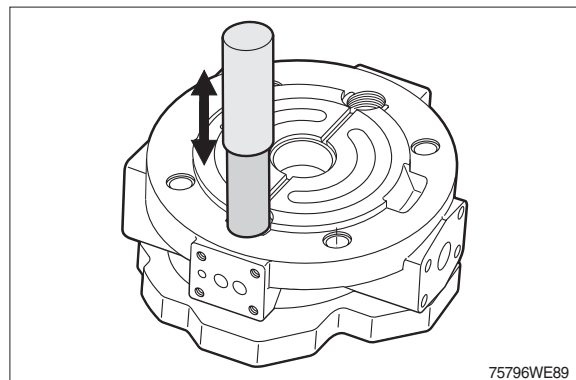

- (12) Check :
Check running conditions of the opposite piston.

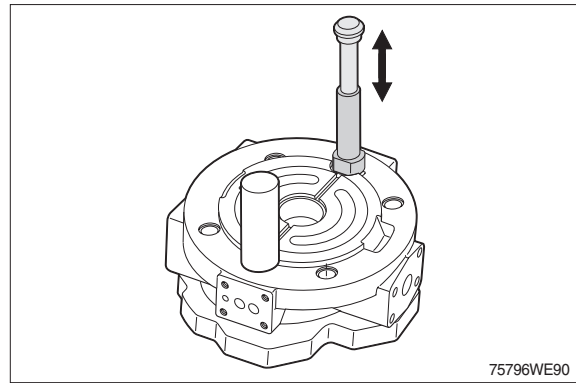

7) ADJUSTMENT OF TAPER ROLLER BEARING SET

- (1) Cast iron housing must have initial tension of the bearings: 0~0,05 mm, grind position A if necessary.

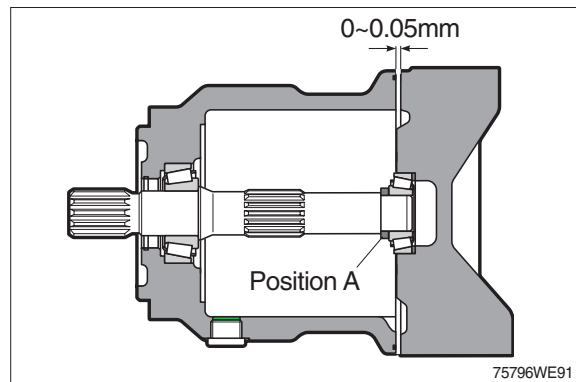

8) PUMP ASSEMBLY

- (1) Fit the seal into the housing.
Fit the circlip.

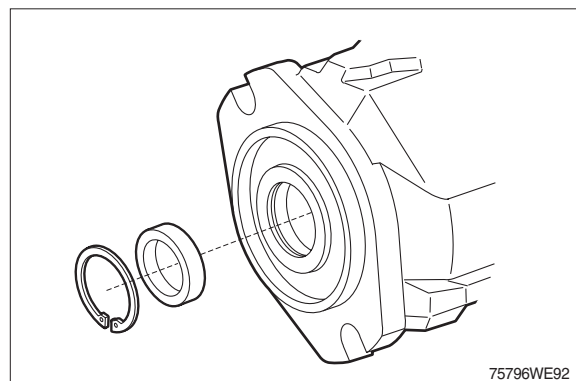

- (2) Fit the drive with bearing from rear end.
※ Do not touch seal lip with edge of keyway or spline.

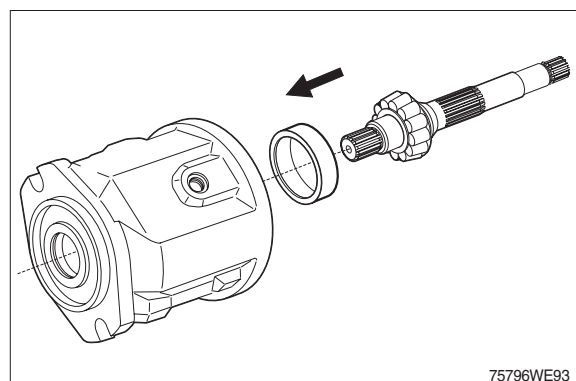

(3) Fit pressure pins using an assembly aid.

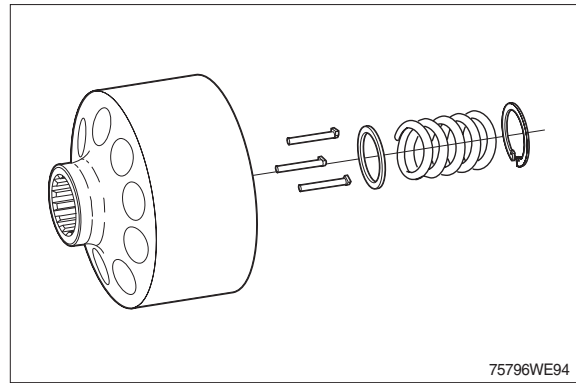

(4) Pre-tension the spring using a suitable device.

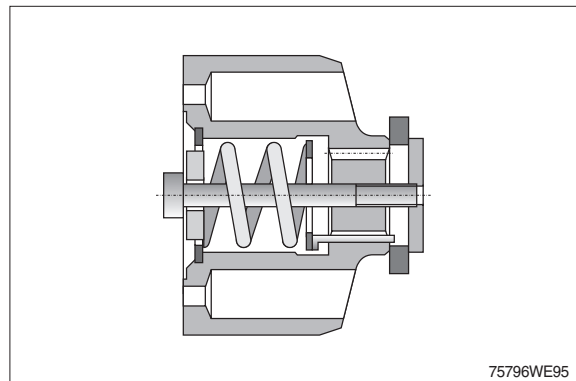

(5) Assemble piston with retaining plate.
※ Oil piston and slipper pad.

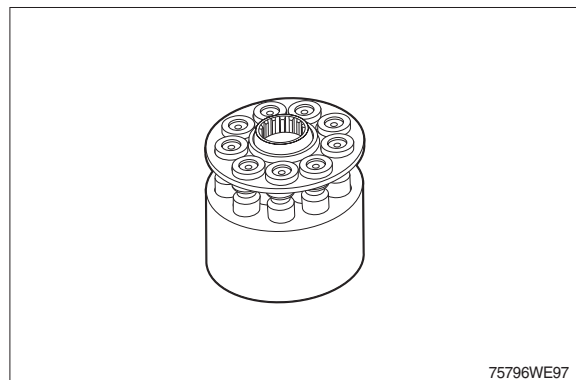

- (6) Fit rotary group.
 ※ Hold the piston by using an O-ring.
 Fit O-ring (1).

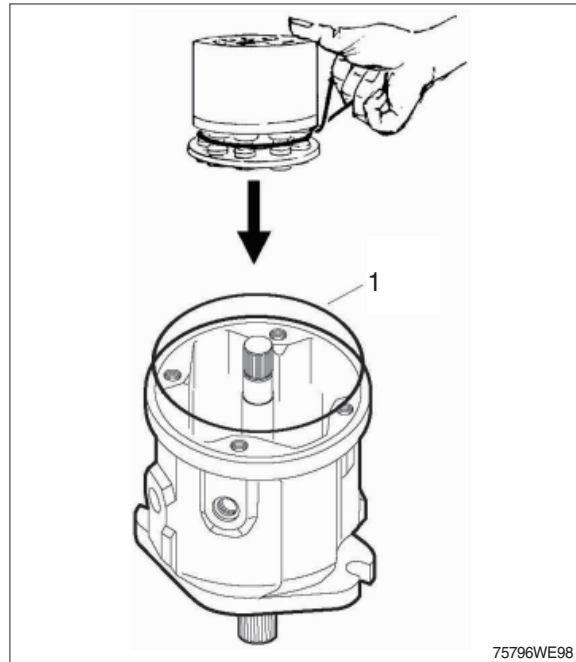

- (7) Fit bearing (1) in connection plate.
 Fit cylindrical pin (2).
 Fit O-rings (3) 4 pieces.
 Fit adjustment spool (4) and guide piston (4a).
 Fit distributor plate (5) (direction of rotation dependent)
 ※ Assembly.
 Hold the components in place with grease.

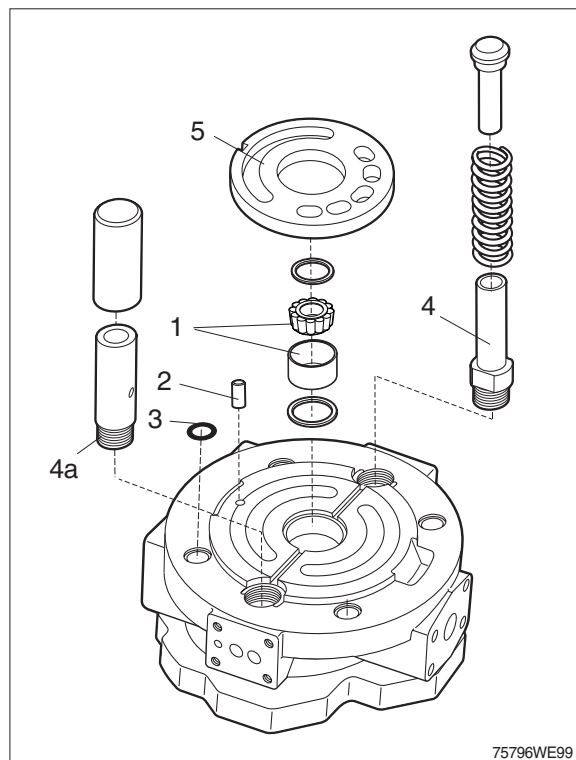

- (8) Fit distributor plate.
※ Assembly aid : Grease

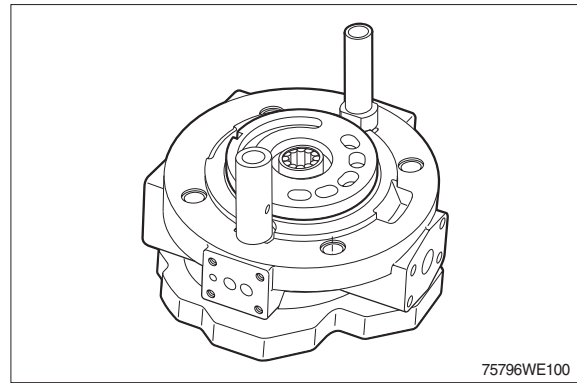

- (9) For clockwise rotation pumps the distributor plate is off-set by 4° to the right from the centre position.
(Clockwise and anti-clockwise rotation distributor plates are not identical).

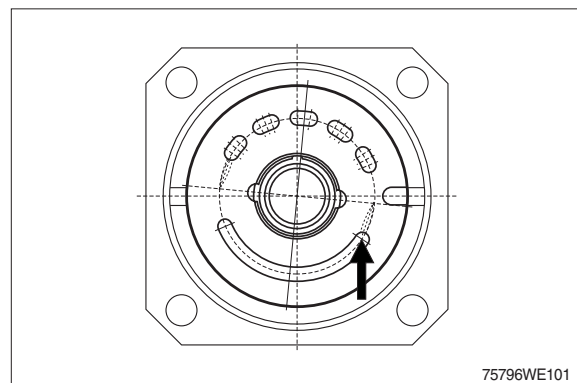

- (10) Fit connection plate and control valve.

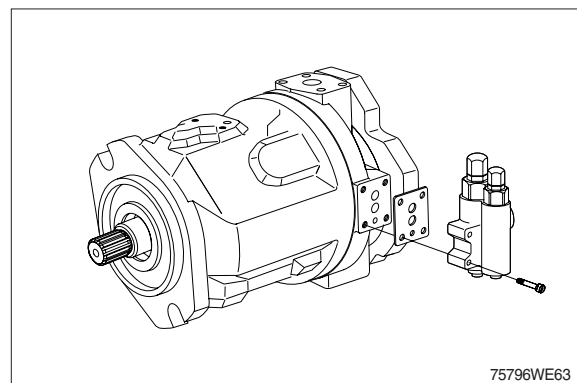

2. MAIN CONTROL VALVE

1) STRUCTURE (1/2)

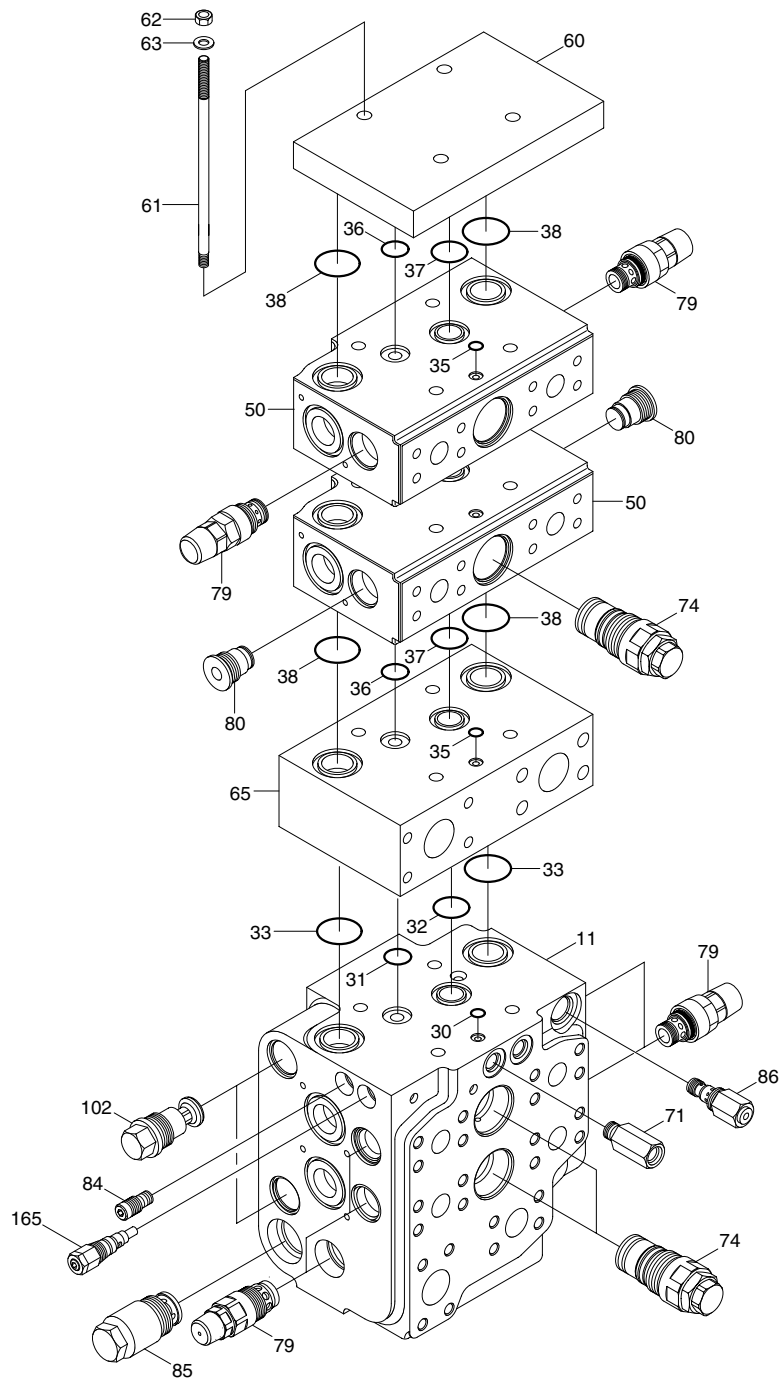

78096WE13

11	Housing	38	O-ring	74	Compensator valve
30	O-ring	50	Housing	79	Pressure valve
31	O-ring	60	Plate	80	Plug screw
32	O-ring	61	Stud	84	Flow regulator
33	O-ring	62	Hexagon nut	85	Precharge valve
35	O-ring	63	Washer	86	Pressure reducing valve
36	O-ring	65	Sandwich plate	102	Locking screw
37	O-ring	71	Shuttle valve	165	Pressure relief valve

STRUCTURE (2/2)

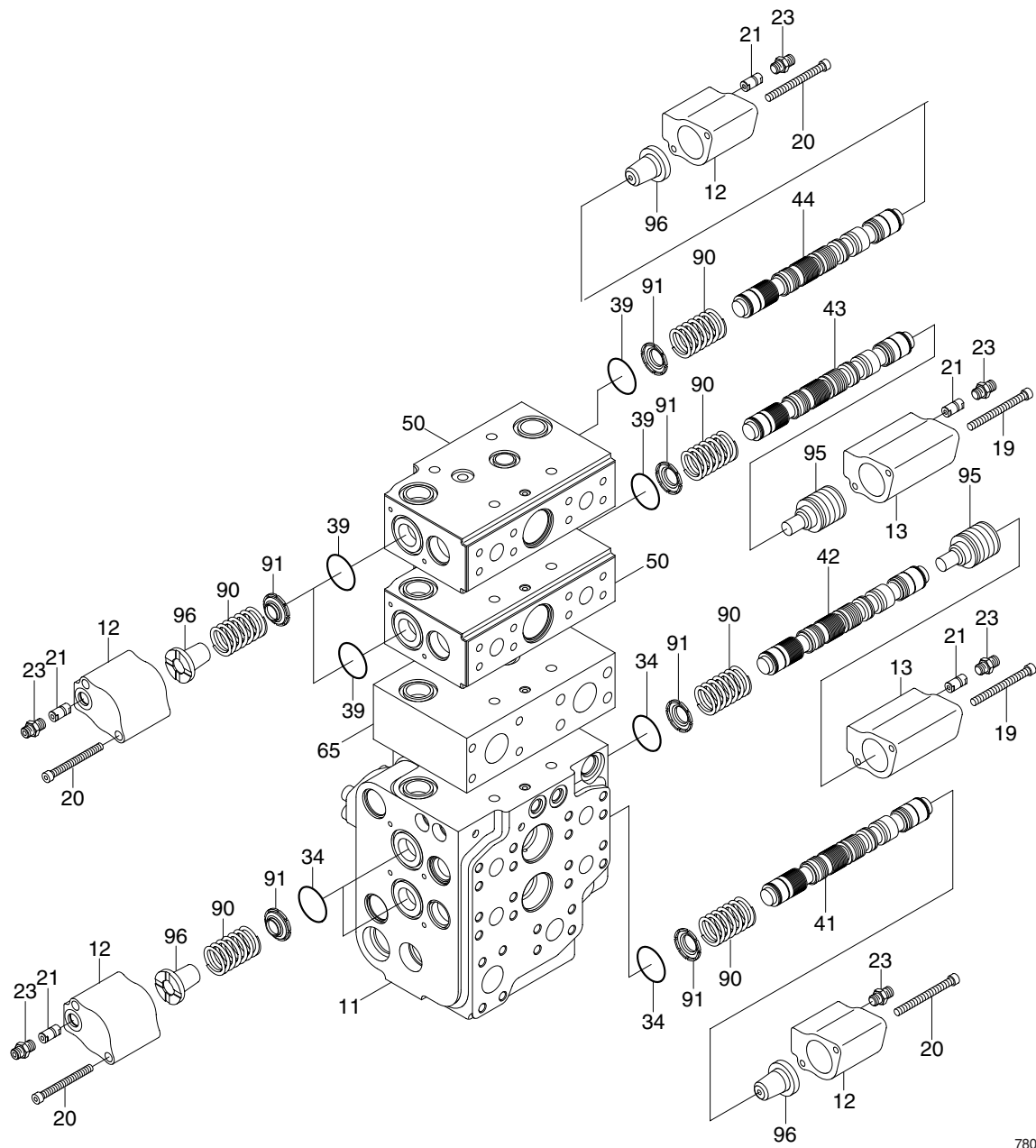

78096WE14

- | | | | | | |
|----|-----------------------------|----|---------|----|--------------------|
| 11 | Housing | 34 | O-ring | 65 | Sandwich plate |
| 12 | Cover | 39 | O-ring | 90 | Compression spring |
| 13 | Cover | 41 | Spool | 91 | Spring retainer |
| 19 | Bolt | 42 | Spool | 95 | Spring retainer |
| 20 | Bolt | 43 | Spool | 96 | Spring retainer |
| 21 | Throttle check valve | 44 | Spool | | |
| 23 | Threaded steel pipe fitting | 50 | Housing | | |

2) GENERAL PRECAUTIONS

- (1) Clean room with no dust is recommended for maintenance. Because hydraulic components are precision, and have minute clearance. Tool and wash-oil must be clean, too. Handle them carefully.
- (2) At removing control valve from the machine, wash around the piping port, and neither dust nor water should go into inside with plugging. It is same at attaching the machine.
- (3) Prepare the required parts by checking structure figure before assembly. There are parts which are supplied with only sub-assembly part, so check the parts list before assembly.

3) PRECAUTIONS FOR DISASSEMBLY

- (1) Handle the components carefully not to drop them or bump them with each other as they are made with precision.
- (2) Do not force the work by hitting or twisting as burred or damaged component may not be assembled or result in oil leakage or low performance.
- (3) When disassembled, tag the components for identification so that they can be reassembled correctly.
- (4) Once disassembled, O-ring and back-up rings are usually not to be used again.(Remove them using a wire with its end made like a shoe-horn. Be careful not to damage the slot)
- (5) If the components are left disassembled or half-disassembled, they may get rust from moisture or dust. If the work has to be interrupted, take care to prevent rust and dust.

4) PRECAUTIONS FOR REASSEMBLY

- (1) Take the same precautions as for disassembly.
- (2) When assembling the components, remove any metal chips or foreign objects and check them for any burrs or dents. Remove burrs and dents with oil-stone, if any.
- (3) O-rings and back-up rings are to be replaced with new ones, as a rule.
- (4) When installing O-rings and back-up rings, be careful not to damage them. (Apply a little amount of grease for smoothness)
- (5) Tighten the bolts and caps with specified torque.

5) DISASSEMBLY AND ASSEMBLY

(1) Spool

- ① Loosen the bolt (2EA).
 - Tool : Wrench 5 mm
 - Tightening torque : 0.85 kgf · m
(6.1 lbf · ft)



76096WE40

- ② Remove the cover, spring retainer, spring and spool.

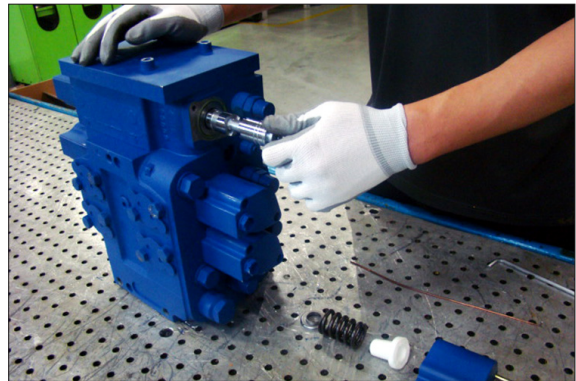

76096WE41

- 1 Spring
- 2 Spring retainer
- 3 Spool
- 4 Cover
- 5 Bolt

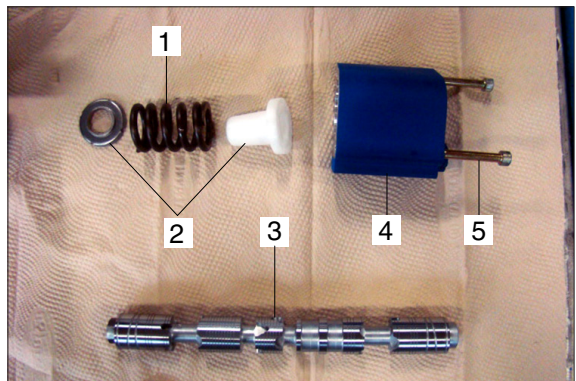

76096WE42

(2) Compensator valve

- Tool : Spanner 42 mm

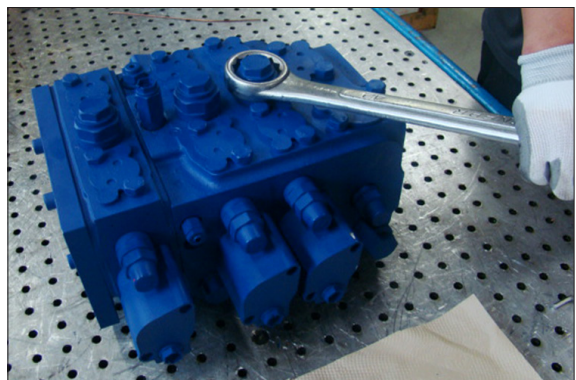

76096WE43

- Tightening torque : 20.4 kgf · m
(148 lbf · ft)

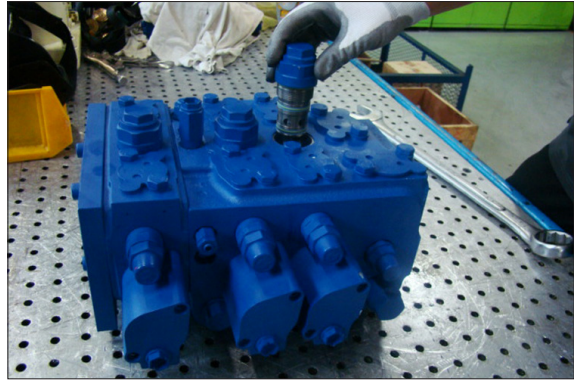

76096WE44

(3) Port relief valve

- Tool : Spanner 30 mm

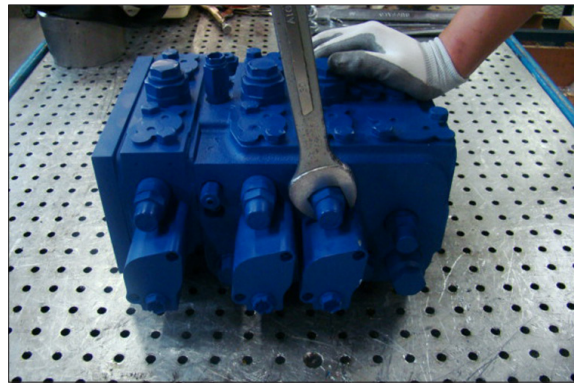

76096WE45

- Tightening torque : 10.2 kgf · m
(73.8 lbf · ft)

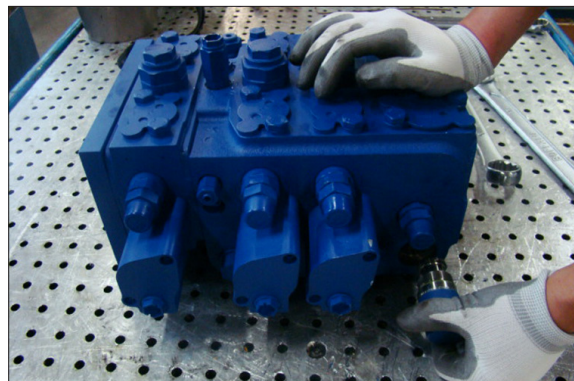

76096WE46

(4) Precharge valve

- Tool : Spanner 32 mm

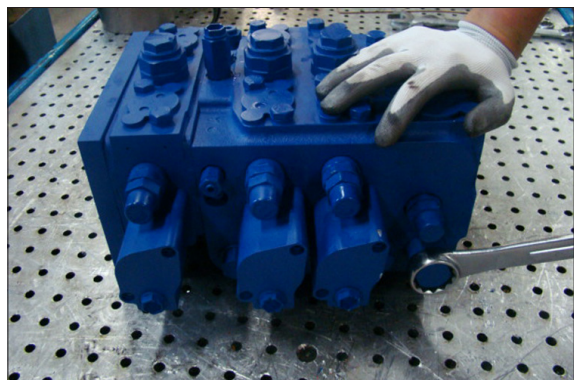

76096WE47

- Tightening torque : 6.1 kgf · m
(44.3 lbf · ft)

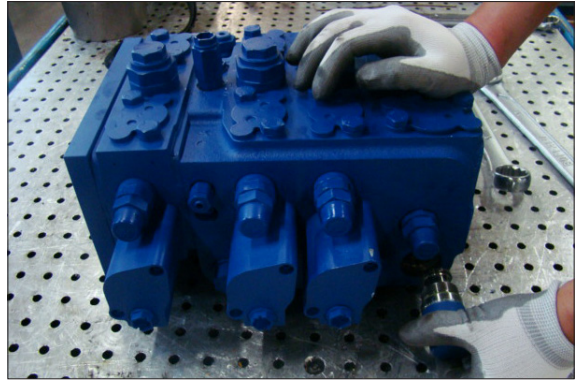

76096WE48

(5) Shuttle valve

- Tool : Spanner 22 mm

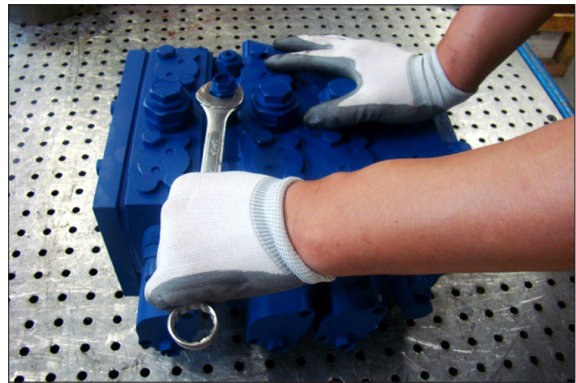

76096WE49

- Tightening torque : 3.6 kgf · m
(25.8 lbf · ft)

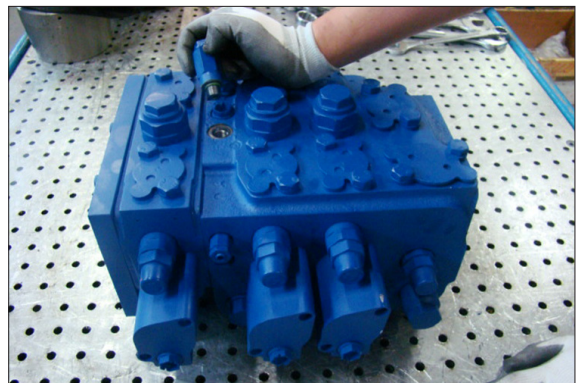

76096WE50