

SECTION 7 ELECTRICAL SYSTEM

GROUP 1 COMPONENT LOCATION

1. LOCATION 1

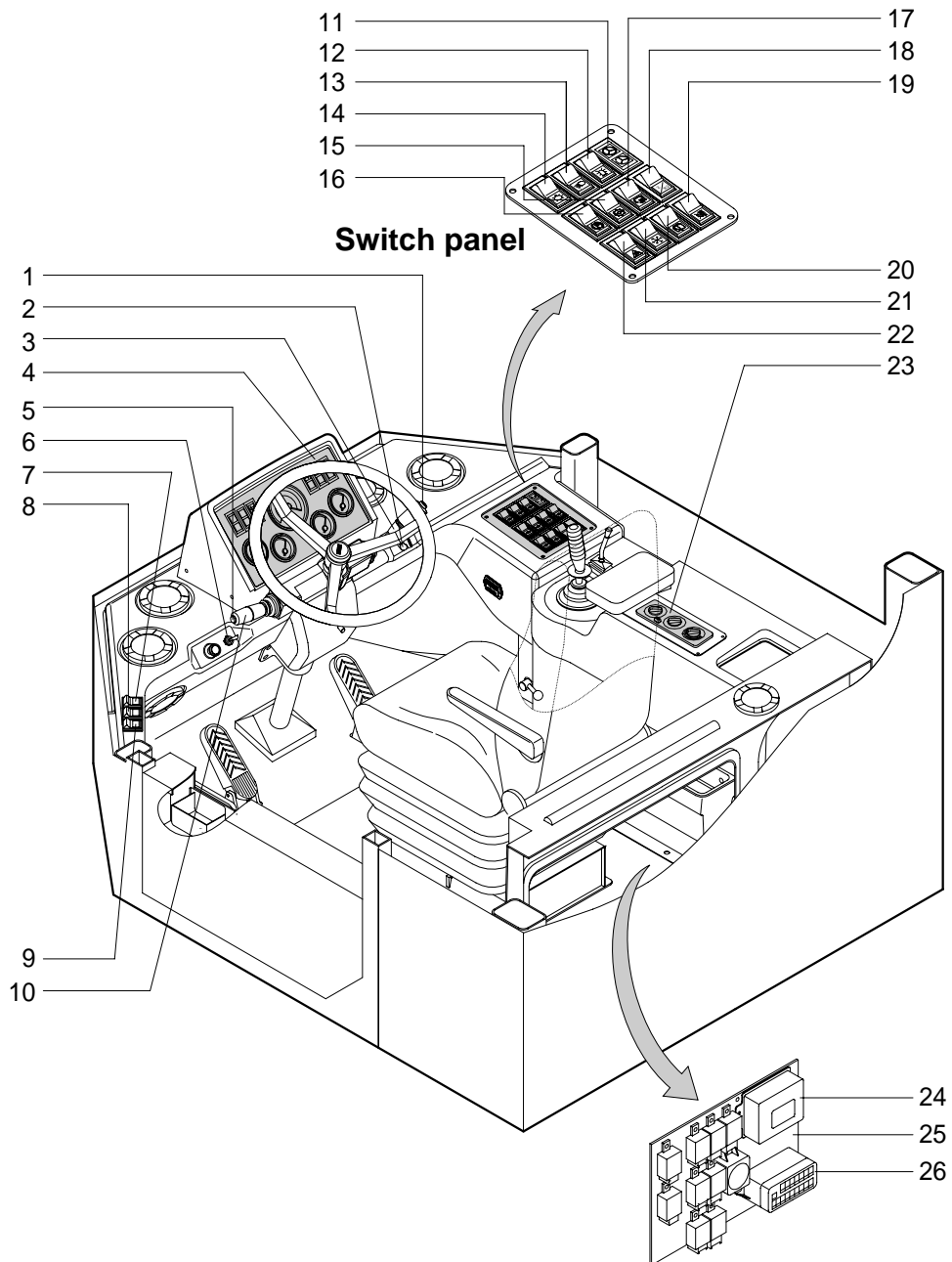

- | | | | | | |
|---|-------------------------------|----|---|----|--------------------------|
| 1 | Horn button | 10 | EGS lever | 19 | Buzzer stop switch |
| 2 | Starting switch | 11 | Emergency steering pilot lamp(Optional) | 20 | Rear wiper/washer switch |
| 3 | Multi function switch | 12 | Beacon switch(Optional) | 21 | Air conditioner switch |
| 4 | Cluster | 13 | Work lamp switch | 22 | Hazard switch |
| 5 | Kick down switch | 14 | Main light switch | 23 | Aircon & heater switch |
| 6 | Override switch | 15 | Clutch cut off switch | 24 | Check unit |
| 7 | Ride control switch(Optional) | 16 | Parking brake switch | 25 | Relay board |
| 8 | Attachment engage switch | 17 | Cold start switch(Optional) | 26 | Fuse box |
| 9 | Attachment disengage switch | 18 | Prolix switch | | |

2. LOCATION 2

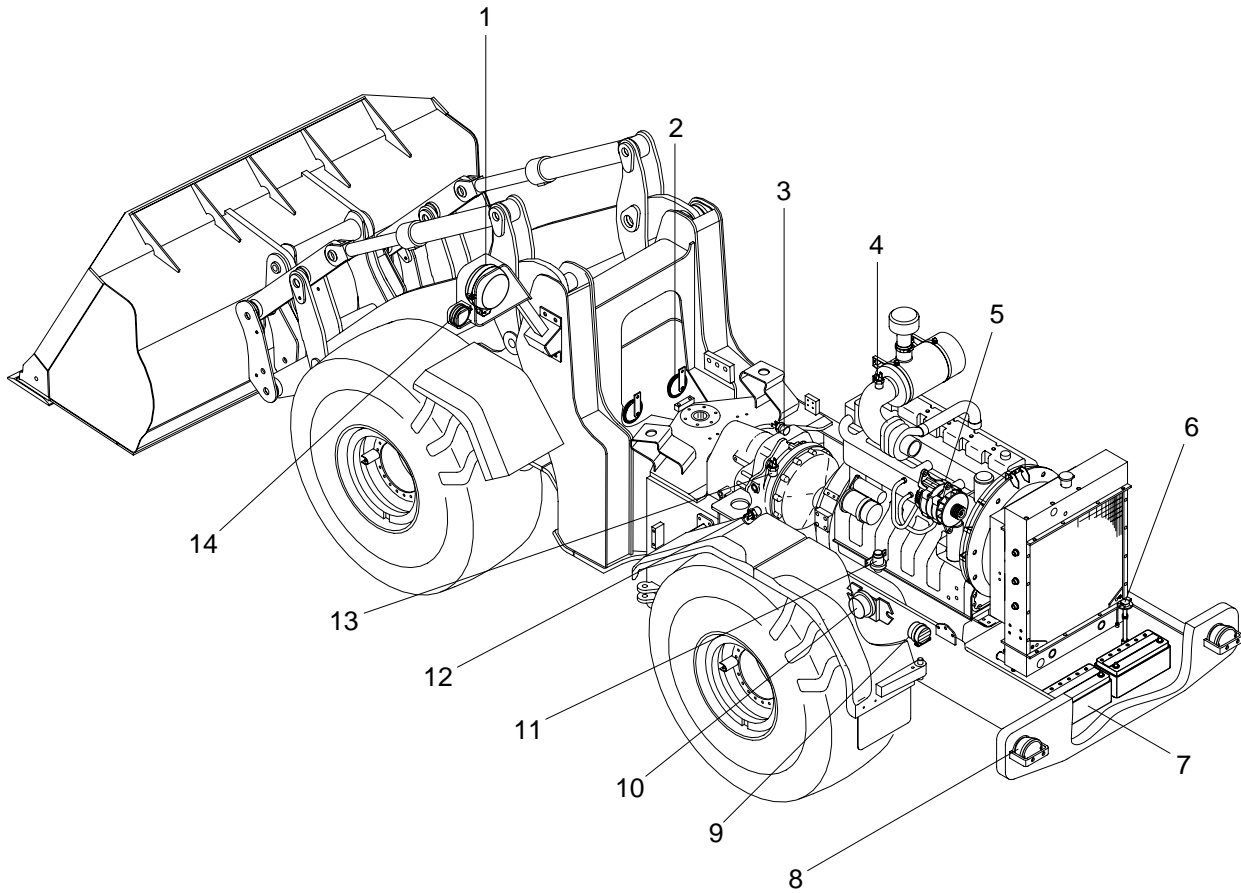

- | | | | | | |
|---|------------------------|----|----------------------|----|----------------------------|
| 1 | Head lamp | 6 | Fuel sender | 11 | Start relay |
| 2 | Horn | 7 | Battery | 12 | Brake pressure switch |
| 3 | Oil temperature sender | 8 | Tail stop flash lamp | 13 | Clutch oil pressure switch |
| 4 | Air cleaner switch | 9 | Back up buzzer | 14 | Front turn lamp |
| 5 | Alternator | 10 | Battery relay | | |