

Operation Manual 2012

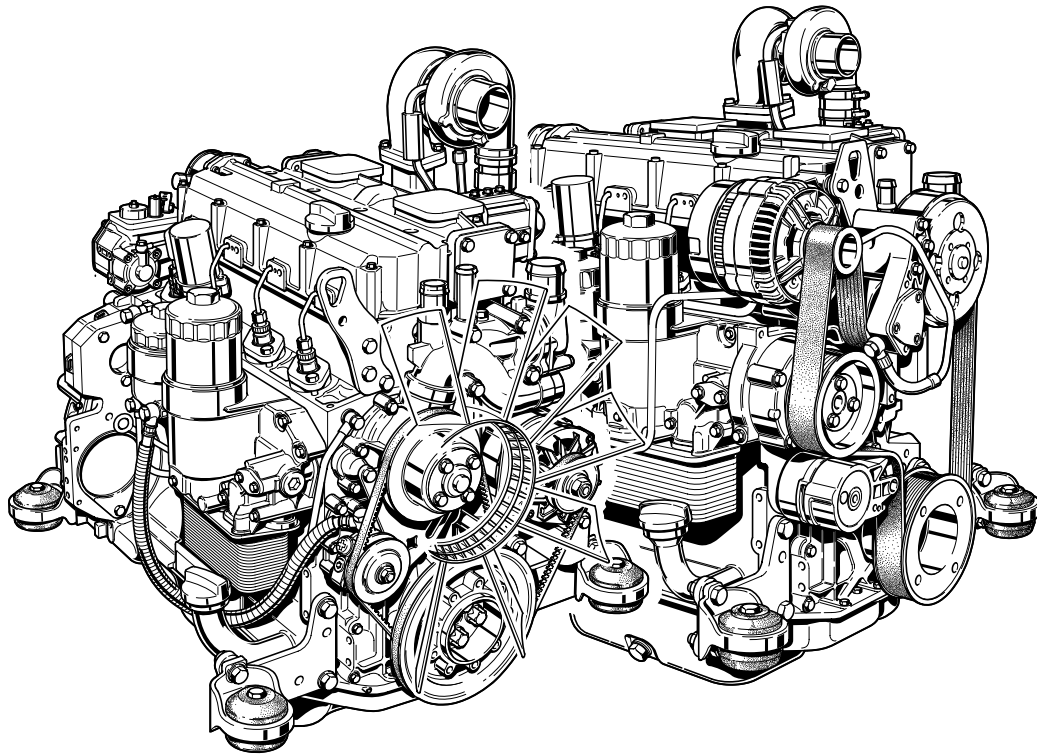

Safety guidelines / Accident prevention



- Please read and observe the information given in this Operation Manual. This will enable you to avoid accidents, preserve the manufacturer's warranty and maintain the engine in peak operating condition.
- This engine has been built exclusively for the application specified in the scope of supply, as described by the equipment manufacturer and is to be used only for the intended purpose. Any use exceeding that scope is considered to be contrary to the intended purpose. The manufacturer will not assume responsibility for any damage resulting therefrom. The risks involved are to be borne solely by the user.
- Use in accordance with the intended purpose also implies compliance with the conditions laid down by the manufacturer for operation, maintenance and servicing. The engine should only be operated by personnel trained in its use and the hazards involved.
- The relevant accident prevention guidelines and other generally accepted safety and industrial hygiene regulations must be observed.
- When the engine is running, there is a risk of injury through:
 - turning/hot components
 - engines with positive ignition
 - ignition systems (high electrical voltage)
You must avoid contact at all times!
- Unauthorized engine modifications will invalidate any liability claims against the manufacturer for resultant damage. Manipulations of the injection and regulating system may also influence the performance of the engine, and its emissions. Adherence to legislation on pollution cannot be guaranteed under such conditions.
- Do not change, convert or adjust the cooling air intake area to the blower. The manufacturer shall not be held responsible for any damage which results from such work.
- When carrying out maintenance/repair operations on the engine, the use of DEUTZ original parts is prescribed. These are specially designed for your engine and guarantee perfect operation. Non-compliance results in the expiry of the warranty!
- Maintenance and cleaning of the engine should only be carried out when the engine is switched off and has cooled down. You must ensure that the electrical systems have been switched off and the ignition key has been removed. Accident prevention guidelines concerning electrical systems (e.g. VDE-0100/-0101/-0104/-0105 Electrical protective measures against dangerous touch voltage) are to be observed. When cleaning with fluids, all electrical components are to be covered impermeably.

Operation Manual 2012

0297 9912 en

Engine Serial
Number:

--	--	--	--	--	--	--	--

Please enter the engine serial number here. This number should be quoted when inquiring about Customer Service, Repairs or Spare Parts (see Section 2.1).

Technical modifications required to improve our engines are reserved with regard to specification data and other technical information contained in this Operation Manual. No parts of this Manual may be reproduced in any form or by any means without our written approval.



Foreword

Dear Customer,

Liquid-cooled DEUTZ engines are designed for a large number of applications. Consequently, a wide range of variants are offered to meet the requirements of specific cases.

Your engine is appropriately equipped for the installation concerned, which means that not all of the components described in this Operation Manual are necessarily mounted to your engine.

We have endeavored to highlight any differences so that you will be able to locate the operating and maintenance instructions relevant to your engine quickly and easily.

Please read this Manual before starting your engine, and always observe the operating and maintenance instructions. We are available to help with any additional inquiries

Sincerely,

DEUTZ AG

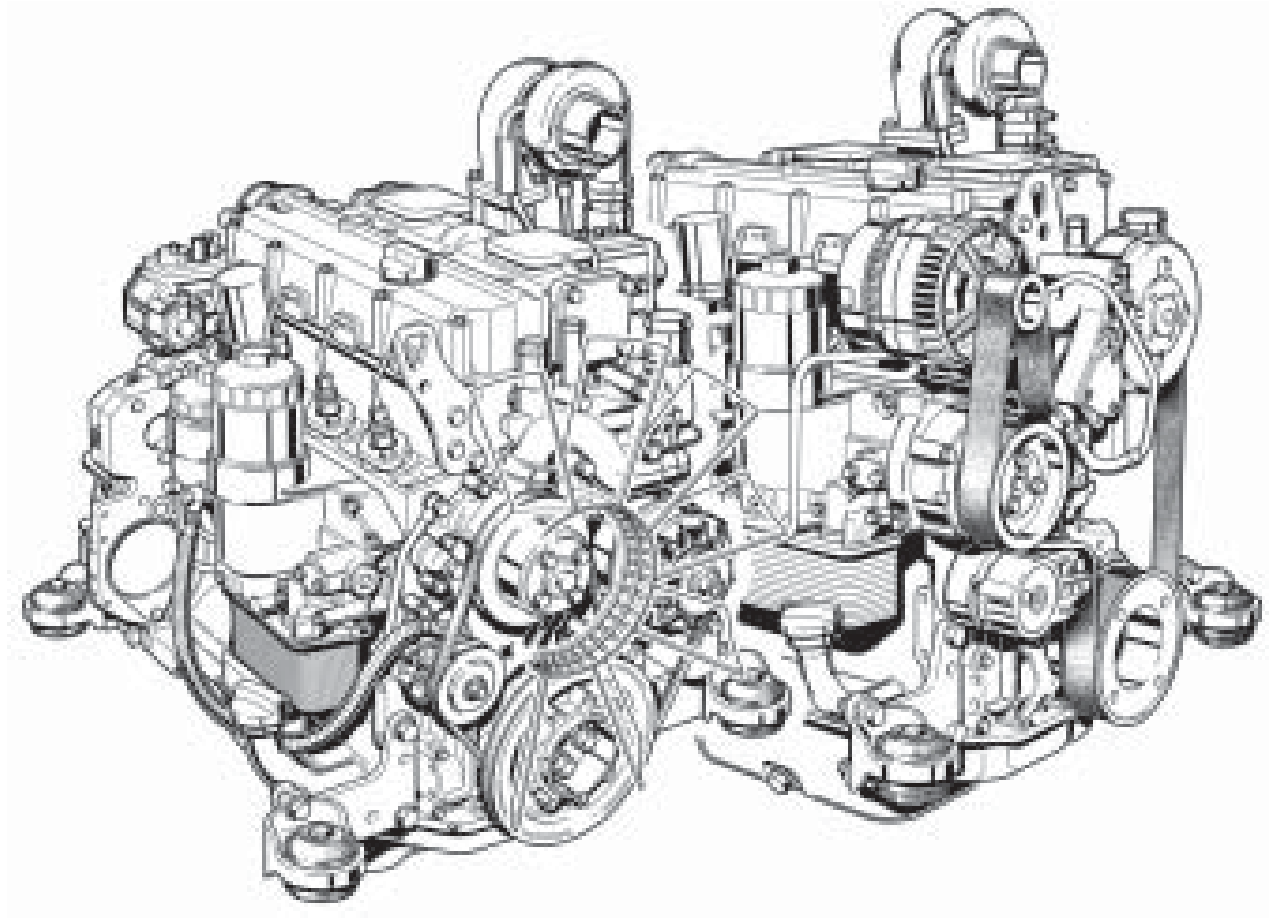

1. General

2. Engine Description

- 2.1 Model
 - 2.1.1 Rating Plate
 - 2.1.2 Position of the Rating Plate
 - 2.1.3 Engine Serial Number
 - 2.1.4 Cylinder Enumeration
 - 2.2 Engine Illustrations
 - 2.2.1 Operating Side 2012 Ribbed V-belt Drive
 - 2.2.2 Starter Side 2012 Ribbed V-belt Drive
 - 2.2.3 Operating Side 2012
 - 2.2.4 Starter Side 2012
 - 2.3 Lube Oil Circuit Schematic
 - 2.3.1 Lube Oil Plan
 - 2.4 Fuel System
 - 2.4.1 Fuel System Plan
 - 2.5 Coolant System
 - 2.5.1 Coolant Plan 2012
- ## 3. Engine Operation
- 3.1 Commissioning
 - 3.1.1 Pour in Engine Oil
 - 3.1.2 Filling Oil Bath Air Filter with Engine Oil
 - 3.1.3 Pour in Fuel
 - 3.1.4 Fill / Bleed Cooling System
 - 3.1.5 Other Preparations
 - 3.2 Starting

- 3.2.1 Electric Starting
- 3.3 Monitoring Operation
 - 3.3.1 Engine Oil Pressure
 - 3.3.2 Coolant Temperature
- 3.4 Shutting off
 - 3.4.1 Mech. Stopping
 - 3.4.2 Electr. Stopping
- 3.5 Operating Conditions
 - 3.5.1 Winter Operation
 - 3.5.2 High Ambient Temperature, High Altitude

4. Operating Media

- 4.1 Lube Oil
 - 4.1.1 Quality
 - 4.1.2 Viscosity
- 4.2 Fuel
 - 4.2.1 Quality
 - 4.2.2 Winter Fuel
- 4.3 Coolant
 - 4.3.1 Water Quality for Coolant
 - 4.3.2 Coolant Treatment
 - 4.3.3 Cooling System Protectants

5. Routine Maintenance

- 5.1 Maintenance Plan
- 5.2 Maintenance Diagram
- 5.3 Maintenance Work Completed

6. Service and Maintenance

- 6.1 Lubrication System

- 6.1.1 Oil Change Intervals
- 6.1.2 Check Oil Level, Change Engine Oil
- 6.1.3 Replace Oil Filter
- 6.1.4 Clean/Replace Oil Filter (Cup)
- 6.2 Fuel System
 - 6.2.1 Replace Fuel Filter
 - 6.2.2 Fuel Pre-filter, Clean Filter Element / Replace if Necessary
 - 6.2.3 Bleed Fuel System with Fuel Pre-filter
 - 6.2.4 Bleed Fuel System without Fuel Pre-filter
- 6.3 Cooling System
 - 6.3.1 Cleaning Intervals
 - 6.3.2 Clean Cooling System
 - 6.3.3 Drain Cooling System
 - 6.3.4 Fill / Bleed Cooling System
- 6.4 Combustion Air Filter
 - 6.4.1 Cleaning Intervals
 - 6.4.2 Emptying Cyclone Type Precleaner
 - 6.4.3 Clean Oil Bath Air Filter
 - 6.4.4 Dry Type Air Cleaner
- 6.5 Belt Drives
 - 6.5.1 Check V-belts
 - 2012 Standard
 - 2012 with Ribbed V-belt

Index

- 6.5.2 Tension V-belts
Coolant / Fuel Pump
- 6.5.3 Replace V-belts
Coolant / Fuel Pump
- 6.5.4 Replace V-belts
Ribbed V-belts
- 6.5.5 Tension Alternator V-belts
- 6.5.6 Replace Alternator V-belts
- 6.5.7 Wedge rib V-belts wear limit examine
- 6.6 Adjustments
 - 6.6.1 Check Valve Clearance (Adjust if Necessary)
 - 6.6.1.1 Valve Clearance Adjustment Plan
- 6.7 Accessories
 - 6.7.1 Battery
 - 6.7.2 Rotary Current Alternator
 - 6.7.3 Transportation Shackles

7. Faults, Causes and Remedies

- 7.1 Fault Table

8. Engine Preservation

- 8.1 Preservation

9. Technical Specification

- 9.1 Engine Specifications and Settings
- 9.2 Screw Tightening Torques
- 9.3 Tools

10. Service

DEUTZ Diesel Engines

are the product of many years of research and development. The resulting know-how, coupled with stringent quality standards, guarantee their long service life, high reliability and low fuel consumption.

It goes without saying that DEUTZ Diesel Engines meet the highest standards for environmental protection.

Beware of Running Engine

Shut the engine down before carrying out maintenance or repair work. Ensure that the engine cannot be accidentally started. Risk of accidents.

When the work is complete, be sure to refit any panels and guards that may have been removed. Never fill the fuel tank while the engine is running. Observe industrial safety regulations when running the engine in an enclosed space or underground.

Care and Maintenance

Sound care and maintenance practices will ensure that the engine continues to meet the requirements placed on it. Recommended service intervals must be observed and service and maintenance work carried out conscientiously.

Special care should be taken under abnormally demanding operating conditions.

Safety



This symbol is used for all safety warnings. Please follow them carefully. The attention of operating personnel should be drawn to these safety instructions. General safety and accident prevention regulations laid down by law must also be observed.

Asbestos



DEUTZ original parts are asbestos-free.

Service

Please contact one of our authorized service representatives in the event of breakdowns or for spare parts inquiries. Our trained specialists will carry out repairs quickly and professionally, using only genuine spare parts.

Original parts from DEUTZ AG are always produced in accordance with state-of-the-art technology. Please turn to the end of this manual for further service information.

California Proposition 65 Warning

Diesel engine exhaust and some of its constituents are known to the State of California to cause cancer, birth defects, and other reproductive harm.

- 2.1 Model
- 2.2 Engine Illustrations
- 2.3 Lube Oil Circuit Schematic
- 2.4 Fuel System
- 2.5 Coolant System

2.1.1 Rating Plate

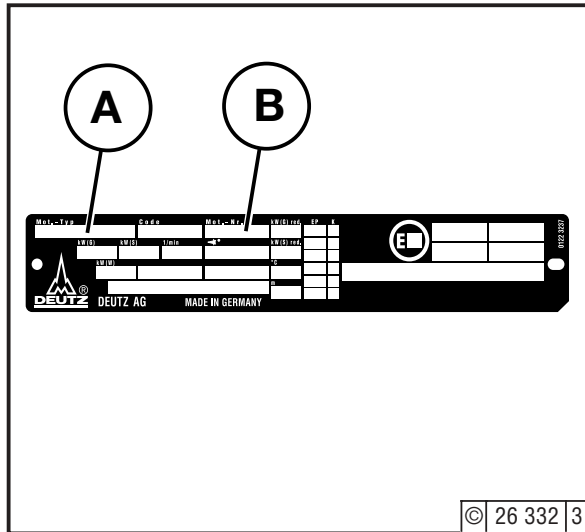

The model **A**, the engine serial number **B** and the performance data are stamped on the rating plate. The model and engine serial number must be given when ordering parts.

2.1.2 Position of the Rating Plate

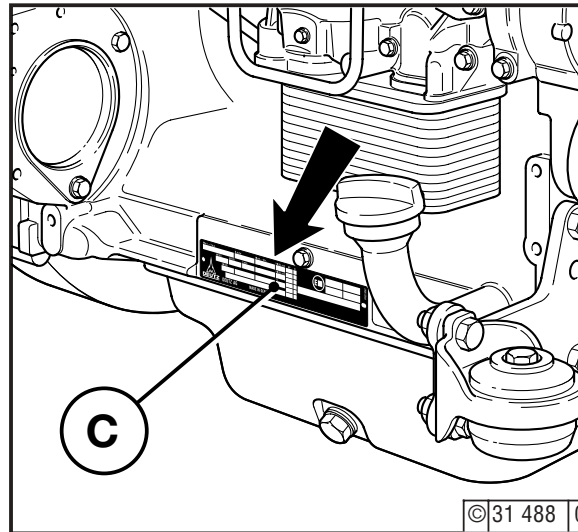

The rating plate **C** is attached to the crankcase.

2.1.3 Engine Serial Number

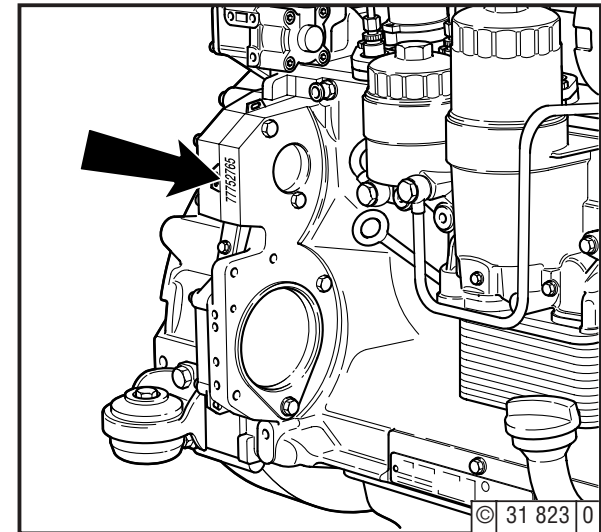

The engine serial number is stamped on the crankcase (**arrow**) as well as the rating plate.

2.1.4 Cylinder Enumeration

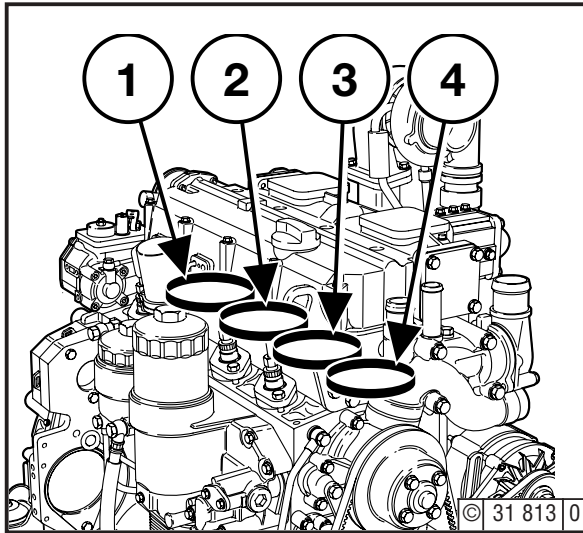

Cylinders are numbered consecutively, beginning at the flywheel.

Engine Description

2.2 Engine Illustration

2

2.2.1 Operating Side 2012 Ribbed V-belt drive

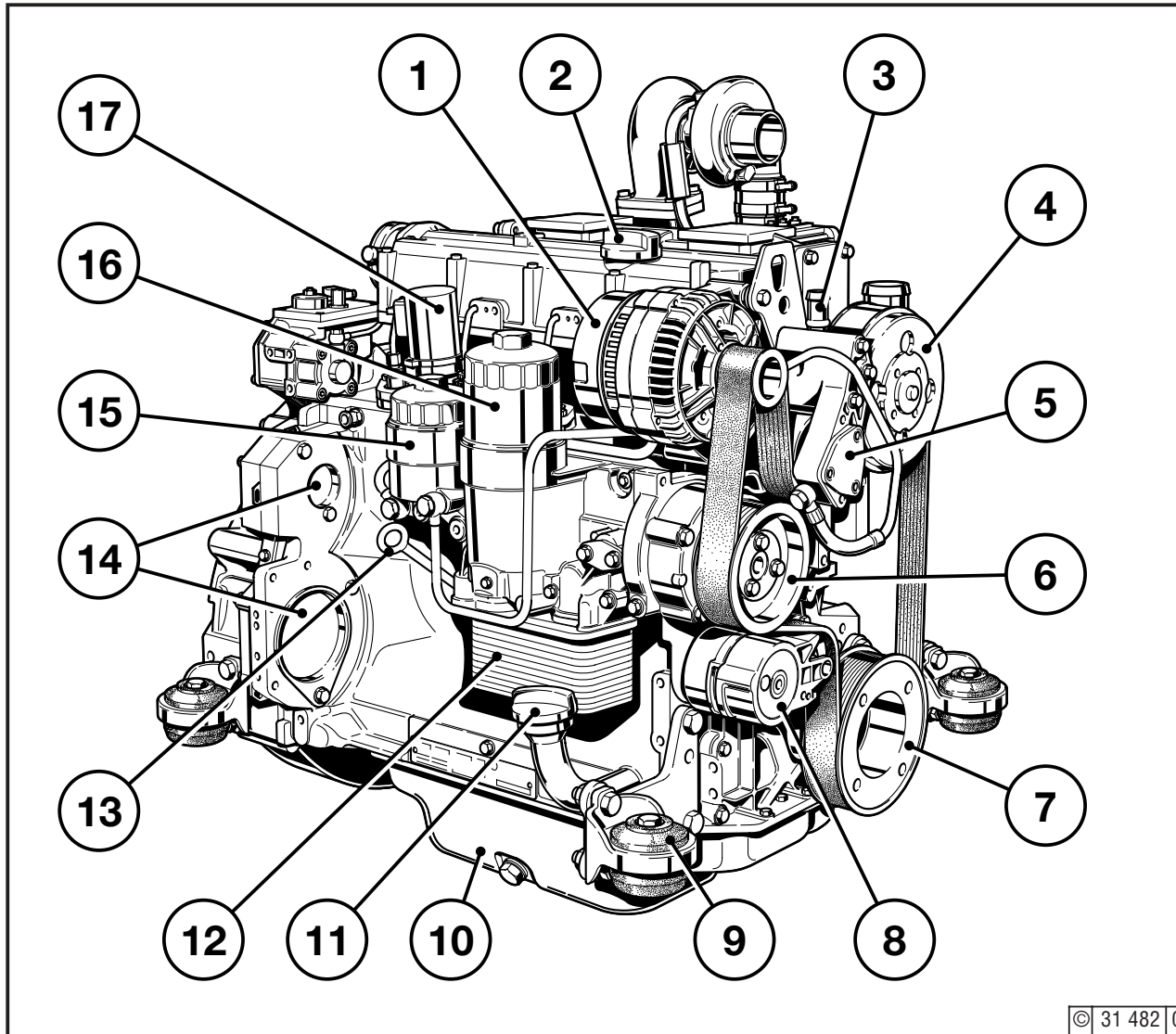

- 1 Alternator
- 2 Oil filler
- 3 Coolant connection compensation line
- 4 Fan pulley
- 5 Fuel pump
- 6 Coolant pump
- 7 Ribbed V-belt pulley on crankshaft
- 8 Tension roller
- 9 Feet
- 10 Oil pan
- 11 Oil filler neck
- 12 Oil filter housing with engine oil cooler
- 13 Oil dipstick
- 14 Optional attachment of:
Compressor or hydraulic pump
- 15 Fuel filter cartridge
- 16 Oil filter cartridge
- 17 Tractive electromagnet

2.2 Engine Illustration

Engine Description

2.2.2 Starter Side 2012 Ribbed V-belt drive

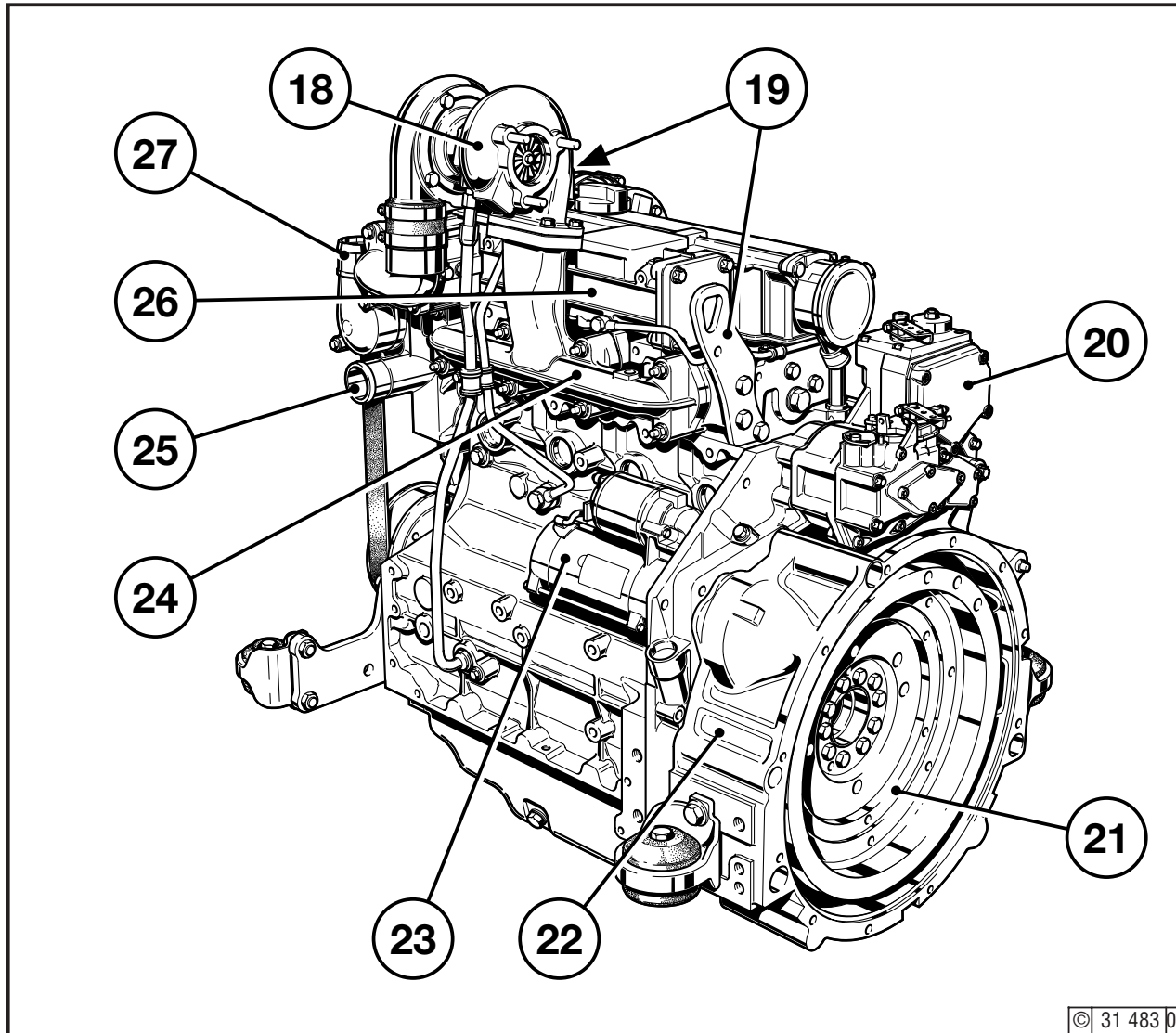

- 18 Turbocharger
- 19 Engine suspension
- 20 Speed regulator
- 21 Flywheel
- 22 SAE housing
- 23 Starter
- 24 Exhaust manifold
- 25 Coolant inlet
- 26 Heater flange not shown
- 27 Thermostat housing coolant outlet

2.2.3 Operating Side 2012

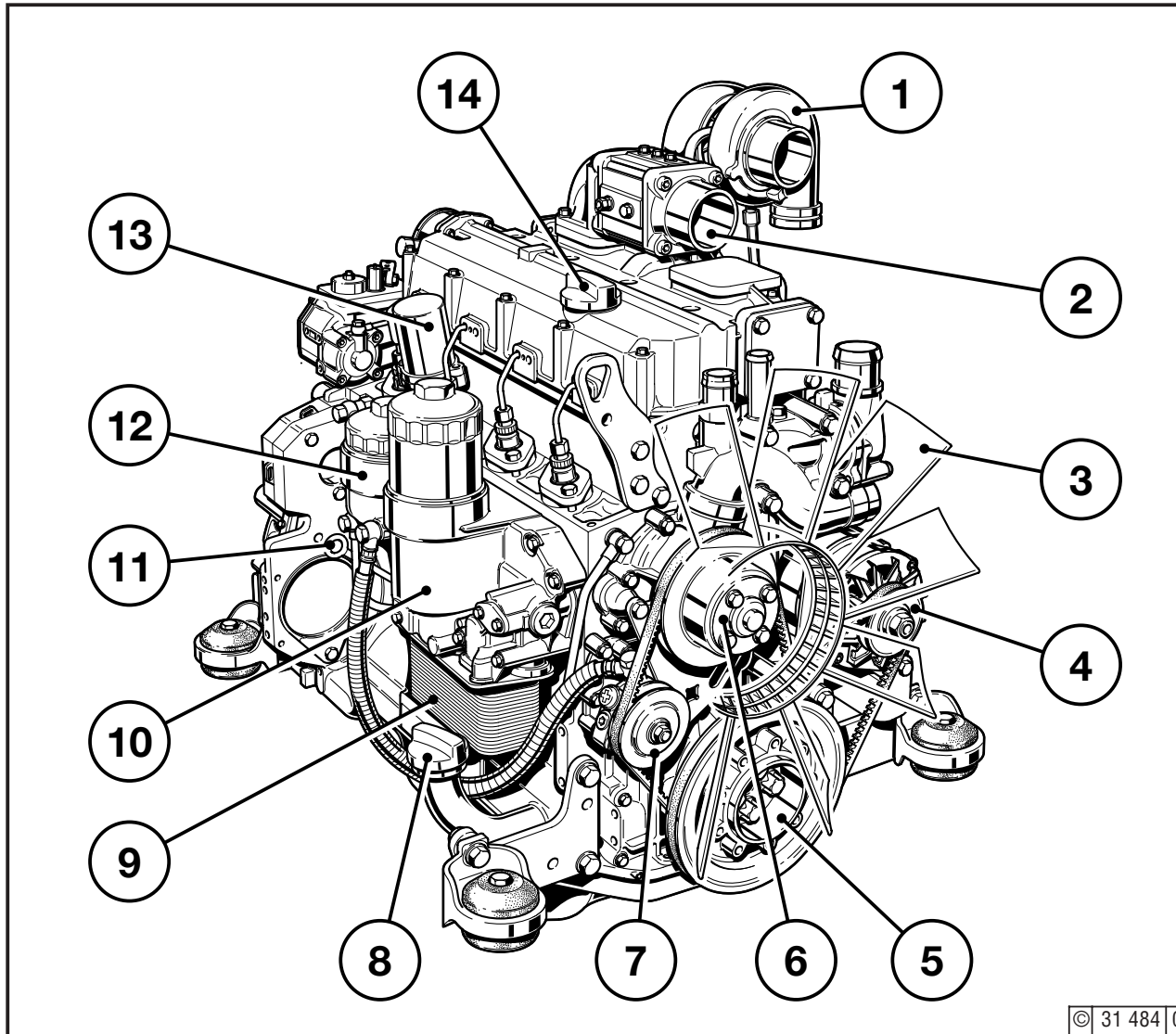

- 1 Turbocharger
- 2 Heater flange
- 3 Fan
- 4 Alternator
- 5 V-belt pulley on crankshaft
- 6 Coolant pump
- 7 Fuel pump
- 8 Oil filler
- 9 Oil filter housing with engine oil cooler
- 10 Oil filter housing with oil filter cartridge
- 11 Oil dipstick
- 12 Fuel filter
- 13 Tractive electromagnet
- 14 Oil filler neck

2.2 Engine Illustration

Engine Description

2.2.4 Starter Side 2012

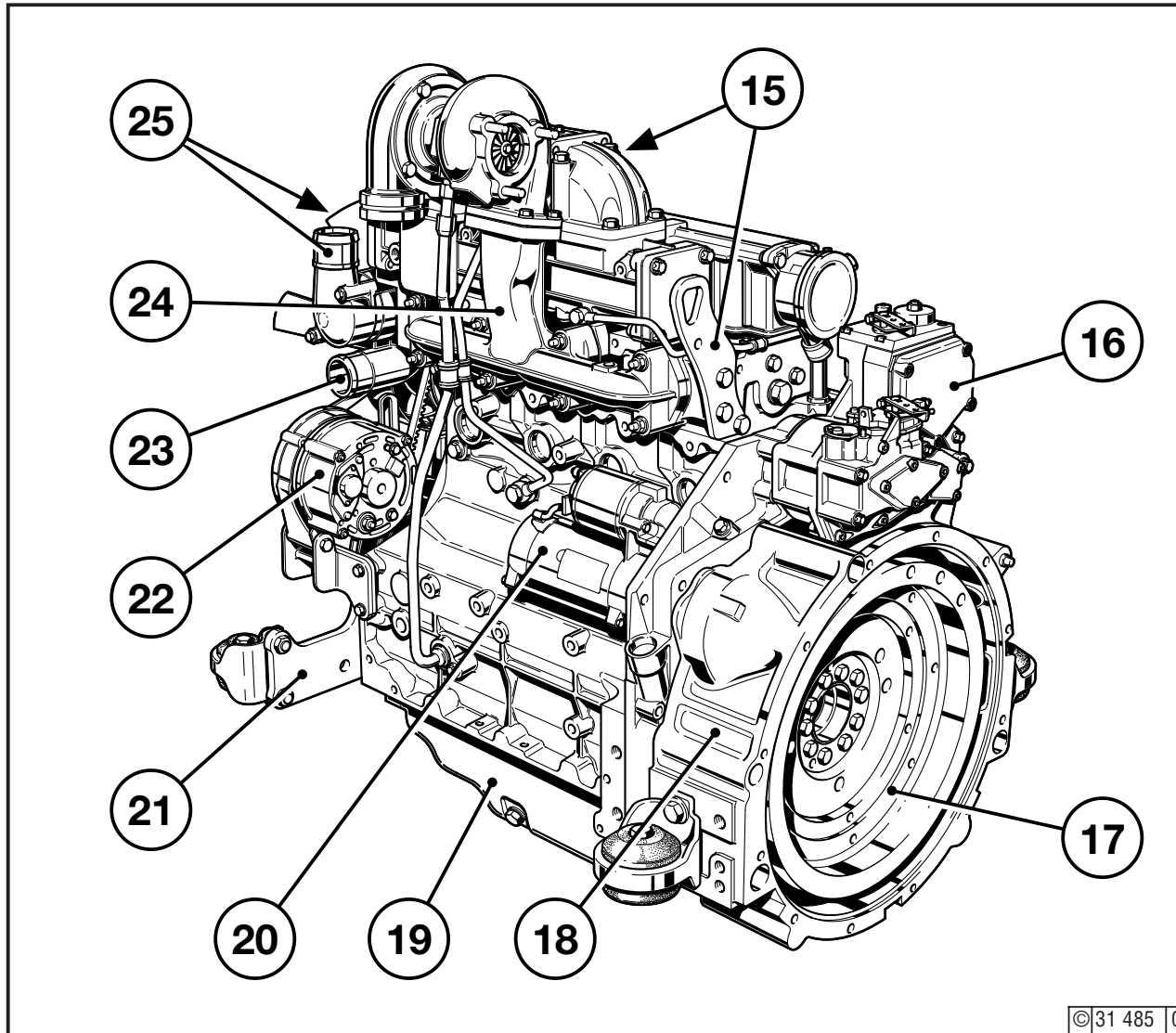

- 15 Engine suspension
- 16 Speed regulator
- 17 Flywheel
- 18 SAE housing
- 19 Oil pan
- 20 Starter
- 21 Feet
- 22 Alternator
- 23 Coolant inlet
- 24 Exhaust manifold
- 25 Coolant outlet

2.3.1 Lube Oil Plan

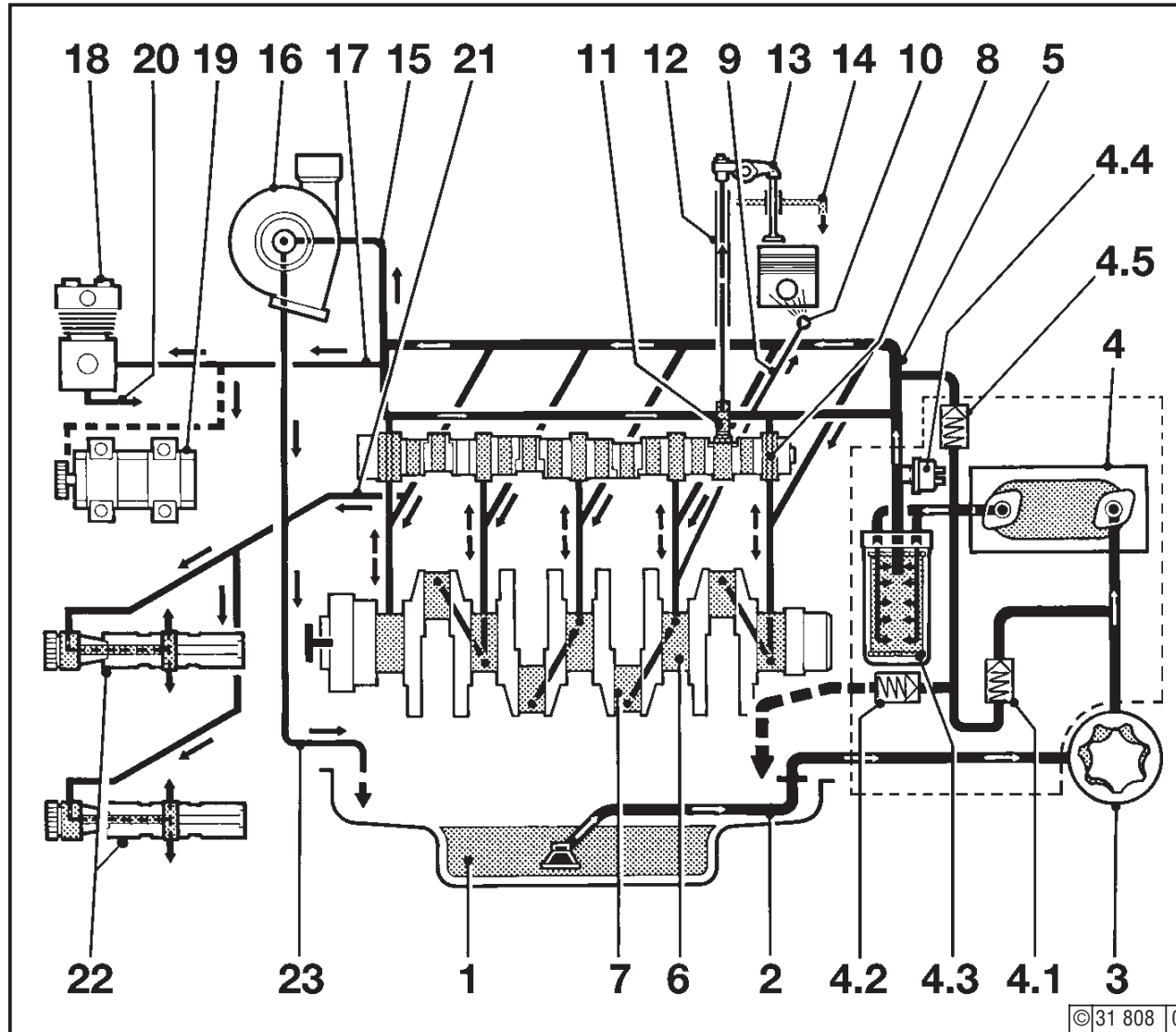

- 1 Oil pan
- 2 Intake line
- 3 Lube oil pump
- 4 Lube oil cooler
 - 4.1 Heat exchanger bypass valve
 - 4.2 Shut-off valve
 - 4.3 Lube oil replacement filter
 - 4.4 Oil pressure sensor
- 5 Main oil pipe
- 6 Crankshaft bearing
- 7 Con-rod bearing
- 8 Camshaft bearing
- 9 Line to spray nozzle
- 10 Spray nozzle for piston cooling
- 11 Valve lifter with rocker arm impulse lubrication
- 12 Stop rod, oil supply for rocker arm lubrication
- 13 Rocker arm
- 14 Return line to oil pan
- 15 Oil line to turbocharger
- 16 Turbocharger
- 17 Oil line to compressor or hydraulic pump
- 18 Compressor
- 19 Hydraulic pump
- 20 Return line from compressor or hydraulic pump
- 21 Line to the differential (2x)
- 22 Balancer shafts
- 23 Turbocharger return to crankcase

2.4.1 Fuel System Plan

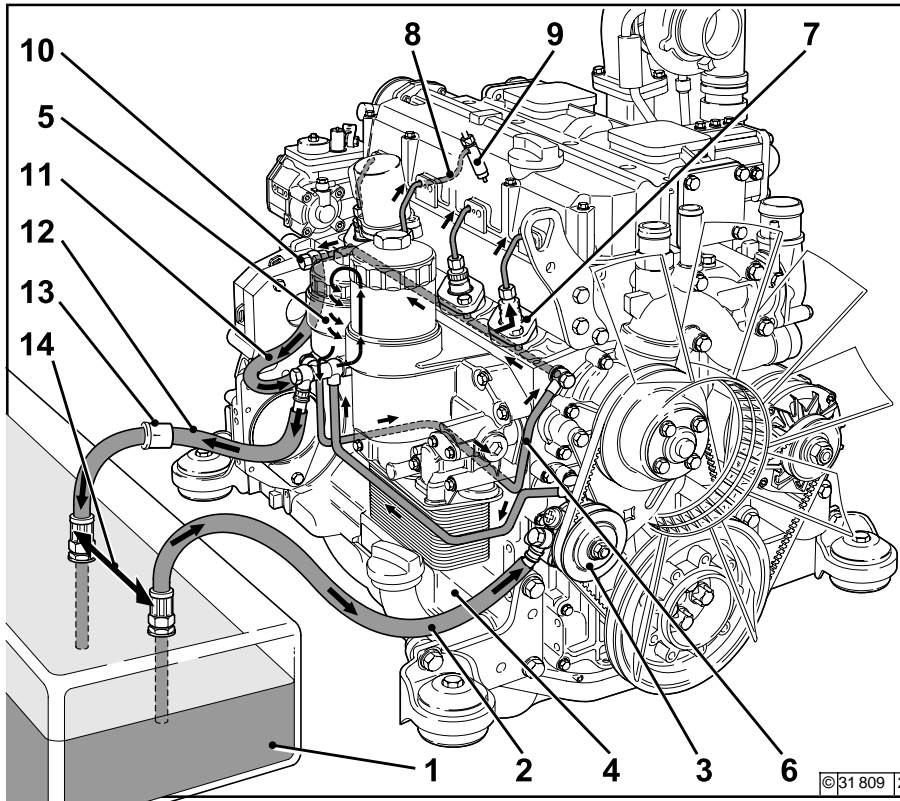

- 1 Fuel tank
- 2 Line to fuel pump
- 3 Fuel pump
- 4 Line to fuel filter
- 5 Fuel filter
- 6 Line to the injection pumps
- 7 Injection pump
- 8 Line to injection valve
- 9 Injection valve
- 10 Banjo bolt with pressure maintenance valve
- 11 Return line to fuel filter housing from pressure maintenance valve (with cup filter installation only)
- 12 Return line to fuel tank
- 13 Fuel check valve
- 14 Maintain maximum possible distance



For the protection of the engines, by dirt in the fuel, an installation is compellingly prescribed by fuel prescreeners hand pump, between fuel tank and engine.

2.5.1 Coolant block diagram 2012 Example: With cup filter

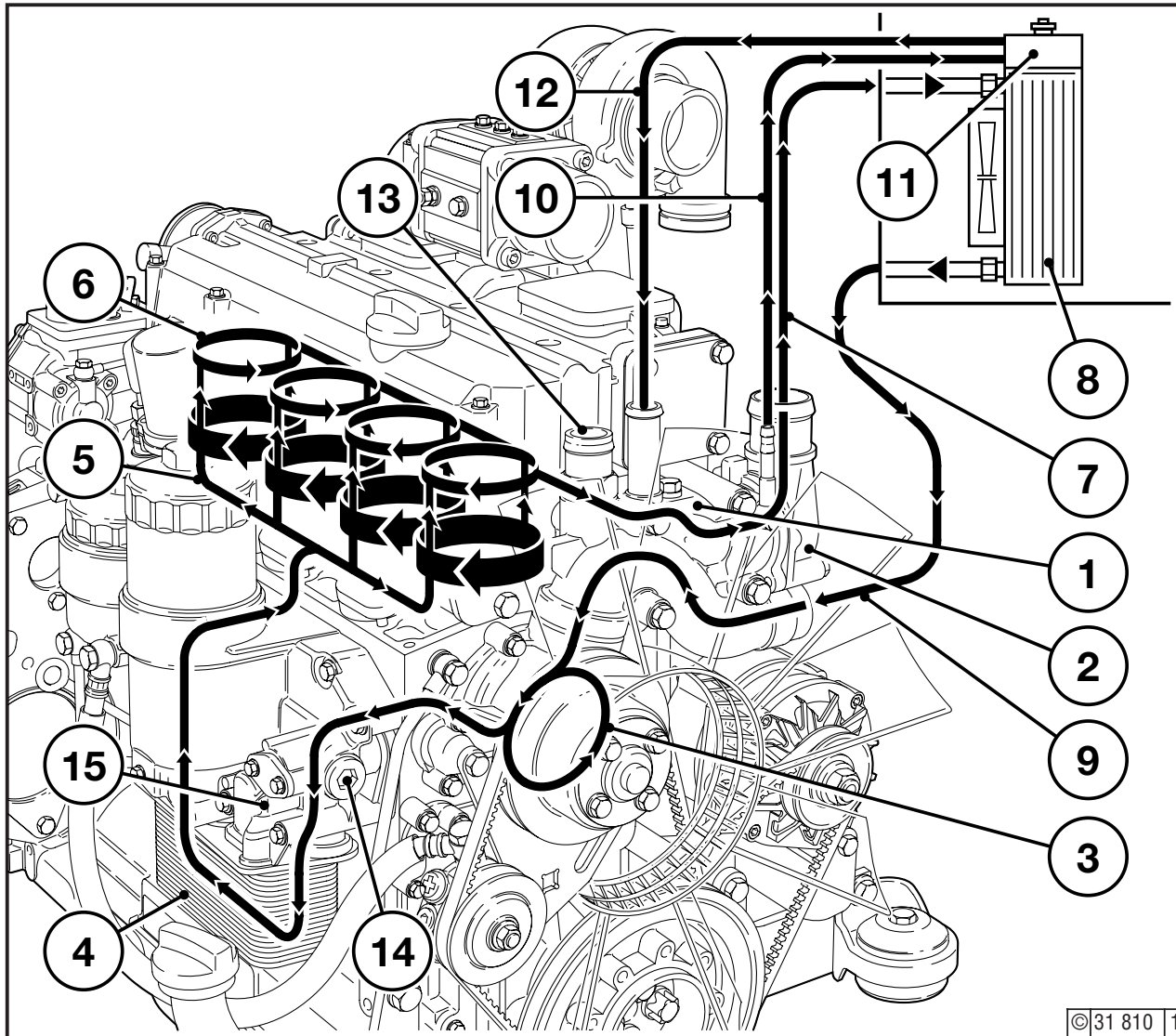

1. Thermostat housing
2. Outlet neck cover
3. Coolant pump
4. Lube oil cooler
5. Cylinder cooling
6. Cylinder head cooling
7. Line from engine to heat exchanger
8. Heat exchanger
9. Line from heat exchanger to thermostat
10. Ventilation line to the compensation tank
11. Compensation tank
12. Coolant compensation line
13. Coolant return from heater
14. Coolant supply to heating at V-belts
15. Coolant supply to heating at ribbed V-belts

- 3.1 Commissioning**
- 3.2 Starting**
- 3.3 Monitoring Operation**
- 3.4 Shutting off**
- 3.5 Operating Conditions**

3.1.1 Pour in Engine Oil

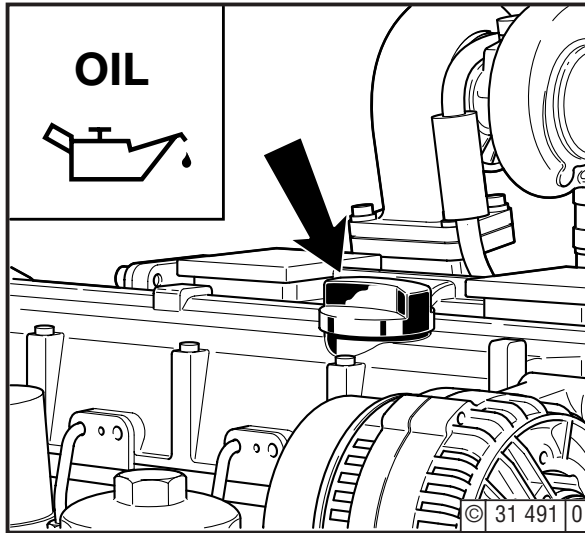

As a rule, engines are delivered without oil. Pour lube oil into the oil filler neck (arrow). Oil capacity, see 9.1. For oil grade and viscosity, see 4.1.

3.1.2 Oil Bath Air Filter with Engine Oil

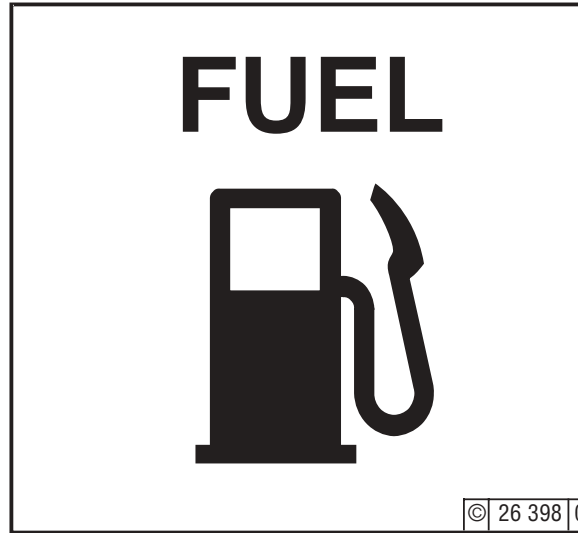

Fill oil cup 1 of the oil bath air cleaner (if installed) with oil up to the arrow. For oil grade and viscosity, see 4.1.



Never fill the fuel tank while the engine is running. Ensure cleanliness! Do not spill fuel!

3.1.3 Fill / Bleed Cooling System

- 2012: In accordance with the radiator supplier's specifications
- Unit engine: In accordance with the radiator supplier's specifications

3.1.4 Other Preparations

- Check battery and cable connections, see 6.7.1.

- **Trial run**

- After the engine has been prepared, carry out a brief trial run for approx. 10 minutes, without load if possible.

- During and after the trial run**

- Check the engine for leaks.

- After the engine has been turned off**

- Check oil level and top up if necessary, see 6.1.2.
 - Retension V-belts, see 6.5.

- **Breaking in**

- During the break-in phase - about 200 operating hours - check the oil level twice a day. After the engine is broken in, checking once a day will be sufficient.

- **In the event of commissioning engines which have been preserved**

- Carry out removal of preservation in accordance with Chapter 8.1.

3.2.1 Electric Starting



Before starting, make sure that nobody is standing in the immediate vicinity of the engine or driven machine.

After repair work:

Check that all guards have been replaced and that all tools have been removed from the engine.

When starting with glow plugs, do not use any other starter substance (e.g. injection with start pilot). Risk of accident!

Caution: If the speed regulator has been removed, the engine must not be started under any circumstances.

Disconnect the battery!

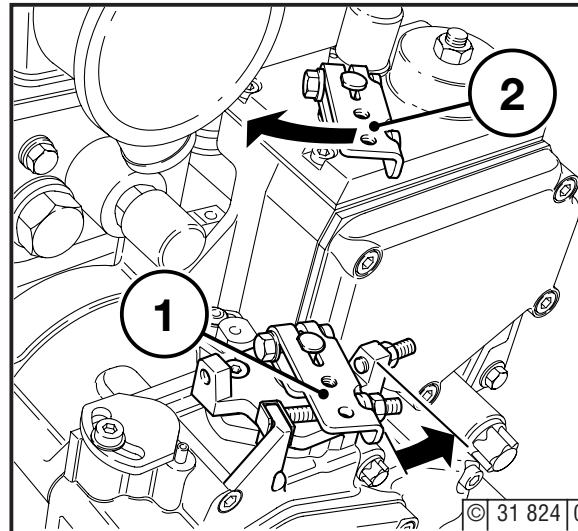

- Disengage the clutch to separate the engine from any driven parts.
- Bring speed adjustment lever 1 into at least the middle speed position in the direction of the arrow.
- Move cut-out handle 2 into operating position counter to the direction of the arrow.

without cold start assistance

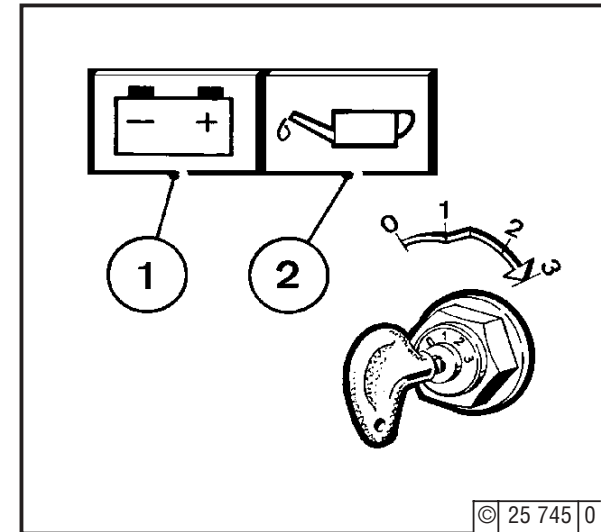

- Insert key
 - Position 0 = no operating voltage.
- Turn key clockwise
 - Position 1 = operating voltage
 - Pilot lights 1 and 2 illuminate.
- Push key in and turn further clockwise against spring pressure.
 - Position 2 = no function
 - Position 3 = start
- Release key as soon as engine fires
 - The pilot lights will go out.

Do not actuate the starter for more than 20 seconds. If the engine does not catch, wait for one minute then try again.

If the engine does not catch after two attempts, refer to the Fault Table (see 7.1).

3.2 Starting

with cold start assistance
Heater flange

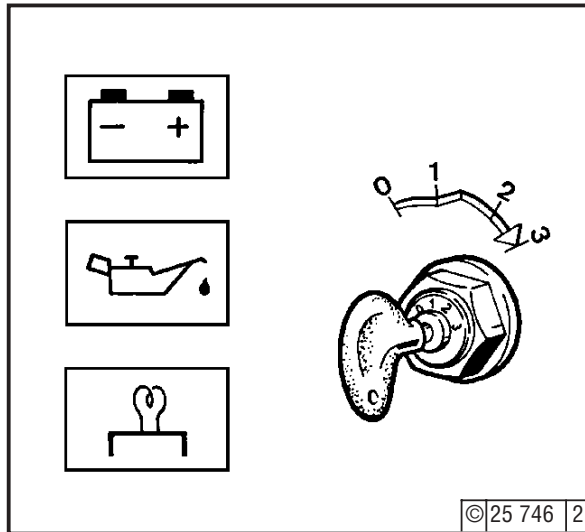

- Insert key
 - Position 0 = no operating voltage.
- Turn key clockwise
 - Position 1 = operating voltage.
 - Pilot lights illuminate, pre-glowing until glow indicator is extinguished.
- Push key in and turn further clockwise against spring pressure.
 - Position 2 = no function
 - Position 3 = start
- Release key as soon as engine fires.
 - The pilot lights will go out.

3.3.1 Engine Oil Pressure

Oil pressure lamp

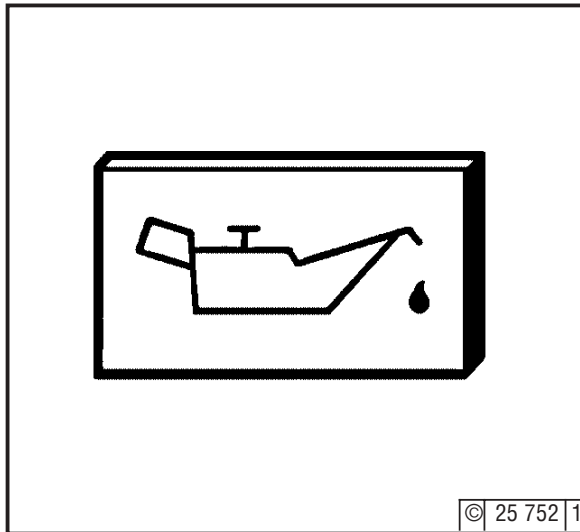

- The oil pressure pilot light comes on with operating voltage on and engine off.
- The oil pressure pilot light must be extinguished when the engine is running.

Oil Pressure Indicator

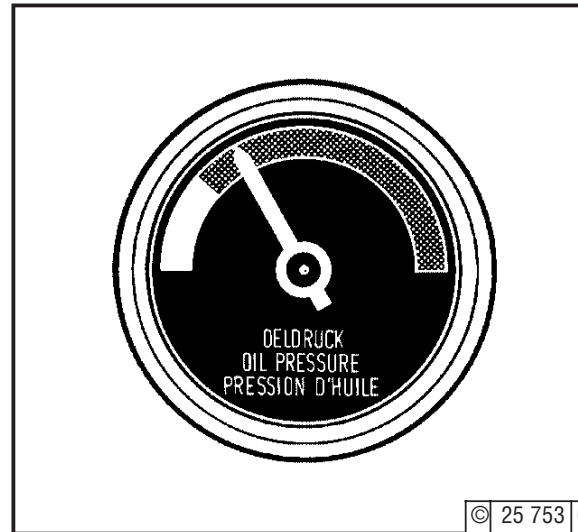

- The pointer must remain in the green sector over the entire operating range.

Oil Pressure Gauge

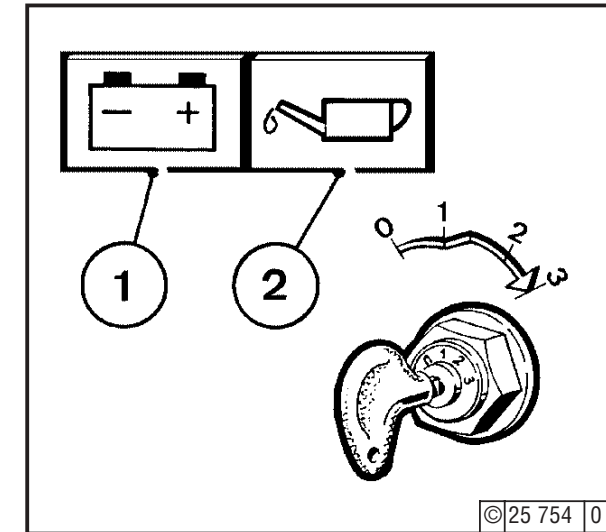

- The pointer of the oil pressure gauge must display the minimum oil pressure (see 9.1)

3.3.2 Coolant temperature

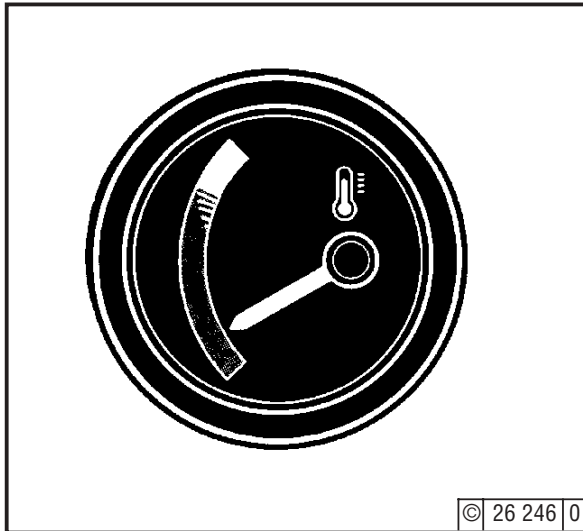

- The engine temperature gauge pointer should always remain in the green sector. It should rarely enter the yellow-green sector. If the pointer enters the orange sector, the engine is overheating. Turn off and establish the cause from the Fault Table (see 7.1).

3.4.1 Mechanical Stopping

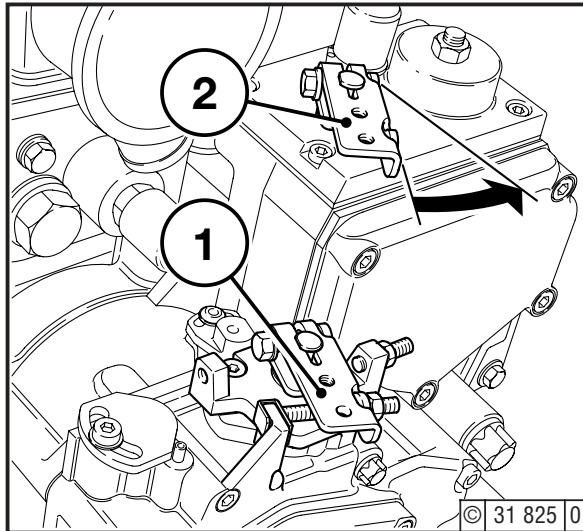

- Move speed adjustment lever 1 to low idle.
- Move shut-off lever 2 until the engine comes to a stop. The charge pilot light and the oil pressure pilot light illuminate when the engine stops.
- Turn key counterclockwise (to position 0) and remove. The pilot lights will go out.

3.4.2 Electrical Stopping

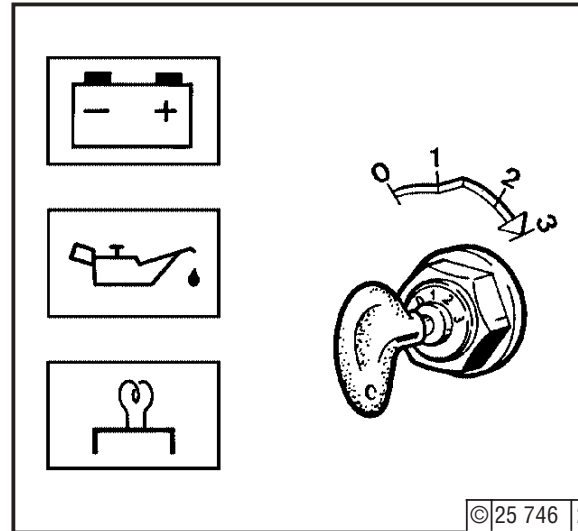

- Turn key counterclockwise (to position 0) and remove. The pilot lights will go out.

3.5.1 Winter Operation

- Lube Oil Viscosity
 - Select the oil viscosity (SAE grade) according to the ambient temperature before starting the engine, see 4.1.2.
 - Increase oil change frequency when operating below $-10\text{ }^{\circ}\text{C}$, see 6.1.1.
- Diesel Fuel
 - Use winter-grade diesel fuel for operation below $0\text{ }^{\circ}\text{C}$, see 4.2.2.
- Coolant
 - Mixture ratio of anti-freeze / water for minimum temperature (max. $-35\text{ }^{\circ}\text{C}$), see 4.3.1.
- Additional Maintenance Work
 - Drain the sludge from the fuel tank once a week (undo the sludge drain screw).
 - If necessary, adjust oilbath filter oil level, like the engine oil, to the ambient temperature.
 - Below $-20\text{ }^{\circ}\text{C}$, after removing the starter if necessary, smear the ring gear on the fly-wheel via the pinion bore from time to time with cold-resistant grease. (e.g. Bosch grease FT 1 V 31).
- Cold Start Assistance
 - The heater flange is automatically initialised at temperatures $< -25\text{ }^{\circ}\text{C}$.

- Battery
 - Efficient cold starting necessitates that the battery is well-charged, see 6.7.1.
 - The starting limit temperatures can be lowered by $4\text{--}5\text{ }^{\circ}\text{C}$ by heating the battery up to about $20\text{ }^{\circ}\text{C}$. (To do so, remove the battery and store in a warm place).

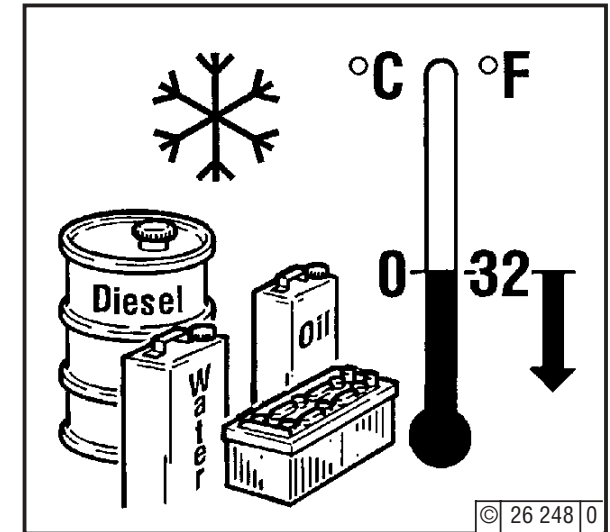

3.5.2 High Ambient Temperature High Altitude

- Air density decreases as altitude or ambient temperature increase.
As a result of this, the engine's maximum output, the quality of the exhaust gas, the temperature level and, in extreme cases, starting behaviour, are impeded.
In the event of non-stationary operation, use up to altitudes of 1000 m and temperatures of 30 °C is permissible.
If the engine is to operate under unfavourable conditions (at higher altitudes or temperatures), it will be necessary to reduce the injected fuel quantity and thus, engine power.
- If you have any doubts about engine operation under these or similar conditions, ask your engine or equipment supplier whether the engine has been derated in the interests of reliability, service life and exhaust gas quality (smoke!). Otherwise contact your service representative.

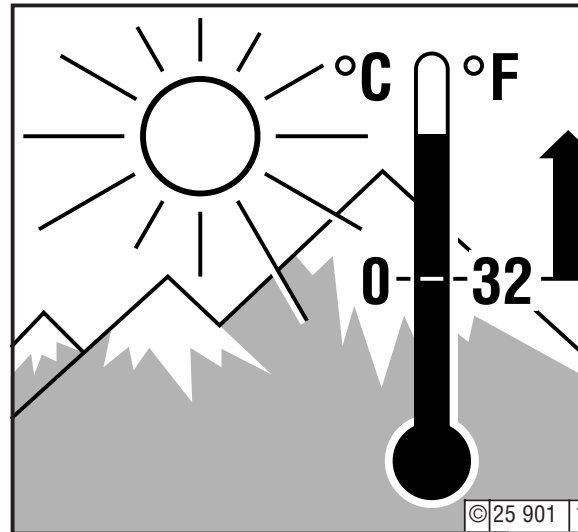

- 4.1 Lube Oil
- 4.2 Fuel
- 4.3 Coolant

4.1.1 Quality Grade

Lube oils are differentiated by **Deutz** according to their performance and quality class. Oils of other, comparable specifications can be used.

Approved oils:			
Deutz	DQC I	DQC II	DQC III
ACEA	E2-96	E3/96/E5-02	E4-99
API	CF/CF-4	CH-4/CG-4	-
DHD	-	DHD-1	-

The precise assignment of the admissible oil qualities to the engines is indicated in chapter 6.1.1. If in doubt, contact your service representative.

4.1.2 Viscosity

Generally, multi-grade oils shall be used. In closed heated rooms at temperatures $>5^{\circ}\text{C}$, also single-grade oils can be used.

As the viscosity of lube oil is dependent on temperature, the choice of SAE grade should be governed by the ambient temperature prevailing at the engine operating site. Optimum operating behaviour will be attained if you take the accompanying oil viscosity diagram as a guide.

Should the temperature fall temporarily below the limits of the SAE grade selected, cold starting may be affected but the engine will not be damaged.

In order to keep wear to a minimum, do not exceed application limits for extended periods of time.

Synthetic lube oils feature an improved temperature and oxidation stability.

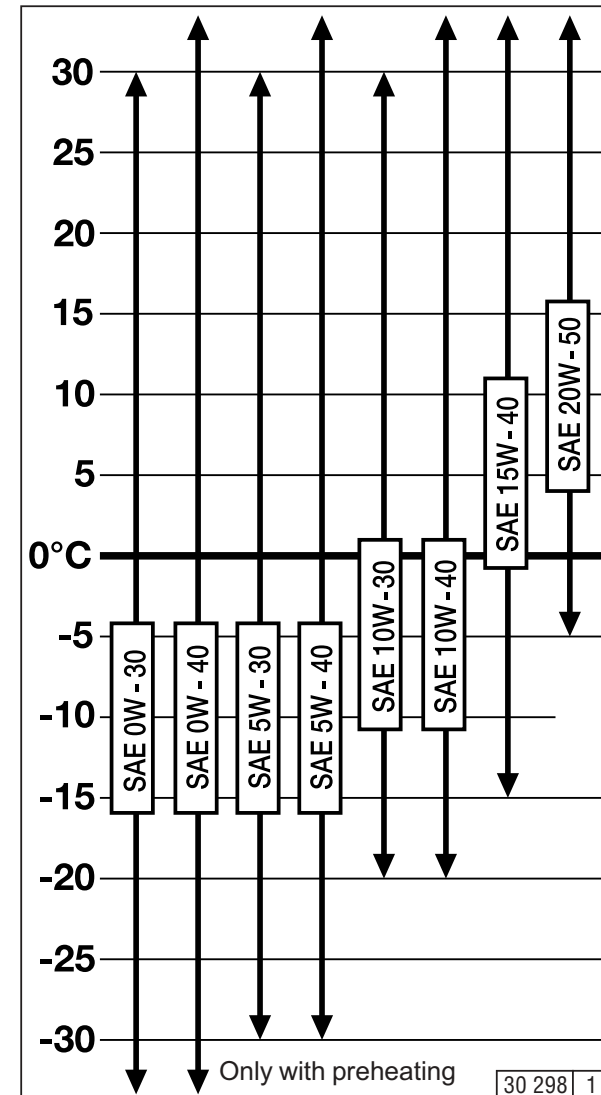

4.1.2.1 Specific lube oil definitions

Turbocharged engines with uprated power and engines with high loading

The oils listed in enclosure 1 are to be used for the following engines and applications:

COM/EPA II version and increased output

BF4M 2012/C > 95 kW

BF6M 2012/C > 143 kW (bore 101 + 98-MVS)

BF6M 2012/C > 135 kW (bore 98 mech. FIE)

- all engines in CHP plants
- all engines in gensets operating in parallel with the mains/with each other
- engines in combines with:

These are high-grade oils according to ACEA or API. In addition most of these oils are partly synthetic, some even fully synthetic (5W-40) and thus achieve the thermal stability required for the relevant application and are distinguished by a low tendency to cause deposits in the turbocharger and in the charge air pipes with closed-circuit crankcase breather

Lube oils for engines with uprated power and engines with high loading			
Producer	Type of lube oil	SAE class	Availability
DEUTZ	TXL-10W40 FE	10W-40	
AGIP	Agip Sigma Ultra TFE	10W-40	worldwide
AGIP	Autol Valve Ultra FE	10W-40	Germany
ARAL GmbH	Aral MegaTurboral	10W-40	worldwide
ARAL GmbH	Aral SuperTurboral	5W-30	worldwide
BAYWA	BayWa Super Truck 1040 MC	10W-40	South Gemany
BAYWA	BayWa Turbo 4000	10W-40	South Gemany
Castrol GmbH	Castrol SYNTRUCK	5W-40	Europe, North America, Brazil Argentina, Australia, South Africa
Castrol GmbH	Castrol DYNAMAX	7,5W-40	Europe, North America, Brazil Argentina, Australia, South Africa
CHEVRON	Chevron Delo 400 Synthtic	5W-40	North America
ESSO	Essolube XTS 501	10W-40	Europe
FINA	FINA KAPPA FIRST	5W-30	Europe
FINA	FINA KAPPA ULTRA	10W-40	Europe
FUCHS DEA	DEA Cronos Synth	5W-40	Germany, Europe
FUCHS DEA	DEA Cronos Premium LD	10W-40	Germany, Europe
FUCHS DEA	Fuchs Titan Cargo MC	10W-40	worldwide
FUCHS DEA	Deutz Oel TLL 10W-40 MB	10W-40	Germany
FUCHS DEA	DEA Cronos Premium FX	10W-40	Europe
FUCHS DEA	Fuchs Titan Unic Plus MC	10W-40	worldwide
MOBIL OIL	Mobil Delvac 1 SHC	5W-40	Europe, SE Asia, Africa
MOBIL OIL	Mobil Delvac 1	5W-40	worldwide
MOBIL OIL	Mobil Delvac XHP Extra	10W-40	Europe, SE Asia
BP OIL International	BP Vanellus HT Extra	10W-40	Europe
Shell International	Shell Myrina TX /	5W-30	Europe, different
	Shell Rimula Ultra		description in some countries
Shell International	Shell Myrina TX /	10W-40	Europe, different
	Shell Rimula Ultra		description in some countries
TOTAL	TOTAL RUBIA TIR 86000	10W-40	worldwide
Schmierölr Raffinerie Salzbergen GmbH	Wintershall TFG	10W-40	Europe

The table will be extended as and when required.

4.2.1 Quality

Use commercially available diesel fuel with less than 0.5 % sulphur content. If the sulphur content is higher, oil change intervals should be reduced (see 6.1.1).

The following fuel specifications / standards are approved:

- DIN EN 590
- BS 2869: A1 and A2 (with A2, take note of the sulphur content!)
- ASTM D 975-88; 1-D and 2-D
- NATO Code F-54 and F-75

Exhaust emission values which may be determined in the case of type approval tests always refer to the reference fuel prescribed by the authorities for the type approval test.

4.2.2 Winter Fuel

Waxing may occur at low temperatures, clogging the fuel system and reducing engine efficiency. Use winter-grade diesel fuel (up to -20°C) for operation below 0°C . This is made available within good time by filling stations prior to the start of the winter season.

- Kerosene must be added at temperatures below -20°C . The relevant percentages are given in the adjacent diagram.
- Special diesel fuels may be used in arctic climatic zones up to -44°C .

If summer-grade diesel fuel must be used at temperatures below 0°C , up to 60% kerosene can be added (see diagram).

In most cases, adequate resistance to cold can be obtained by adding a flow improver (additive). Please ask your DEUTZ partner.

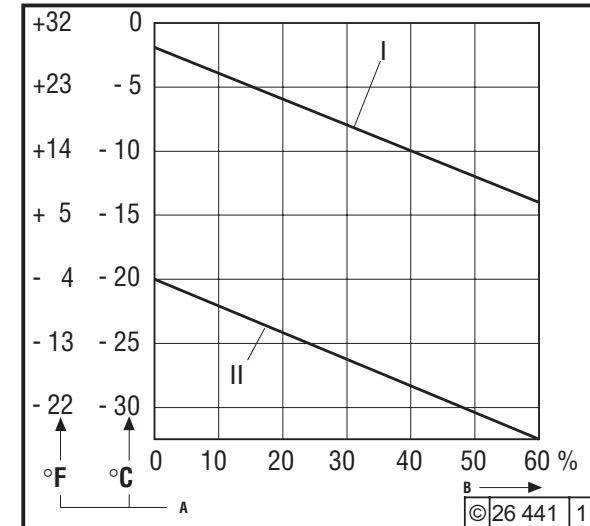

Legend:	
I	Summer-grade diesel fuel
II	Winter-grade diesel fuel
A	Ambient temperature
B	Percentage of kerosen added



Diesel fuels must never be mixed with gasoline (Normal and Super grades)!



Mix in tank only! Fill with the appropriate amount of kerosene first, then add the diesel fuel.

4.3 Coolant

Operating Media

4.3.1 Quality of Water for Coolant

The values listed below must not be exceeded. In order to examine the quality of your water, a test case can be ordered from DEUTZ under Order No. 12130382.

Water quality	min.	max.
pH value at 20 °C	6.5	8.5
Chloride ion content [mg / dm ³]	-	100
Sulphate ion content [mg / dm ³]	-	100
Total hardness [°dGH]	3	20

4.3.2 Coolant Treatment

In the case of liquid-cooled engines, special attention must be paid to the treatment and control of the coolant, as the engine may otherwise become damaged as a result of corrosion, cavitation and freezing.

The treatment of the coolant is carried out by adding a cooling system protectant to the cooling water.

The cooling system must be continuously monitored, see 5.1. In addition to checking the coolant level, this also involves checking the concentration of the cooling system protectant. The cooling system protectant concentration can be checked with commercially available testers (example: gefo glycomat ®).

4.3.3 Cooling System Protectants

DEUTZ cooling system protectant must be purchased in drums under Order No. 01011490 (5 litres) or 1221 1500 (210 litres). These are nitrite, amine and phosphate-free, and provide effective protection against corrosion, cavitation and freezing.

If the above mentioned cooling system protectant is unavailable, the following products may be used in exceptional cases.

Manufacturer	Product designation
AVIA	AVIA Antifreeze Extra
ARAL	Antifreeze Extra
BASF	Glysantin G 48
DEA	DEA Radiator Antifreeze
SHELL	SHELL GlycoShell

The cooling system protectant in the coolant should not fall below or exceed the following concentration:

Cooling system protectant	Water
max. 45 Vol. %	55%
min. 35 Vol. %	65%

Filling volume, see chart over page in combination with specifications in Chapter 9.1.

The use of other cooling system protectants, e.g. chemical anti-corrosion agents, is possible in exceptional cases. Consult DEUTZ Service.



If nitrite-based cooling system protectants are mixed with amine-based agents, dangerous nitrosamines are formed.



Cooling system protectants must be disposed of in an environmentally-friendly manner.

Cooling system protection									
Cooling system protection in	Frost protection in [°C]	content of coolant system *) [Litres]							
		18	20	22	25	27	30	32	35
		Cooling system protectant							
35	-22	6,3	7,0	7,7	8,75	9,5	10,5	11,2	12,3
40	-28	7,2	8,0	8,8	10	10,8	12	12,8	14
45	-35	8,1	9,0	9,9	11,3	12,2	13,5	14,4	15,8
50	-45	9,0	10	11	12,5	13,5	15	16	17,5

*) For coolant content of your engine, see Operation Manual Chapter 9.1.
 Note: Grey sector only after consulting head office

- 5.1 Maintenance Schedule**
- 5.2 Maintenance Chart**
- 5.3 Maintenance Work Completed**

Routine Maintenance

5.1 Maintenance Schedule

5

check= ● adjust= ○ clean= ▲ replace= ■									<h3>Industrial engines</h3> <p>The specified engine maintenance values are permissible recommended maximums. Depending on usage, reduced maintenance intervals may be necessary, comply with the unit manufacturer's operating instructions. # Maintenance must only be carried out by authorised service personnel</p>	Section
∴ prior to or during 1st trial run, check 2x daily during the breaking in phase or when commissioning new and overhauled engines										
∴ every 10 hours of operation or daily										
Operating hours (OP) every					Years		Operation			
250	500	1000	1500	12000	1	2				
●	●							Top lube oil up if necessary	6.1.2/3.3.4	
		■						Lube oil (oil change intervals depending on engine use), see TR 0199-99-3002	6.1.1/ 6.1.2	
		■						Oil filter cartridge (at each lube oil change)	6.1.3	
			■					Fuel filter cartridge	6.2.1	
			●				■	Flexible fuel leak oil lines (replace completely)		
					■			Injection valve	#	
●			▲			■		Fuel pre-cleaner/ filter element (cleaning or replace if necessary)	4.2/ 5.2	
●		●					■	Coolant (additive concentration)	4.3.1/ 2/ 3	
					■			Coolant pump	#	
●	●							Coolant level	–	
●	●		■					Intake air cleaner (If available, maintain according to maintenance indicator)	6.4.3 /6.4.4	
●			●			▲		Intercooler (drain lube oil/condensation)		
			●					Battery and cable connectors	6.7.1	
●			●					Engine monitoring system, warning system	3.3 #	
					○			Valve clearance	6.6.1#	
●			●				■	V-belts (retension or replace if necessary)	6.5.1	

* When the warning system responds (lamp/horn), the fuel pre-filter must be emptied immediately

5.1 Maintenance Schedule

Routine Maintenance

check= ● adjust= ○ clean= ▲ replace= ■										<h3>Industrial engines</h3> <p>The specified engine maintenance values are permissible recommended maximums. Depending on usage, reduced maintenance intervals may be necessary, comply with the unit manufacturer's operating instructions. # Maintenance must only be carried out by authorised service personnel</p>	Section
prior to or during 1st trial run, check 2x daily during the breaking in phase or when commissioning new and overhauled engines											
every 10 hours of operation or daily											
In hours of operation (HO) every							Years		Operation		
250	500	1000	1500	12000	1	2					
●	●									Check engine for leaks (visual inspection)	-
●				●						Engine suspension (replace if damaged)	9.2
●				●						Fastenings, hose connections / clamps	-
						■				Basic overhaul	#

Page 2 of 2

check= ● adjust= ○ clean= ▲ replace= ■										<h3>Additions and modifications for engines with EPA approval</h3> <p>The specified engine maintenance values are permissible recommended maximums. Depending on usage, reduced maintenance intervals may be necessary, comply with the unit manufacturer's operating instructions. # Maintenance must only be carried out by authorised service personnel</p>	Section
Max. permissible reference times in operating hours (HO) every											
prior to or during 1st trial run, check 2x daily during the breaking in phase or when commissioning new and overhauled engines											
every 10 hours of operation or daily											
In hours of operation (HO) every							Years		Operation		
250	500	1000	3000	6000	12000	1	2				
				■						Injection valve	#

Routine Maintenance

5.2 Maintenance Chart

5

The maintenance chart shown on this page is supplied as a self-adhesive label with each engine. It should be affixed where it can be seen clearly on the engine or driven equipment.

Check that this is the case.

If necessary, ask your engine or equipment supplier for a fresh supply of labels.

Routine work should be carried out according to the schedule in 5.1.

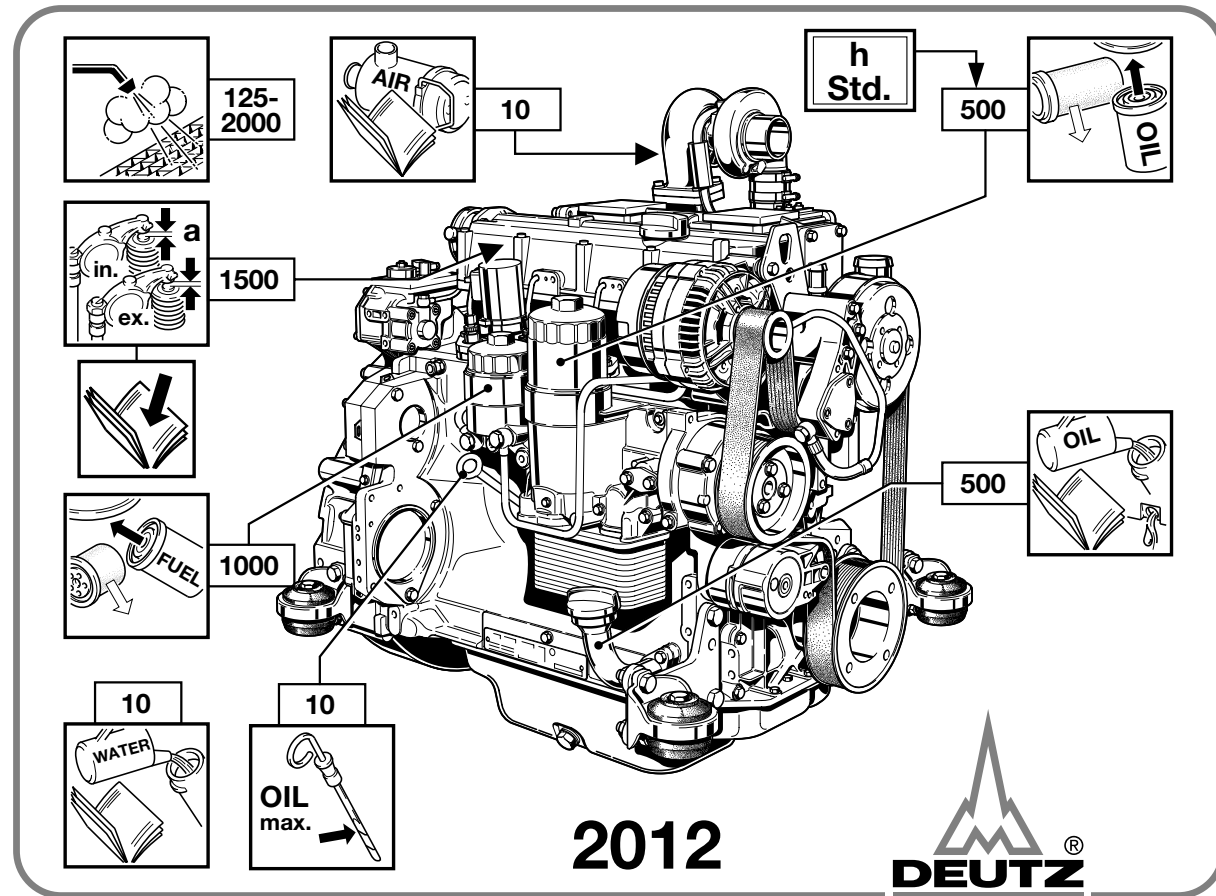

0297 9901 1

© 2003



Stop the engine before carrying out any maintenance work.

5.2 Maintenance Chart

Routine Maintenance

The maintenance chart shown on this page is supplied as a self-adhesive label with each engine. It should be affixed where it can be seen clearly on the engine or driven equipment. Check that this is the case. If necessary, ask your engine or equipment supplier for a fresh supply of labels. Routine work should be carried out according to the schedule in 5.1.

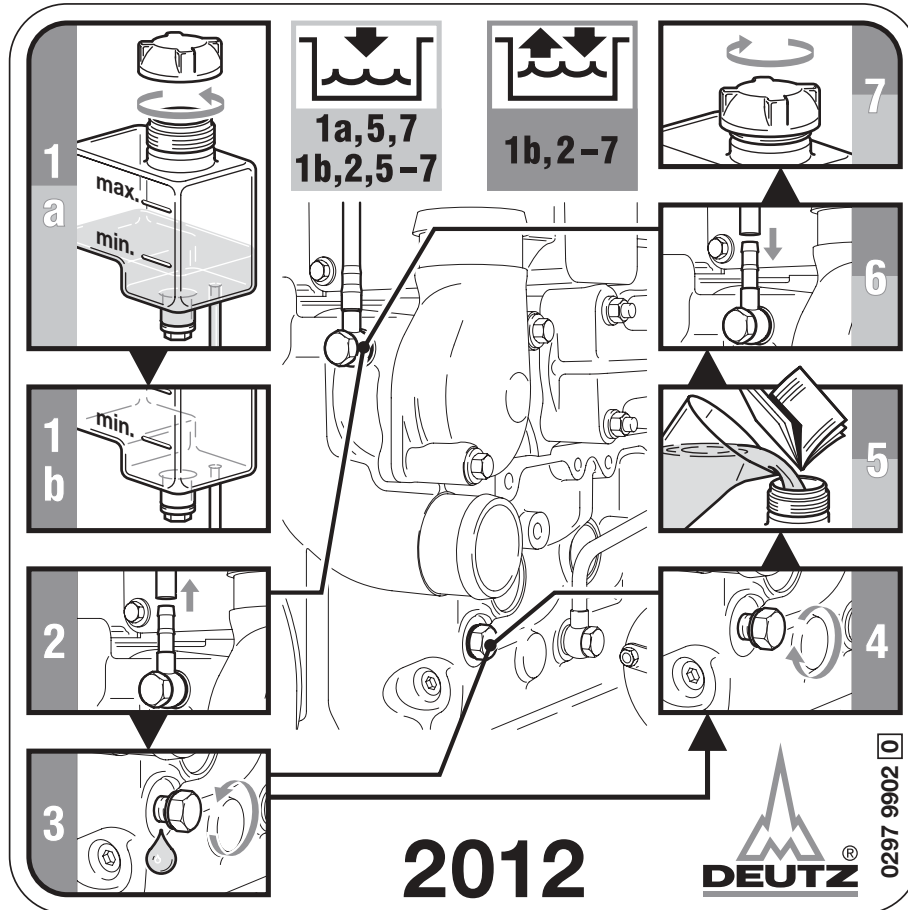

Kraftstoff-Vorfilter **Wartung**
Fuel prefilter **Maintenance**
Préfiltre combust. **Entretien**
Prefiltro combust. **Mantenimiento**

0490 0060

1 **STOP** **2** **3** **4** **5** **6**

* Filterelement mindestens jährlich wechseln!
 Change filter element at least once a year!
 Remplacer l'élément filtrant au moins une fois par an!
 Cambiar el elemento filtrante, por lo menos, una vez al año.

Wasser nach Aufleuchten der Kontrollleuchte ablassen.
 Drain water when pilot lamp lights up.
 Vidanger l'eau lorsque la lampe témoin s'allume.
 Evacuar el agua al encenderse la luz testigo.

We move your world.
 www.deutz.de

DEUTZ

© 2003

Routine Maintenance

5.3 Maintenance Work Completed

5

Op. hours	Date	Signature/stamp	Op. hours	Date	Signature/stamp
50-150*			-		
125			250		
375			500		
625			750		
875			1000		
1125			1250		
1375			1500		
1625			1750		
1875			2000		
2115			2250		
2375			2500		
2625			2750		

* following commissioning of new and overhauled engines.
Duly completed maintenance jobs can be recorded and signed off in the above chart.

5.3 Maintenance Work Completed

Routine Maintenance

Op. hours	Date	Signature/stamp	Op. hours	Date	Signature/stamp
2875			3000		
3125			3250		
3375			3500		
3625			3750		
3875			4000		
4125			4250		
4375			4500		
4625			4750		
4875			5000		
5125			5250		
5375			5500		
5625			5750		

Duly completed maintenance jobs can be recorded and signed off in the above chart.

Routine Maintenance

5.3 Maintenance Work Completed

5

Op. hours	Date	Signature/stamp	Op. hours	Date	Signature/stamp
5875			6000		
6125			6250		
6375			6500		
6625			6750		
6875			7000		
7125			7250		
7375			7500		
7625			7750		
7825			8000		
8125			8250		
8375			8500		
8625			8750		

Duly completed maintenance jobs can be recorded and signed off in the above chart.

5.3 Maintenance Work Completed

Routine Maintenance

Op. hours	Date	Signature/stamp	Op. hours	Date	Signature/stamp
8875			9000		
9125			9250		
9375			9500		
9625			9750		
9875			10000		
10125			10250		
10375			10500		
10625			10750		
10825			11000		
11125			11250		
11375			11500		
11625			11750		

Duly completed maintenance jobs can be recorded and signed off in the above chart.

Routine Maintenance

5.3 Maintenance Work Completed

5

Op. hours	Date	Signature/stamp	Op. hours	Date	Signature/stamp

6.1 Lubrication System

6.2 Fuel System

6.3 Cooling System

6.4 Combustion Air Filter

6.5 Belt Drives

6.6 Adjustments

6.7 Accessories

6.1.1 Oil Change Intervals

- The lube oil is changed for the first time 50-150 hours of operation following commissioning or recommissioning or following repairs
- The lube oil change intervals are dependent on:
 - Lube oil quality
 - Fuel sulphur content
 - The engine application
- If the oil change times are not achieved within a year, the oil must be changed at least once a year.
- The table refers to the following conditions:
 - For diesel fuel: Sulphur content max. 0.5% by weight.
 - Continuous ambient temperature down to -10 °C (+14 °F).
- In the case of fuels
 - with > 0.5 to 1 % sulphur content
 - or
 - Continuous ambient temperatures down to -10 °C (+14 °F)
 - or
 - with biological diesel fuels to DIN 51606-FAME, the oil change intervals must be halved.
- In the case of fuels with a sulphur content higher than 1%, ask the relevant **Service** representative.

Change the oil with the engine off but still warm (lube oil temperature approx. 80 °C).

6.1.1.1 Lube oil change intervals for industrial and marine engines

	Lube oil grade			
	Deutz lube oil quality class	DQC I	DQC II	DQC III
	ACEA-specification	E2-96	E3-96/E5-02	E4-99
	API-specification	CF/CF-4	CG-4/CH-4	-
	Worldwide specification	-	DHD-1	-
	special DEUTZ release list	-	-	Enclosure 1
Standard lube oil code for building equipment and nonroad vehicles	EO... EO...A, EO...B	EO...C	-	
Engine series	Engine version	Lube oil change intervals in op. hours		
		Oil use normal high	Oil use normal high	Oil use normal high
2012	All engines except for:	250	500	500
	BF4M2012C P > 95 kW	-	-	500
	BF6M2012C P > 143 kW, from nonroad stage II at cylinder bore 101 mm or 98 mm with MV system	-	-	500
	BF6M2012C P > 135 kW, from nonroad stage II at cylinder bore 98 mm with mech. injection system	-	-	500
	Other engines from nonroad stage II	-	500	500
	eng. in harv. machines, block-tyepthermal power stat., gensets*	-	-	500

*Gensets as referred to here are units operating in parallel with the mains / with each other. Emergency power units are dealt with in TR 0199-99-1126.

6.1.1.2 Oil change intervals for vehicle engines

		Schmieröl-Qualität			
		Deutz lube oil quality class	DQC I	DQC II	DQC III
		ACEA specification	E2-96	E3-96/E5-02	E4-99
		API specification	CF/CF-4	CG-4/CH-4	-
		worldwide specification	-	DHD-1	-
special DEUTZ release	-	-	Enclosure 1		
Application	Engine version	Lube oil change intervals in km			
Site vehicles/ busses	25	2012 Euro I	10 000	15 000	20 000
		Euro II and Euro III, except for:	-	15 000	20 000
		BF4M2012C > 95 kW from Euro II	-	-	20 000
		BF6M2012C > 143 kW from Euro II at cylinder bore 101 mm with or 98 mm with MV system	-	-	20 000
		> 135 kW from Euro II at cylinder bore 98 mm with mechanical injection system	-	-	20 000
Local traffic	40	2012 Euro I	15 000	20 000	30 000
		Euro II and Euro III, except for:	-	20 000	30 000
		BF4M2012C > 95 kW from Euro II	-	-	30 000
		BF6M2012C > 143 kW from Euro II at cylinder bore 101 mm with or 98 mm with MV system	-	-	30 000
Long distance traffic	60	2012 Euro I	20 000	30 000	40 000
		Euro II and Euro III, except for:	-	30 000	40 000
		BF6M2012C > 143 kW from Euro II at cylinder bore 101 mm with or 98 mm with MV system	-	-	40 000
		> 135 kW from Euro II at cylinder bore 98 mm with mechanical injection system	-	-	40 000

If, for vehicle engines, lube oil change intervals are determined by operating hours, the lube oil change intervals indicated in table 4.1. for "Oil use under normal duty" will apply.

6.1.2 Check Oil Level / Change Engine Oil

6.1.2.1 Check Oil Level

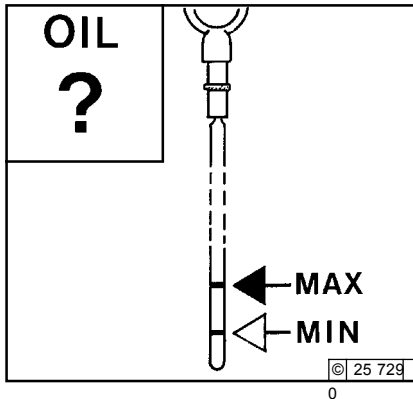

- Ensure that the engine or vehicle is in a level position.
- Engine warm:
Shut engine off, wait for 5 minutes and check oil level.
- Engine cold:
Check oil level.
- Remove the oil dipstick.
- Wipe the dipstick with a non-fibrous, clean cloth.
- Insert it to the stop and remove again.
- Check the oil level, and if necessary, top up to the "MAX" mark.
- If the oil level is only just above the "MIN" mark, more oil must be added.

The level must not fall below the "MIN" mark.

6.1.2.2 Engine Oil Change

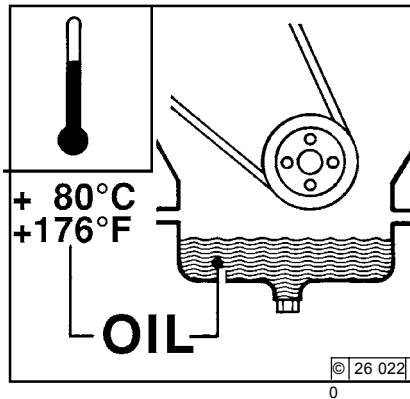

- Run engine until warm.
- Ensure that the engine or vehicle is in a level position.
- Lube oil temperature approx. 80 °C.
- Switch off the engine.

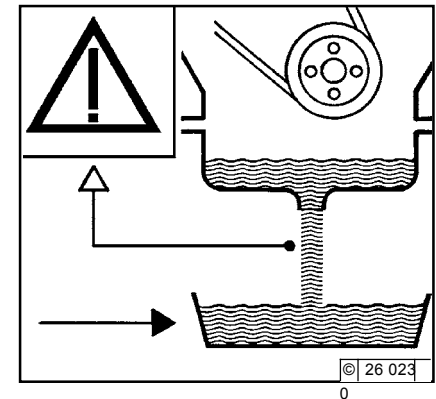

- Place oil tray under the engine.
- Unscrew oil drain screw.
- Drain oil.
- Screw oil drain screw in with new seal ring and tighten. (Tightening torque see 9.2).
- Pour in lube oil.
- For grade / viscosity, see 4.1
- For quantity, see 9.1.
- Check oil level, see 6.1.2.1.



Caution when draining hot oil: Risk of scalding!
Do not let used oil run into the soil but collect it in a container!
Dispose of this in accordance with environmental regulations!

6.1.3 Replace Oil Filter

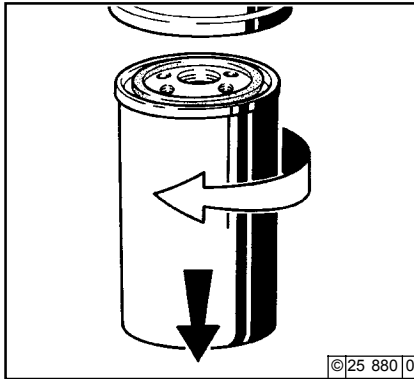

- With attached locking piston:
Undo tensioning screws and remove tensioning clamps downwards.
- Undo the lube oil filter cartridge using a commercial tool and spin off.
- Catch any escaping oil.

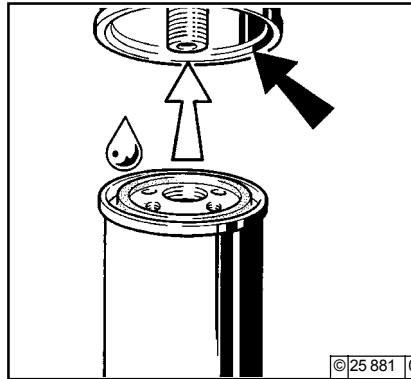

- Clean any dirt from the filter carrier sealing surface.
- Lightly oil the rubber gasket of the new lube oil filter cartridge.
- Manually screw in the new cartridge until the gasket is flush.

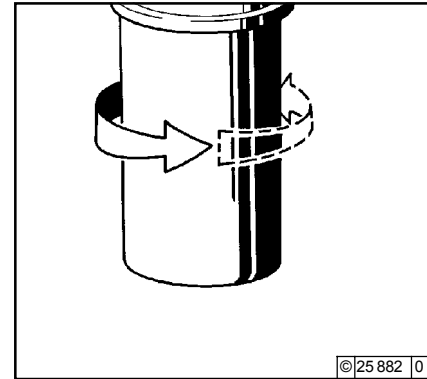

- Tighten the lube oil filter cartridge with another half-turn.
- If locking piston is available:
Position tensioning clamps and tighten with tensioning screws.
- Check oil level, see 6.1.2.
- Check oil pressure, see 3.3.1.
- Check lube oil filter cartridge seal for leaks.



6.1.4 Clean / Replace Oil Filter (Cup)

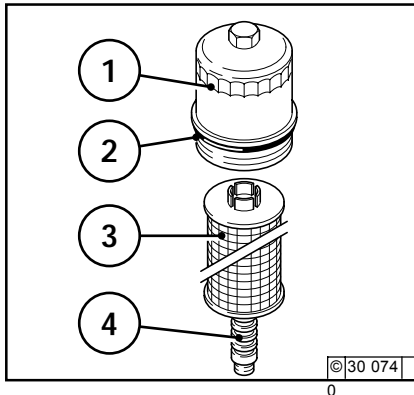

- Switch off the engine.
- Loosen lube oil filter cover 1 and unscrew in an anticlockwise direction, empties itself the system automatically (drain valve).
- Carefully loosen paper filter cartridge 3 upwards from the guide 4.
- Catch any escaping oil.
- Replace paper filter cartridge 3.
- Clean any dirt from the sealing surface of the filter carrier and lube oil filter cover 1 and from the guide 4.
- Replace and lightly oil the rubber gasket 2.
- Carefully insert new paper filter cartridge 3 into guide 4.
- Tighten lube oil filter cover 1 in a clockwise direction (25 Nm).
- Start engine.
- Check oil level, see 6.1.2.
- Check oil pressure, see 3.3.1.
- Check lube oil filter attachment for leaks.



Caution is required in the case of hot oil:
Risk of scalding!

6.2.1 Replace Fuel Filter

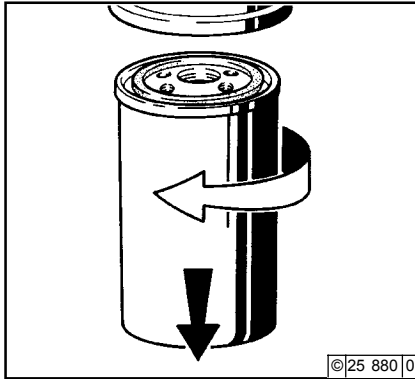

- Close the fuel shut-off valve.
- Undo fuel filter cartridge with commercial tool and spin off.
- Catch any escaping fuel.
- Clean any dirt from the filter carrier sealing surface.

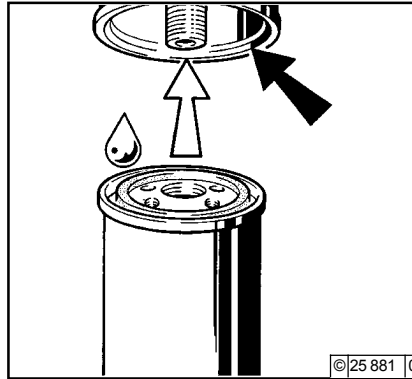

- Apply light film of oil or diesel fuel to the rubber gasket of the new fuel filter cartridge.
- Manually screw in the new cartridge until the gasket is flush.
- Tighten the fuel filter cartridge with a final half-turn.

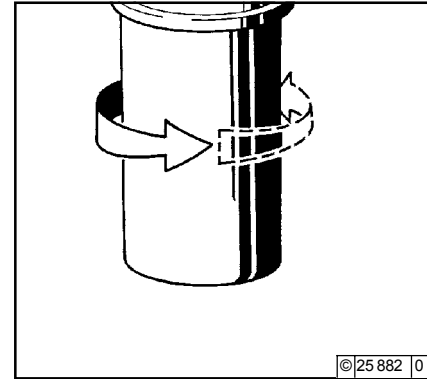

- Open fuel shutoff valve.
- Check for leaks.



The fuel system does not need to be bled.

Keep naked flames away when working on the fuel system. Do not smoke!

6.2.2 Clean / Replace Fuel Oil Filter (Cup)

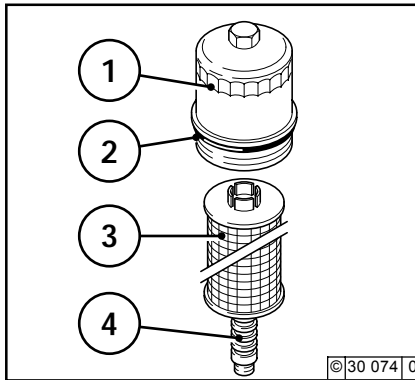

- Switch off the engine.
- Loosen fuel oil filter cover 1 and unscrew in an anticlockwise direction, empties itself the system automatically (drain valve).
- Carefully loosen paper filter cartridge 3 upwards from the guide 4.
- Catch any escaping oil.
- Replace paper filter cartridge 3.
- Clean any dirt from the sealing surface of the filter carrier and fuel oil filter cover 1 and fromb the guide 4.
- Replace and lightly oil the rubber gasket 2.
- Carefully insert new paper filter cartridge 3 into guide 4.
- Tighten fuel oil filter cover 1 in a clockwise direction (25 Nm).
- Start engine.
- Check fuel oil filter attachment for leaks.



Keep naked flames away when working on the fuel system. Do not smoke!

6.2.3 Clean / purge or change fuel pre-filter

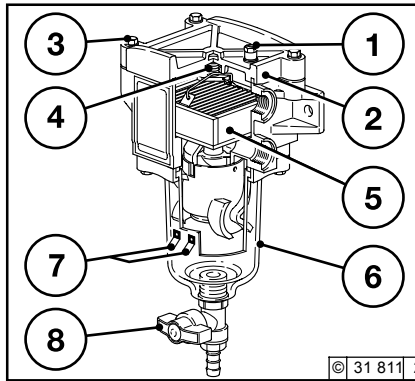

Clean (purge) - remove water:

- Turn off engine or, in the case of a change-over filter, switch over to the other filter.
- Close the fuel stopcock or supply. (if available)
- Open the bleed screw 1 on the cover 2
- Place the fuel collector underneath the fuel pre-filter.
- Empty water and dirt from the bowl 6 by opening (press in and turn slightly without using force) the drain cock 8 and close the drain cock 8 again
- Close the bleed screw 1 on the cover 2 again
- Bleed the fuel pipe according to instructions, see 6.2.5 opposite

Changing the filter element 5:

Change at least once a year or as required (drop

in performance also after purging)

- Turn off the engine or switch to other filter in case of changeover filter
- Close the fuel stopcock or supply (if available)
- Loosen the cover screws 3 diagonally
- Remove the cover 2
- Remove the spring cassette 4
- Remove the filter element 5 from the bracket
- Insert new filter element 5
- Place spring cassette 4 on the element
- Check that the cover seal is fit properly in the cover 2 and check for damage (change if necessary)
- Tighten the cover 2 with the screws 3 diagonally (torque 6 Nm)
- Check the cover 2 for proper fit and leaks
- Bleed the fuel system, see 6.2.4.



The connection of a warning system (lamp/horn) via contacts 7 is specified. Immediate maintenance is necessary when the warning system is triggered.



Naked flames are prohibited when working on the fuel system! Do not smoke!
Dispose of old fuel in an environmentally friendly way!

6.2.4 Bleed Fuel System with Fuel Pre-filter

- Place fuel collection container beneath the fuel pre-filter.

Bleed:

- In the event of re-commissioning, following maintenance work or if the tank has been run empty, the fuel system must be bled.
- Bring engine regulator into stop position.
- Position fuel collection container beneath filter housing 8 / pressure maintenance valve 9.
- Open fuel shut-off valve, pressure maintenance valve 9, bleeder screw 1.
- Turn engine over with starter (max. 20 sec.) until bubble-free fuel escapes from bleeder screw 1 and pressure maintenance valve 9.
- Firmly tighten bleeder screw 1 and pressure maintenance valve 9, see 6.2.5..
- Bring engine regulator into start position and start.
- Check for leaks after starting the engine.



Keep naked flames away when working on the fuel system. Do not smoke!
Dispose of used fuel in an environmentally-friendly manner!

6.2.5 Bleed Fuel System without Fuel Pre-filter

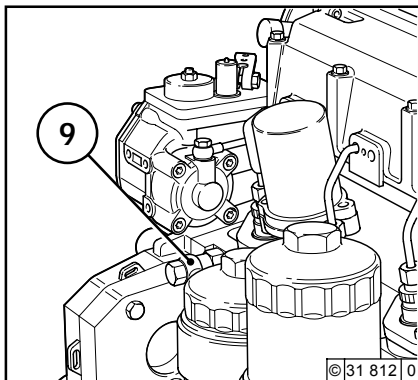

- Bring engine regulator into stop position.
- Open fuel shut-off valve.
- Loosen pressure maintenance valve 9. Collect any escaping fuel and dispose of this in an environmentally-friendly manner.
- Turn engine over with starter (max. 20 sec.) until bubble-free fuel escapes from pressure maintenance valve 9.
- Tighten pressure maintenance valve 9.
- Bring engine regulator into start position and start.
- Check for leaks after starting the engine.



Keep naked flames away when working on the fuel system. Do not smoke!
Dispose of used fuel in an environmentally-friendly manner!

6.2.6 Clean/Replace Fuel Pre-Filter, Filter Element

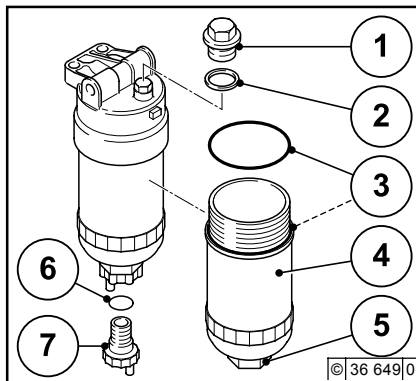

Clean/Replace:

- Close the fuel shut-off valve.
- Place fuel collection container beneath the fuel pre-filter.
- Loosen the drain screw 7+9 and drain fuel.
- Turn the filter element housing 4 with gasket 3 and filter element 3 anti-clockwise and remove.
- Clean any dirt from the sealing face of the filter carrier and filter element housing 4 and sludge chamber 5 and filter element (replace if necessary).
- Insert new round sealing rings 2+3+6.
- Screw in filter element housing 4 and filter element (max. torque 25⁻⁵ Nm).
- Tighten the drain screw 7+9

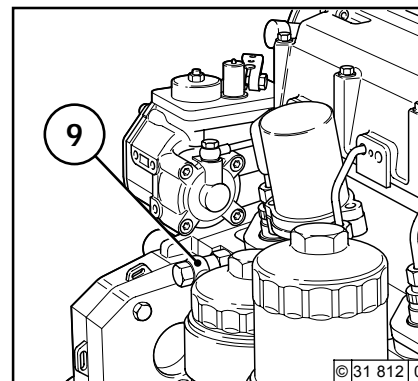

- Open fuel shut-off valve.
- Bleed system
- Check for leaks after starting the engine.

6.2.7 Clean/Replace/Vent Fuel Pre-Filter, Filter Element

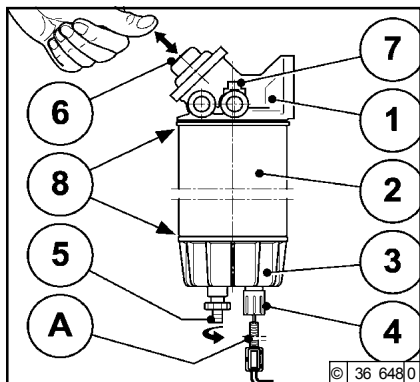

Clean:

- Close the fuel shut-off valve.
- Place fuel collection container beneath the fuel pre-filter.
- Loosen the drain screw 5 and drain fuel/water.
- Turn filter cartridge 2 and dirt trap 3 anticlockwise and remove.
- Turn dirt trap 3 anticlockwise and remove. Empty emulsion into the fuel collection container and clean the dirt trap 3.
- Screw the filter cartridge 2 and dirt trap 3 together. Wet the filter cartridge with fuel, wet the sealing surfaces 8 slightly with oil.
- Mount clockwise.

- Open the fuel shut-off valve and bleed the system.
- Check for leaks after starting the engine.

Replace:

- Replace defective filter cartridge 2.
- Clean any dirt from the filter carrier 1 sealing surface 8.
- Wet the filter cartridge 2 with fuel, wet the sealing surfaces 8 slightly with oil.
- Mount the filter cartridge 2 and dirt trap 3 clockwise.
- Open fuel shut-off valve.
- Check for leaks and vent the system after starting the engine.



Work may only be performed on the fuel system with the engine switched off.

No naked flames! Do not smoke! Dispose of waste fuel in an environmentally-friendly manner.

6.3.1 Cleaning Intervals

- The amount of contamination in the cooling system depends on the engine application.
- Oil and fuel residues on the engine increase the risk of contamination. Therefore pay special attention to leaks if the engine is used in dusty environments.
- Serious contamination occurs, for example:
 - on construction sites where there is a high level of air-borne dust.
 - in harvesting applications where there are high concentrations of chaff and chopped straw in the vicinity of the machine.
- Because applications vary, cleaning intervals have to be determined from case to case. The cleaning intervals given in the table below can be used as a guide.

Checking or cleaning intervals	
Guideline values OH	Engine application
2000	Ships, electrical modules in enclosed areas, pumps.
1000	Vehicles on paved roads
500	Tractors, fork-lift trucks, drivable electric units.
250	Vehicles on construction sites and unpaved roads, construction machines, compressors, underground mining units.
125	Agricultural machines, tractors in harvesting applications.

6.3.2 Clean Cooling System

- External cooling system: Clean according to cooling system manufacturer's specifications.

6.3.3 Drain Cooling System

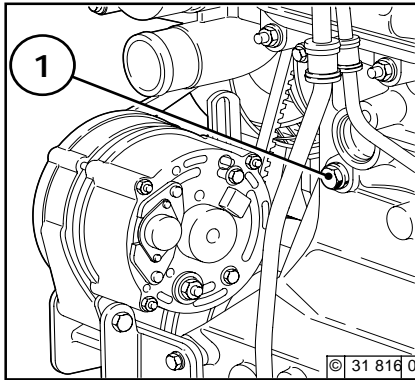

- Position a collecting pan beneath screw plug 1.
- Remove screw plug 1 at crankcase.
- Drain coolant.
- Tighten screw plug 1 again.
- If screw plug 1 is not accessible, drainage can be carried out at the engine radiator (coolant channel).
Fill / bleed cooling system see Chapter 6.3.4



Caution when draining hot coolant:
Risk of scalding! Collect coolant on draining.
Dispose of this in accordance with environmental regulations!

Engine never without coolant operate (also not briefly)

6.3.4 Fill / Bleed Cooling System 2012 Standard Engine

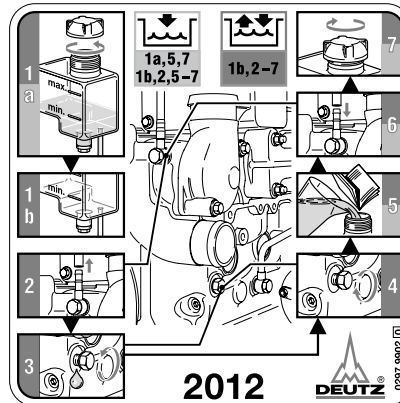

- Open radiator cap item 1.
- Loosen vent hose item 2.
- Fill coolant item 1b in up to the "MAX" mark or filling limit (if fitted, system heater valve must be open).
- Connect vent hose, item 6, + tighten screw plug item 4.
- Close radiator cap item 7.
- Start engine and warm up until thermostat opens.
- Switch off the engine.
- Check coolant level when engine is cold, and top up if necessary.
- Close radiator cap item 1.

Bleed

- External cooling system: According to cooling system manufacturer's specifications.



Engine never without coolant operate (also not briefly)

6.4.1 Cleaning Intervals

- The amount of dirt in the combustion air filter depends on the amount of dust in the air and the size of the air filter used. If a high level of dust is anticipated, a cyclone-type pre-cleaner can be fitted in front of the combustion air filter.
- Cleaning intervals must therefore be determined from case to case.
- If dry type air filters are used, cleaning should only be carried out according to the service indicator or service switch.
- Filter servicing is needed when:
 - Service indicator
the red signal 1 is fully visible when the engine is off.
 - Service switch
the yellow pilot light comes on when the engine is running.
- After carrying out service work, press the reset button on the service indicator. The service indicator is now ready for operation again.

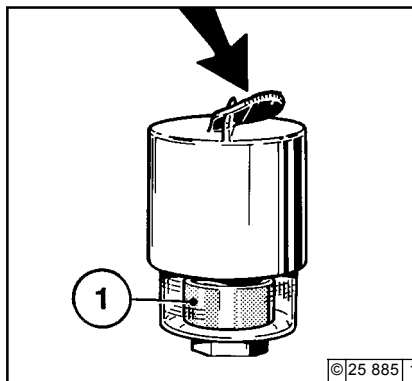

6.4.2 Emptying Cyclone Type Precleaner

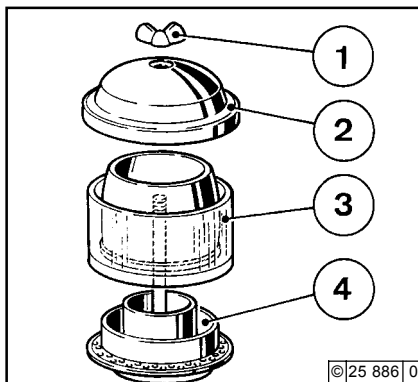

- Undo wing nut 1 and remove cover 2.
- Remove collector bowl 3 from lower section 4 and empty. Clean leaves, straw and other foreign matter from lower section of pre-cleaner.
- Reposition collector bowl 3 onto lower section 4, fasten cover 2 in place by tightening wing nut 1.

Never fill collector bowl with oil. Replace collector bowl if damaged.

6.4.3 Clean Oil Bath Air Filter

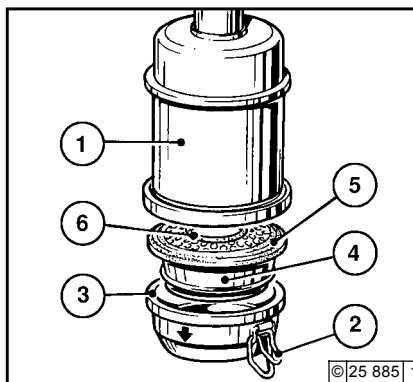

- Turn engine off and wait about 10 minutes for the oil to drain from filter housing 1.
- Loosen snap clips 2 and remove oil cup 3 with filter element 4; if necessary, loosen filter element with the aid of a screwdriver at the separating point. Do not damage rubber gasket 5!
- Remove dirty oil and sludge. Clean oil cup.
- Clean filter element 4 in diesel fuel and allow to drip-dry thoroughly.

- Clean filter housing 1 if very dirty.
- Inspect and replace rubber gasket 5 and 6 if necessary.
- Fill oil cup with engine oil up to the mark (arrow) (for viscosity, see 4.1.2).
- Refit oil cup and element to filter housing and secure with snap clips.



Never clean filter with gasoline. Dispose of old oil in accordance with environmental regulations!

6.4.4 Dry Type Air Filter Dust Discharge Valve

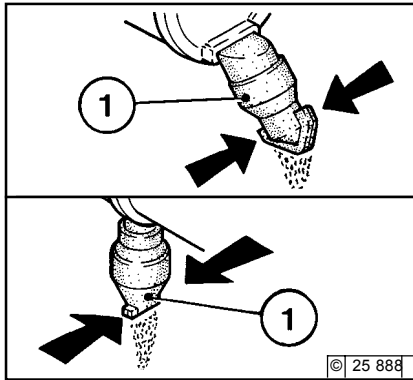

- Empty dust discharge valve 1 by pressing apart lips of discharge slot as indicated by arrows.
- Clean discharge slot from time to time.
- Remove any caked dirt by pressing together the upper section of the valve.

Filter Cartridge

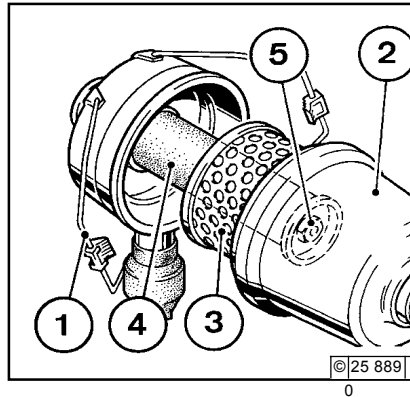

- Undo clip fasteners 1.
- Take off hood 2 and remove cartridge 3.
- Clean cartridge (replace at least once a year)
- Clean cartridge 3.
 - Using dry compressed air (max. 5 bar), blow out from inside outwards,
- or
 - Tap out (in emergencies only). Do not damage the cartridge, or
 - Wash out according to manufacturer's specifications.
- Check paper filter (light showing through) and gaskets for damage. Replace if necessary.
- After five filter services or after two years at the latest, replace safety cartridge 4 (never clean!).
 - To do so:
 - Undo hex nut 5 and remove cartridge 4.
 - Insert new cartridge, re-install hex nut and tighten.
- Install cartridge 3, replace hood 2 and do up clip fasteners 1.



Never clean filter cartridge with gasoline or hot fluids!

6.5.1 Check V-belts 2012 Standard

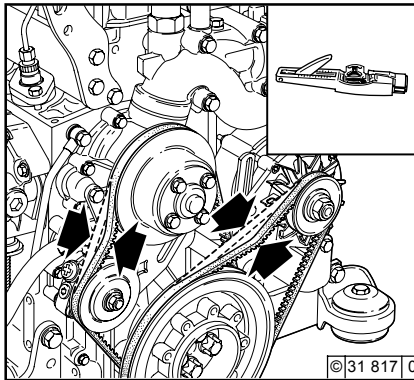

- Visually inspect entire V-belt for damage.
- Replace damaged V-belts.
- After installing new belts, run engine for 15 minutes, then check belt tension.
- To check the tension of the V-belt, use a tension gauge (see 9.3).
 - Place indicator arm 1 into gauge.
 - Position guide 3 on V-belt 2, midway between the pulleys, with flange 3 on bottom of gauge against the edge of belt.
 - Push slowly on the black pad 4 at right angles to V-belt 2 until the spring is heard or felt to trigger.

2012 with Ribbed V-belt

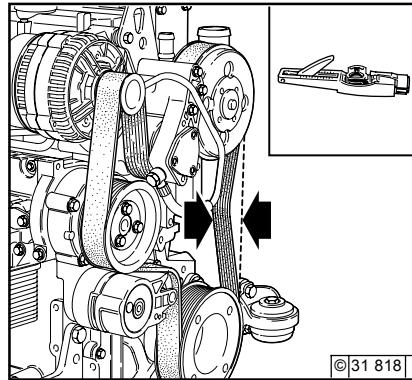

- Carefully raise the gauge without changing the position of indicator arm 1.
- Read off the value where the indicator arm 1 intersects scale 5 (arrow) and read indicator arm 1 off. For settings, see 9.1.
- If necessary, retension belt and measure again.

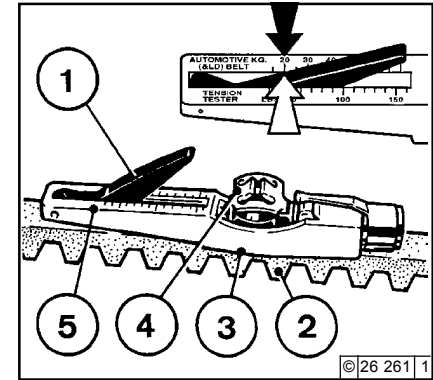

Check, tension and change V-belts only with the engine off. If necessary, reinstall V-belt

6.5.2 Tension V-belts Coolant / Fuel Pump

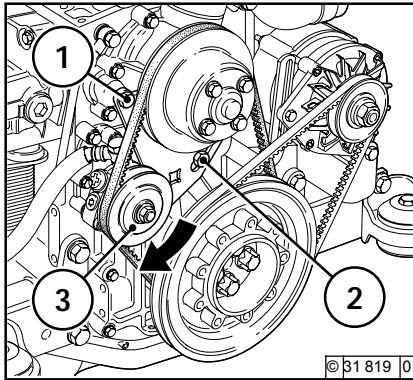

- Loosen screws 1 and 2.
- Press fuel pump 3 in direction of arrow until the correct V-belt tension has been achieved.
- Tighten screws 1 and 2 again.

6.5.3 Replace V-belts Coolant / Fuel Pump

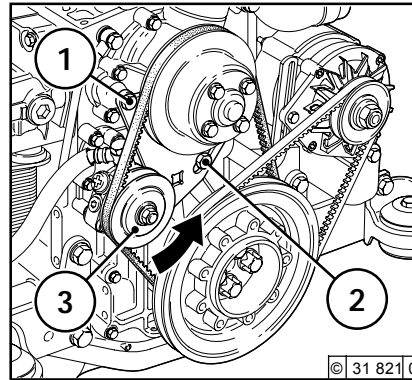

- Loosen screws 1 and 2.
- Press fuel pump 3 in direction of arrow.
- Remove V-belt and position new belt.
- Press fuel pump counter to direction of arrow until the correct V-belt tension has been achieved.
- Tighten screws 1 and 2 again.

6.5.4 Replace V-belts

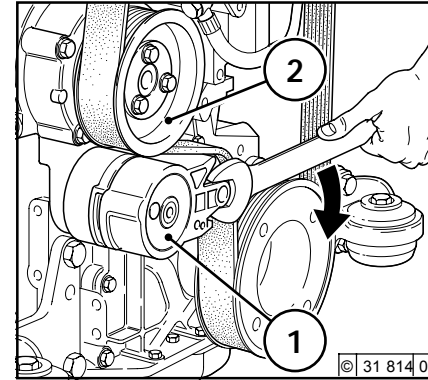

- Press tension roller in direction of arrow until the ribbed V-belt is free.
- First remove ribbed V-belt from the smallest roller.
- Position new ribbed V-belt.
- Press tension roller counter to direction of arrow until the ribbed V-belt is tensioned.



Check, tension and change V-belts only with the engine off. If necessary, reinstall V-belt guard.



Check whether ribbed V-belt is positioned correctly in its guide.

6.5.5 Tension V-belts Alternator

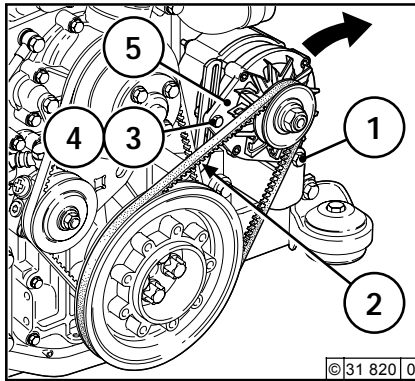

- Loosen screws 1, 2 and 4.
- Adjust alternator 5 in direction of arrow by turning screw 3 until correct V-belt tension is achieved.
- Retighten screws 1, 2 and 4.

6.5.6 Replace V-belts Alternator

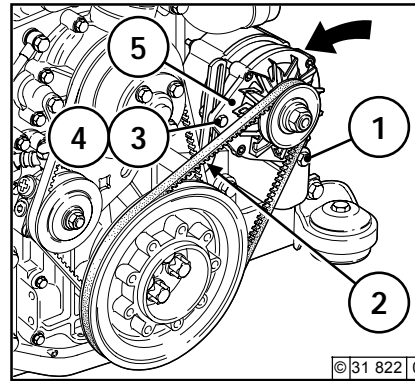

- Loosen fuel pump V-belt, see 6.5.3
- Loosen screws 1, 2 and 4.
- Adjust screw 3 until V-belt can be removed.
- Position new belt.
- Adjust screw 3 until the correct V-belt tension has been achieved.
- Retighten screws 1, 2 and 4.
- Tension fuel pump V-belt, see 6.5.4.



Check, tension and change V-belts only with the engine off. If necessary, reinstall V-belt guard.

6.5.7 Wedge rib V-belts wear limit examine.

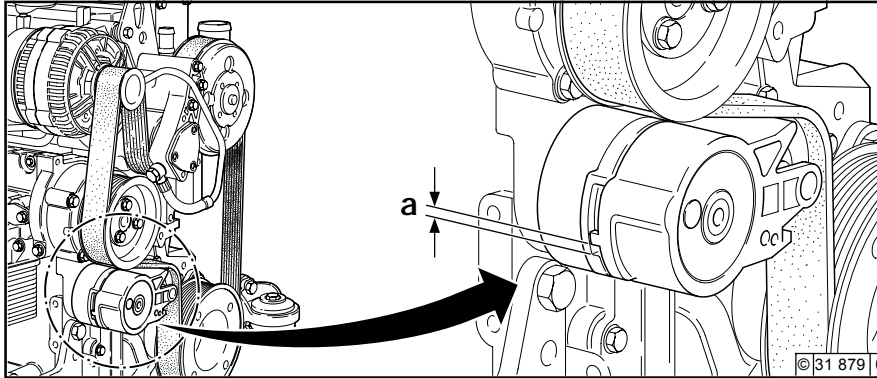

- Wear limit of the wedge ribV- belt as follows examine:
- Distance between the nose of the flexibility clamping arm and the notice of the firm tension adjuster housing examine.
- If „a“ is smaller than 3 mm, then the wedge rib V- belt is to be exchanged

6.6.1 Check Valve Clearance, Adjust if Necessary

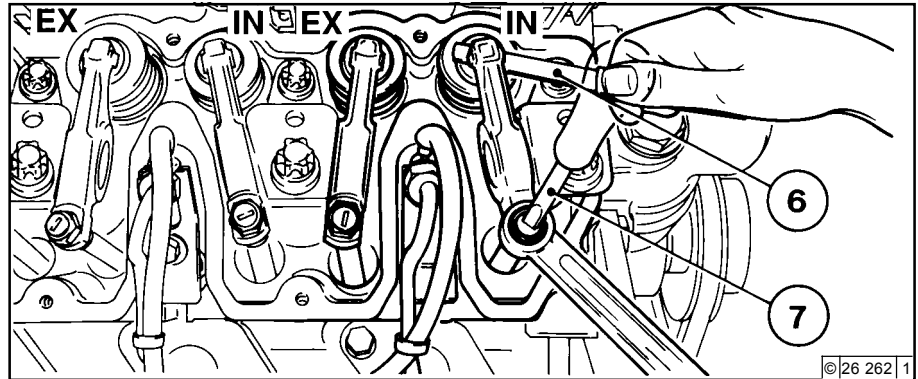
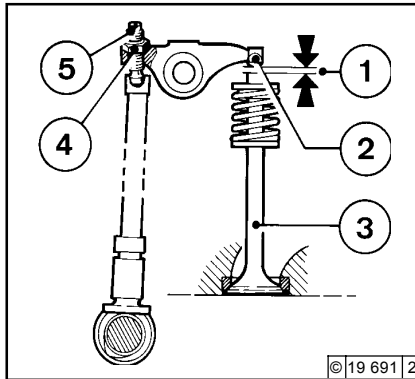

- Loosen ventilation valve and swing to the side.
- Remove the cylinder head cover.
- Position crankshaft as per schematic, see 6.6.1.1.
- Before adjusting valve clearance, allow engine to cool down for at least 30 minutes. The oil temperature should be below 80 °C.
- Check valve clearance 1 between rocker arm / tappet contact face 2 and valve 3 with feeler gauge 6 (there should be only slight resistance when feeler blade is inserted). For permissible valve clearance, see 9.1.
- Adjust valve clearance if necessary:
 - Release locknut 4.
 - Use screwdriver 7 to turn setscrew 5 so that the correct valve clearance 1 is attained after locknut 4 has been tightened.
- Check and adjust valve clearance on all cylinders.
- Reinstall cylinder head cover (with new gasket if necessary).
- Swing ventilation valve into position and fasten.

6.6.1.1 Valve Clearance Adjustment Schematic

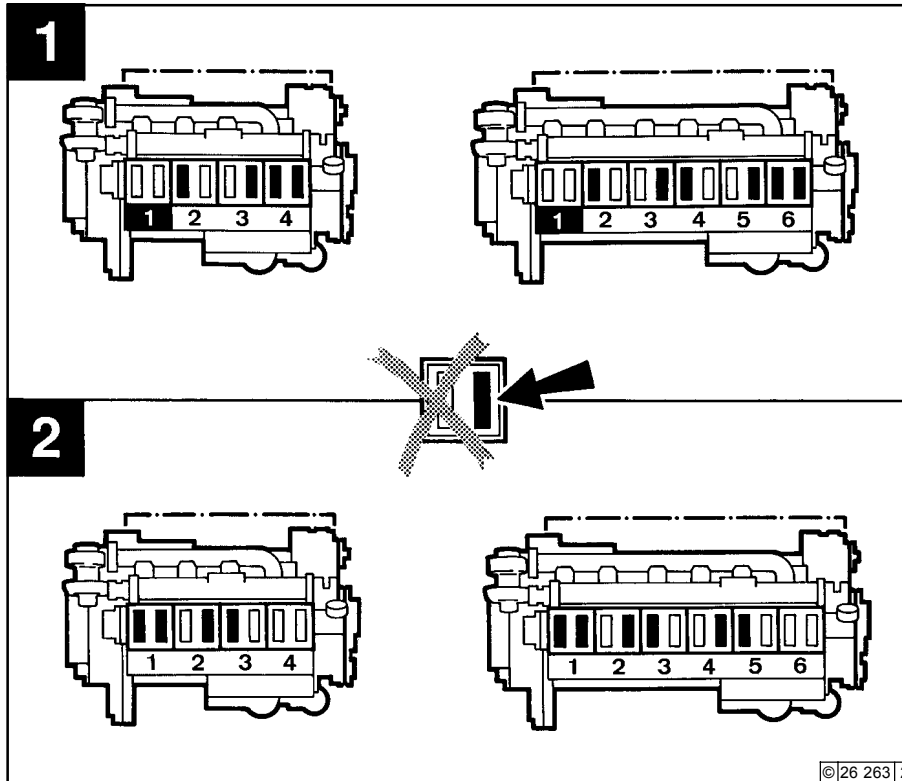

- **Crankshaft Position 1:**

Turn crankshaft until both valves in cylinder 1 overlap (exhaust valve about to close, inlet valve about to open). Adjust valve clearance according to schematic (**marked in black**). Mark respective rocker arm with chalk to show that adjustment has been carried out.

- **Crankshaft Position 2:**

Turn crankshaft one full revolution (360°). Adjust valve clearance according to schematic (**marked in black**).

6.7.1 Battery

6.7.1.1 Check Battery and Cable Connections

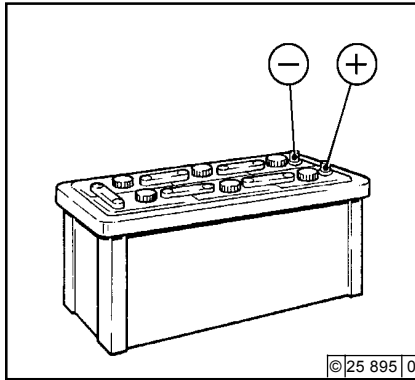

- Keep battery clean and dry.
- Undo dirty clamps.
- Clean terminal posts (+ and -) and clamps of the battery, and grease with acid-free and acid-resistant grease.
- When reassembling, ensure that clamps make good contact. Tighten clamp bolts hand-tight.

6.7.1.2 Check Electrolyte Level

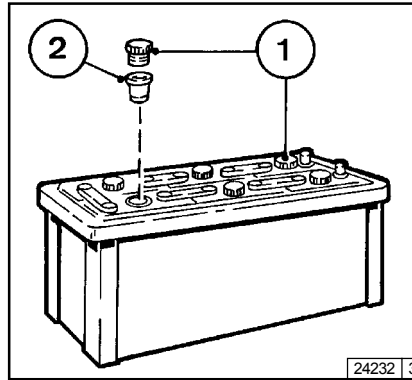

- Remove sealing caps 1.
- If testers 2 are present: Electrolyte level should reach the base of these.
- Without testers: The electrolyte level should be 10-15 mm above the top of the plates.
- If necessary, top up with distilled water.
- Screw sealing caps back in.

6.7.1.3 Check Electrolyte Density

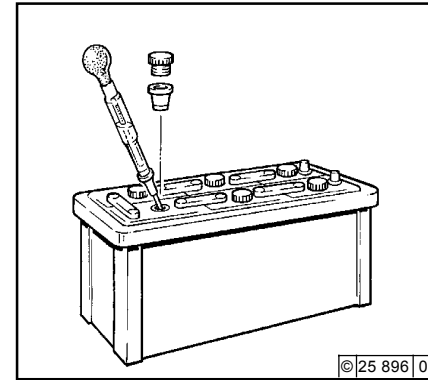

- Measure the electrolyte density of individual cells with a commercial hydrometer. The hydrometer reading (see table on following page) indicates the battery's state of charge. During measurement, the temperature of the electrolyte should preferably be 20 °C.

Electrolyte density				
in [kg/ l]		in [°Bé (Baumé scale)*]		Charge status
Normal	Tropical	Normal	Tropical	
1.28	1.23	32	27	well charged
1.20	1.12	24	16	semi-charged, re-charge
1.12	1.08	16	11	discharged, immediately charge

* Measurement of electrolyte density in ° Bé (Baumé scale) is out of date and rarely used today.



The gases emitted by the battery are explosive! Keep sparks and naked flames away from the battery!

Do not allow battery acid to come into contact with skin or clothing!
Wear protective goggles!
Do not rest tools on the battery!

6.7.2 Rotary Current Alternator

Notes on the three-phase system:

- Never disconnect the cables between battery, alternator and regulator while the engine is running.
- If, however, it is necessary to start and operate the engine without the battery, disconnect the regulator from the alternator before starting.
- Be sure not to confuse the battery terminals.
- Replace defective charge pilot lamp bulb immediately.
- When cleaning the engine: Do not spray the alternator with a direct jet of water/steam!
Allow the engine to run warm so that the remaining water evaporates.
- The habit of touching a lead against the frame to check whether it is live must under no circumstances be used with three-phase electrical systems.
- In case of electric welding, connect the ground terminal on the welder directly to the piece being welded.

6.7.3 Transportation Shackles

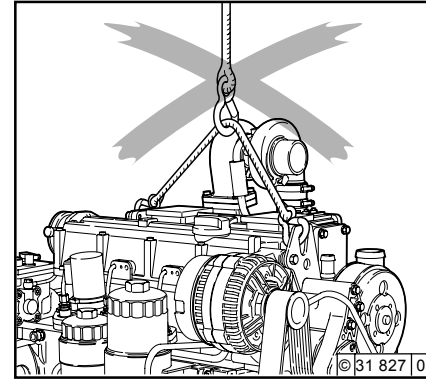
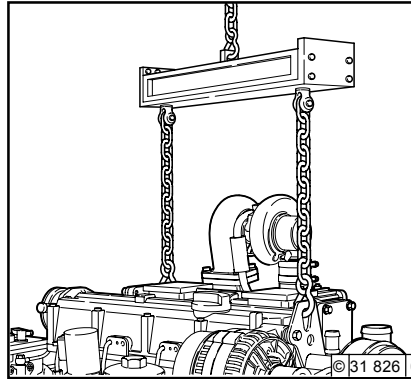

- Only use proper lifting gear when transporting the engine.



Use only the correct lifting gear !

7.1 Fault Table

Faults, Causes and Remedies

7

- Faults can frequently be attributed to the fact that the engine has been incorrectly operated or not serviced.
- Each time a fault occurs, check whether all operating and servicing regulations have been complied with.
- A corresponding fault table can be found on the opposite page.
- If the cause of a fault cannot be determined, or you are unable to remedy a fault yourself, then please contact your DEUTZ Service representative.

Before starting, make sure that nobody is standing in the immediate vicinity of the engine or driven machine.

In the event of repair work:



Caution: If the speed regulator has been removed, the engine must not be started under any circumstances.

Disconnect the battery!

7.1 Fault Table

Faults, Causes and Remedies

Faults										Measures		
Engine does not start or is difficult to start (Starting speed is not achieved on starting)										Check	P	
Engine starts, but runs irregularly or fails										Adjust	E	
Engine becomes excessively hot. Temperature warning system responds										Replace	W	
Engine output is deficient										Clean	R	
Engine does not run on all cylinders										Top up	A	
Engine oil pressure is non-existent or excessively low										Bleed	L	
Engine oil consumption excessive												
Engine smokes - blue												
- white												
- black												
Cause										Section		
●										Not declutched (where possible)	Engine Operation	P
●							●			Below starting limit temperature		P
●			●							Engine shut-off lever still in stop position (shutoff magnet defective)		P
		●			●					Oil level too low		A
		●	●			●	●			Oil level too high		S
					●	●	●			Excessive inclination of engine		P / E
●										Adjust throttle to half actuation travel		P / E
		●	●						●	Air cleaner clogged / turbocharger defective	Combustion air	P / W
		●	●						●	Air cleaner service switch / indicator defective		P
			●						●	CPD* defective (connection line leaks)		P
		●	●						●	Charge air line leaking		P / W
		●								Coolant pump defective	Cooling system	P / R
			●						●	Intercooler soiled		P / R
		●								Coolant heat exchanger soiled		P / R
●	●	●	●	●						Cooling fan defective, torn or loose V-belt (fuel pump in belt drive)		P / W
		●	●							Cooling air temperature rise / heating short circuits		P
●										Battery defective or discharged	Electrics	P

* CPD = Charge pressure-dependent full-load stop

Table 1 of 2

Faults, Causes and Remedies

7.1 Fault Table

7

Faults										Measures		
										Engine does not start or is difficult to start (Starting speed is not achieved on starting)	Check	P
										Engine starts, but runs irregularly or fails	Adjust	E
										Engine becomes excessively hot. Temperature warning system responds	Replace	W
										Engine output is deficient	Clean	R
										Engine does not run on all cylinders	Top up	A
										Engine oil pressure is non-existent or excessively low	Reduce	S
										Engine oil consumption excessive		
										Engine smokes - blue		
										- white		
										- black		
										Cause	Section	
●										Cable connections, starter, electrical circuit loose or oxidised	Electrics	P
●										Starter defective or pinion does not engage		P
●	●		●					●	●	Incorrect valve clearance	Engine	E
●	●		●	●						Injection line leaks		P
		●								Ventilation line blocked (coolant heat exchanger)		P / R
●								●		Sheathed glow plugs defective		P
●	●	●	●	●				●	●	Injection valve defective		P / W
●	●		●	●						Air in the fuel system		P / W
●	●		●	●						Fuel filter / fuel pre-cleaner soiled		P / R / W
		●								Oil filter defective		W
●					●	●				Incorrect engine lube oil SAE class or quality	Operating media	W
●	●		●					●		Fuel quality not as per operation manual		P / W
		●								Coolant deficiency		P / A

Table 2 of 2

8.1 Preservation

8.1 Preservation

If the engine is to remain idle for an extended period of time, it is necessary to take protective measures to prevent the formation of corrosion. The preservative measures described here will protect the engine for up to approx. 6 months. The procedure will have to be reversed before the engine is recommissioned.

- Anti-corrosion oils to specification:
 - MIL-L 21260B
 - TL 9150-037/2
 - Nato Code C 640 / 642
- Recommended cleaning agent to remove preservatives:
 - Petroleum benzine (hazardous materials class A3)

Preserve engine:

- Clean engine (poss. with cold cleaner).
Radiator cleaning, see 6.3.2.
- Run engine until warm, then turn off.
- Drain engine oil, see 6.1.2, and fill with anti-corrosion oil.
- Drain coolant, see 6.3.3.
- Top up anti-corrosion agent, see specifications.
- Clean oil bath air filter if necessary, see 6.4.3, and top up anti-corrosion oil.
- Drain fuel tank.
- Make up a mixture of 90 % diesel fuel and 10 % anti-corrosion oil, and refill fuel tank.
- Allow the engine to run for approx. 10 mins.
- Switch off the engine.
- Manually turn the engine over several times. When turning over with starter, set shutoff lever to stop position.
- Remove V-belts and store in wrapped condition.
- Spray grooves on V-belt pulleys 2 with anti-corrosion spray.
- Drain anti-corrosion agent, see 6.3.3.
- Lightly preserve coolant filler neck and seal with cap.
- Seal intake ports and exhaust ports.

Remove engine preservation:

- Remove anti-corrosion agent from grooves in V-belt pulleys 2.
- Install V-belts. Retension after brief operation if necessary, see 6.5.
- Remove covers from intake port 3 and exhaust port 4.
- Disconnect coolant inlet and outlet neck covers, remove protection and connect to cooling system.
- Top up coolant, see 6.3.4. System must be bled.
- Commission engine

9.1 Engine Specifications and Settings

9.2 Torque Wrench Settings

9.3 Tools

Model	BF4M 2012	BF4M 2012 C	BF6M 2012 C
Number of cylinders	4	4	6
Cylinder arrangement	vertical in line		
Bore [mm]	ø 101		
Stroke [mm]	126		
Total displacement [cm ³]	4.04	4.04	6.06
Compression ratio [C]	19		
Working cycle	Four-stroke diesel		
Combustion system	with turbocharging and direct fuel injection		
Charge air cooling	without	with	with
Direction of rotation	counter-clockwise		
Weight 2012/ C including cooling system to DIN 70020-A [approx.kg]	Refer to head-office		
Engine output [kW]	75	103	155
Max. speed [1/rpm]	2500		
Valve clearance with cold engine (PTs) [mm]	Inlet 0.3 ^{+ 0.1} / exhaust 0.5 ^{+ 0.1}		
Valve clearance with cold engine standard [mm]	Adjustment with special tool, see 6.6.1		
Injector opening pressure [bar]	250		
Start of feed [°CS BTOC]	1)		
Firing order of the engine	1-3-4-2	1-3-4-2	1-5-3-6-2-4
V-belt tension:	Pre-tension / re-tension 2)		
Alternator / fan [N]	450 / 300 ± 50		
Fuel pump - coolant pump [N]	450 / 300 ± 50		
Compressor [N]	550 / 450 ± 50		
Ribbed V-belt tension spring-loaded tension roller [N]	900 / 600 ± 50		

1) Engine output, speed, start of delivery are stamped on engine rating plate, etc., see also 2.1.

2) Re-tension 15 minutes after the engine has been operated under load.

Model	BF4M 2012	BF4M 2012 C	BF6M 2012 C
ling	Liquid-cooled / cooling system protection		
Coolant volume 2012/ C	[ca.ltr.] 5,6	5,6	7,3
Perm. constant coolant temperature			
Engine exhaust, output group I	[°C]	max. 110 ⁶⁾	
Engine exhaust, output group II-IV	[°C]	max. 105 ⁶⁾	
Thermostat opening commencement at	[°C]	⁷⁾	
Thermostat fully open from	[°C]	83 ⁸⁾	
Coolant pre-heating		⁴⁾	
Coolant pump			
Feed pressure in	[bar]	⁹⁾	
Feed quantity in	[m ³ /h]	⁹⁾	
Power consumption in	[kW]	⁹⁾	
Lubrication	Pressure lubrication		
Oil temperature in oil pan	[°C]	125	
Min. oil pressure when warm (120 °C and SAE oil 15 W 40) and low idle	[bar]	0,8	
Oil plate filling quantity without filter	[approx.ltr.] 8.5 ³⁾	8.5 ³⁾	13.0 ³⁾
Oil plate filling quantity with filter	[approx.ltr.] 10 ³⁾	10 ³⁾	14.5 ³⁾

³⁾ Approx. values may vary depending on version. The upper oil dipstick mark is always authoritative.

⁴⁾ Only necessary in winter operation, see 3.5.1.

⁵⁾ Engine content without radiator only. Content of external cooling system depending on cooling system version.

⁶⁾ Other output groups have different values, consultation with head office is required.

⁷⁾ In the case of external cooling systems with outlet regulation, the thermostat begins to open at 87 °C

⁸⁾ In the case of external cooling systems with outlet regulation, the thermostat is fully open at 102 °C

⁹⁾ Consultation with head office is required (differ depending on engine version)

Installation location	Pre-tension [Nm]			Re-tension [Nm]				Total [Nm]	Comments
	1. Stage	2. Stage	3. Stage	1. Stage	2. Stage	3. Stage	4. Stage		
Cylinder head cover								8.5	
Rocker arm adjustment screw								21	
Foot on flywheel side								187	M16x40 8.8 A 4 C
Foot on fan side		30			45			187	M16x40 8.8 A 4 C
Intake manifold								8.5	
Exhaust manifold								21	
Oil drain screw								50	
Injection valve attachment								16	Torx
Injection line attachment								30	M14x1.5
Oil pan (cast)									29
Oil pan (sheet metal)								21	

TORX

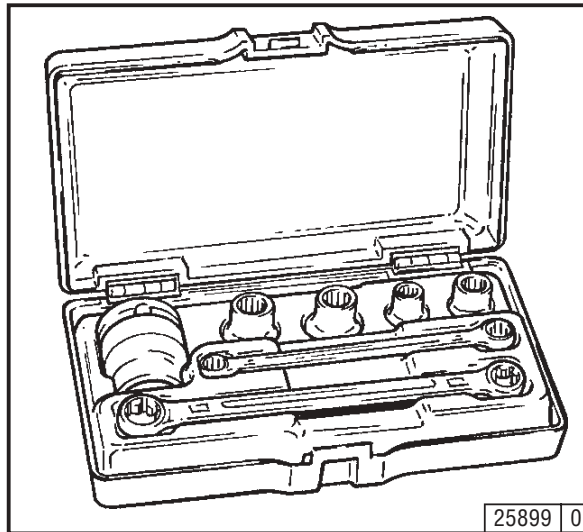

A TORX wrench set is used with engines in the 2012 series.

This system was chosen because of the many advantages it offers:

- Outstanding accessibility to bolts.
- High load transfer when loosening and tightening.
- Almost impossible for socket to slide off or break, thereby practically ruling out the risk of injury.

TORX tools can be ordered from:

WILBÄR
Postfach 14 05 80
D-42826 Remscheid

V-belt tension gauge

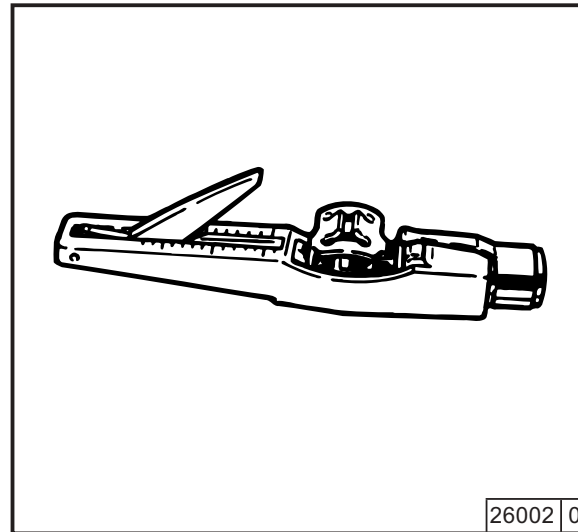

The V-belt tension gauge can be obtained under order number **8115 + 8120** from:

WILBÄR
Postfach 14 05 80
D-42826 Remscheid

Notes

Warnings to Place on Equipment

CALIFORNIA

Proposition 65 Warning

Diesel engine exhaust and some of its constituents are known to the State of California to cause cancer, birth defects, and other reproductive harm.

Warning in the Manual

CALIFORNIA

Proposition 65 Warning

Diesel engine exhaust and some of its constituents are known to the State of California to cause cancer, birth defects, and other reproductive harm.

or

CALIFORNIA

Proposition 65 Warning

Diesel engine exhaust and some of its constituents are known to the State of California to cause cancer, birth defects, and other reproductive harm.

CALIFORNIA PROPOSITION 65 INFORMATION

TO CALIFORNIA CUSTOMERS AND TO CUSTOMERS SELLING DIESEL ENGINE EQUIPMENT INTO OR FOR USE IN CALIFORNIA.

Proposition 65, a California law, requires warnings on products which expose individuals in California to chemicals listed under that law, including certain chemicals in diesel engine exhaust.

Obligations of Manufactures of Diesel-Powered Off-Road Equipment. The California Superior Court has approved either of the following two methods of compliance with Proposition 65 requirements by manufactures of off-road equipment containing diesel engines. (The court order containing these provisions is attached.)

- 1. On-Equipment Warning.** Place the warning pictured in attachment 1 on all equipment shipped by you into or for sale in California after January 1, 1996. The warning must be in a location where it is easily visible to the operator of the equipment when (s)he is operating the equipment. The warning must be secured to the equipment. If warnings or operating instructions are provided through a digital display, you may use that method of providing warning.
- 2. Operator Manual Warning.** When the operator manual is next revised or by December 31, 1995 whichever is earlier, place the warning in attachment 2 in the operator manual. The warning may be either printed in the manual or on a sticker.

The warning must appear in one of the following locations:

- Inside The front cover
- Inside the back cover
- Outside the front cover
- Outside the back cover
- As the first page of text

Under either alternative, the warning must appear in the same size, print and format as the attachment selected or be of an equally conspicuous size and format. If the warning is provided in an on-screen display, the warning must contain the language in the attachment and must be provided at the time of or in connection with ignition in the same manner as other safety warnings electronically communicated on screen.

Obligation of Resellers of Diesel Engines. This letter must accompany any loose diesel engine sold in California. Should you have any questions, please call Deutz Corporation Product Support Department.

DEUTZ Oil



DEUTZ Oil DQC II-05

ACEA E5-02 / E3-96 / B3-04
API CG-4

TLS-15W40D (DQC II-05)	
5 L	0101 6331
20 L	0101 6332
209 L	0101 6333



DEUTZ Oil DQC III-05

ACEA E7-04 / E5-02 / E3-96 / B4-04 / A3-04
API CI-4 / SL GLOBAL DHD-1

TLX-10W40FE (DQC III-05)	
5 L	0101 6335
20 L	0101 6336
209 L	0101 6337



DEUTZ Oil DQC IV-05 (Synthetic)

ACEA E7-04 / E5-02 / E4-99

DEUTZ Oel DQC IV-5W30 (DQC IV-05)	
5 L	-
20 L	0101 7849
209 L	0101 7850



We move your world

DEUTZ AG

Service-Technik

Instandhaltungstechnik Motoren

Deutz-Mülheimer Str. 147-149

D-51063 Köln

Tel.: ++49 (0) 2 21-8 22-0

Fax: ++49 (0) 2 21-8 22-53 58

Internet: www.deutz.de

E-mail: info@deutz.de

Printed in Germany

All rights reserved

3. Edition, © 03/03

Order No.: 0297 9912 en